

Part Number:

1990503/1990505

1990504/1990506

Models:

Interceptor Bear 650 (all years)

Interceptor (648cc, all years)

Continental GT (648cc, all years)



WARNING: Royal Enfield genuine accessories are designed to fit only the specific Royal Enfield motorcycle(s) that are specified above. They should not be fitted to any other type of motorcycle. Pay particular attention to the warnings and cautions contained in this instruction, failure to do so may result in an incorrect installation of the accessory which could result in an unsafe riding condition and possible accident. If in any doubt always seek help from your authorised Royal Enfield dealer.



WARNING: Before starting any accessory kit installation ensure the motorcycle is supported in a stable condition. Failure to support the motorcycle correctly could lead to motorcycle damage or personal injury.



WARNING: All fixings must be tightened to the torque values specified in this instruction. Failure to tighten fixings to the correct torque could result in an unsafe riding condition and possible accident



CAUTION: Care should be taken when fitting any accessory kit. Incorrect handling of kit components or the use of incorrect tools could lead to component or motorcycle damage.

NOTE: The content of this instruction is subject to change at any time without notice or liability. Royal Enfield reserves the right to revise the information presented at any time.

Parts Supplied: 1990503/1990505
Compact Engine Guard

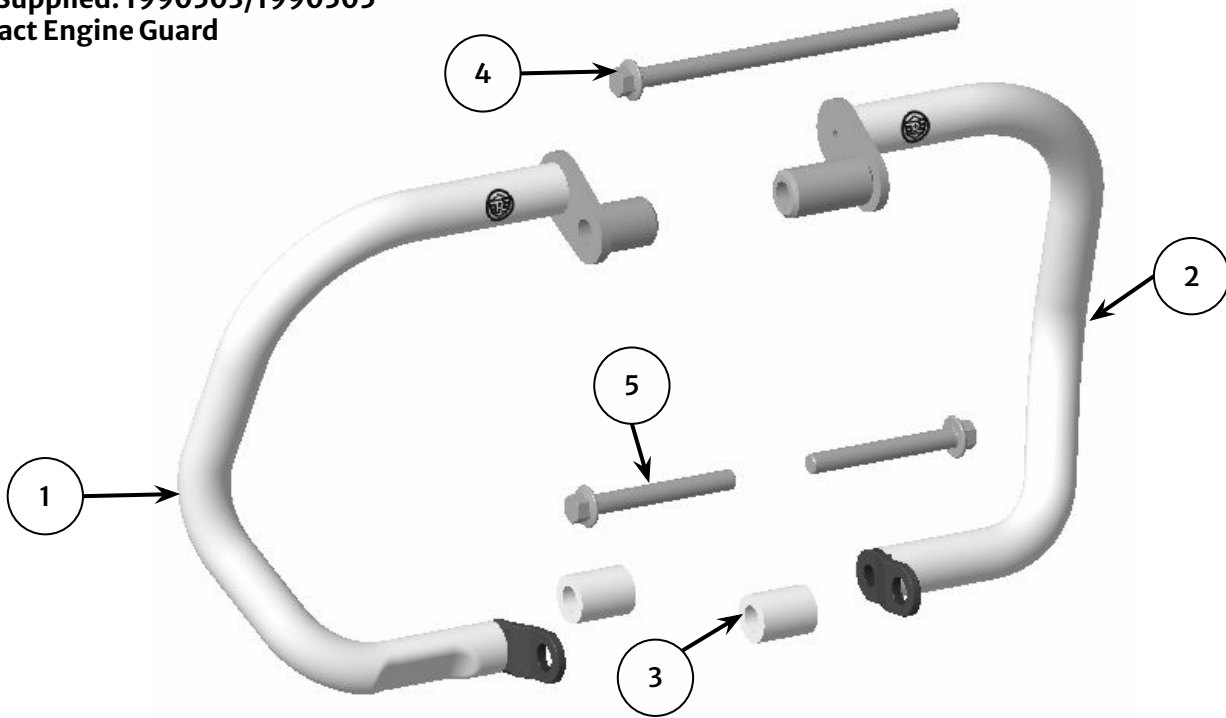

Item	Description	Qty
1	Compact engine guard, right side	1
2	Compact engine guard, left side	1
3	Spacer, lower mount	2
4	Fixing, M10 x 180mm	1
5	Fixing, M10 x 80mm	2

Parts Supplied: 1990504/1990506
Large Engine Guard

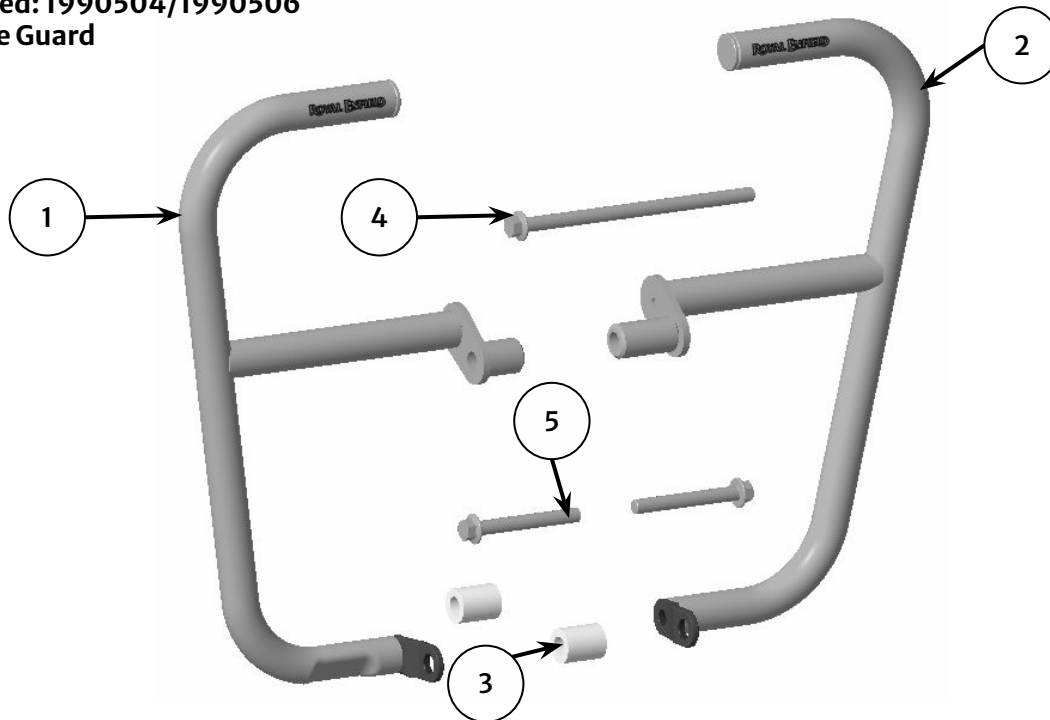

Item	Description	Qty
1	Large engine guard, right side (with lower dimple)	1
2	Large engine guard, left side	1
3	Spacer, lower mount	2
4	Fixing, M10 x 180mm	1
5	Fixing, M10 x 80mm	2

For Interceptor Bear models

1 Loosen the clamp (1) and the four header pipe fixings (2 and 3). Remove the right side header pipe fixings (3), supporting the header pipe (4)



12mm socket with ratchet
8mm socket with ratchet

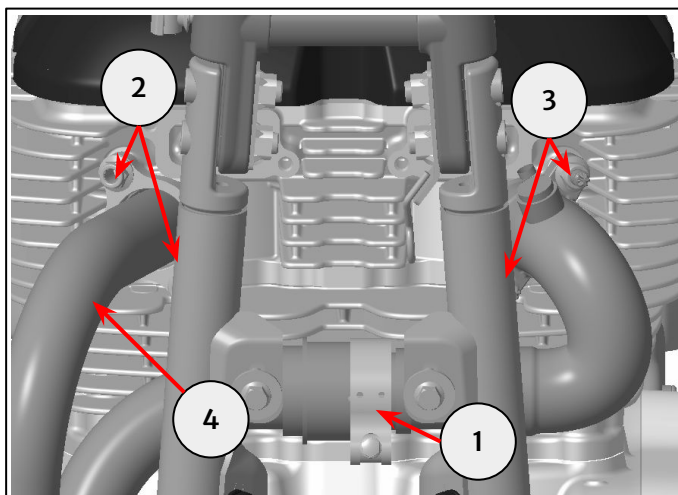

2 Loosen the rear clamp (1). Supporting the header pipe (2), slide the header pipe out of the front clamp (3), followed by the rear clamp (1) and hang the header pipe to one side, ensuring it is fully supported. Do not allow the header pipe to hang from the lambda sensor wire. Retain all for reuse.



10mm socket with ratchet

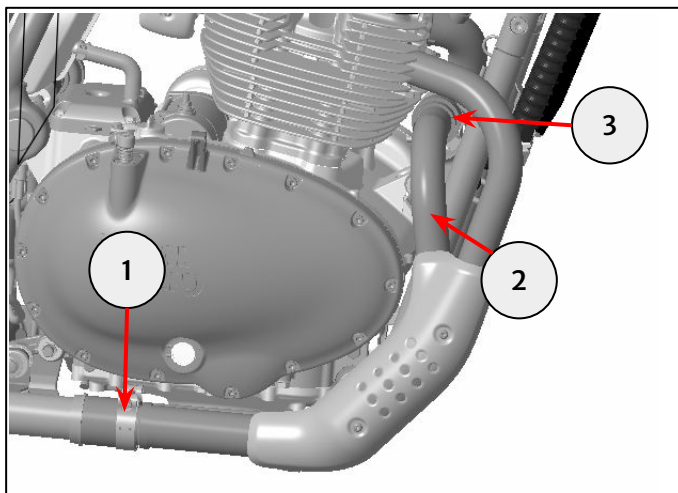

For all models

3 Remove the top engine mount fixing, washer and nut (1). Retain washer and nut for reuse. Remove the right side engine mount fixing, washer and nut (2). Retain washer and nut for reuse. Retain fixings for reuse if the motorcycle is to be returned to its original condition.



14mm socket with ratchet
14mm spanner

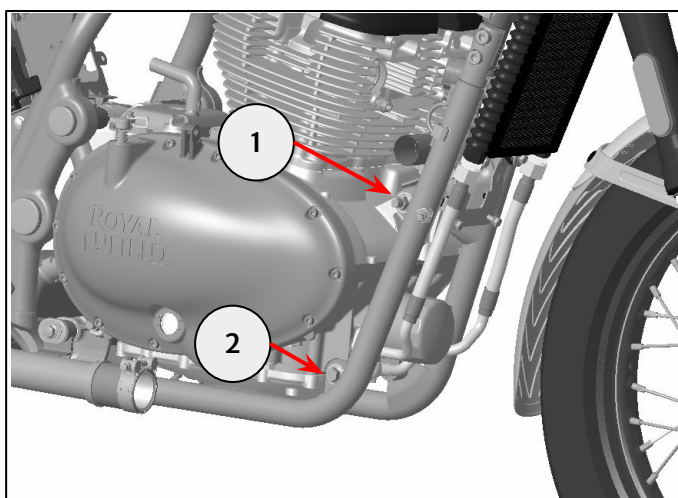

4 Fit the right side engine guard (1) bottom mount with a spacer (2) from the kit. Insert one M10 x 80mm fixing (3) from the kit from the right side of the motorcycle. Refit the original washer and nut (4). Do not fully tighten at this stage.

Note For identifying the engine guard left and right sides, the Royal Enfield logos face forward.



14mm socket with ratchet
14mm spanner

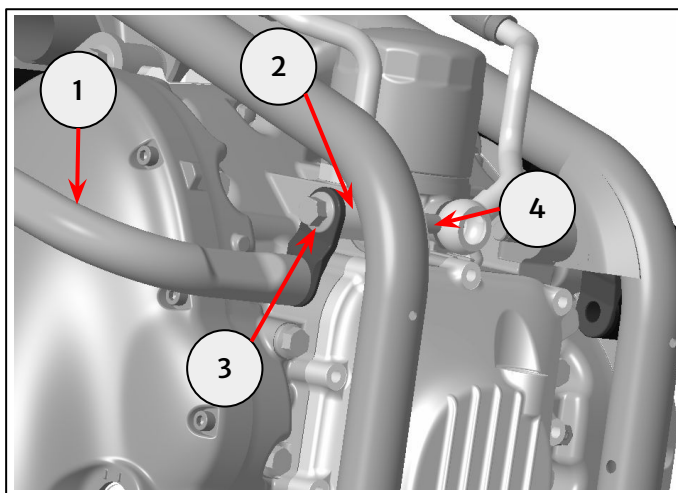

5 Fit the right side engine guard top mount (1). Insert the M10 x 180mm fixing (2) from the kit from the right side of the motorcycle.

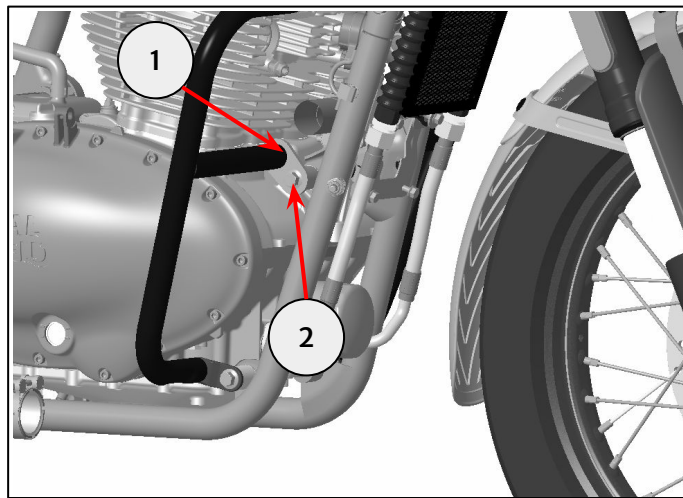

6 Remove the left side engine mount fixing (1), washer and nut (2). Retain washer and nut for reuse. Retain fixings for reuse if the motorcycle is to be returned to its original condition.

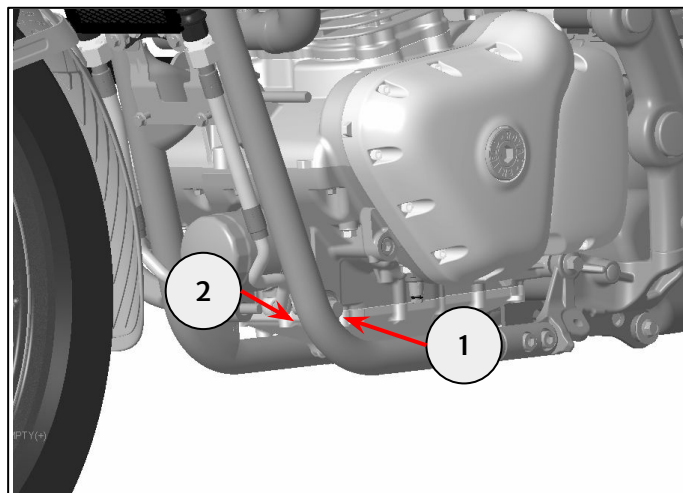

14mm socket with ratchet
14mm spanner

7 Fit the left side engine guard (1) lower mount with a spacer (2) from the kit. Ensure the engine guard has been fitted over the M10 x 180mm fixing from step 4 (3). Insert one M10 x 80mm fixing (4) from the kit from the right side of the motorcycle. Refit the original washer and nut (5). Do not fully tighten at this stage.

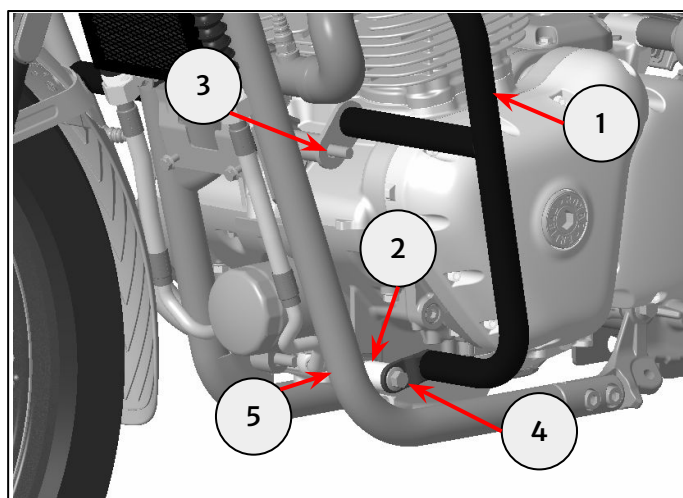

14mm socket with ratchet
14mm spanner

8 Refit the original washer and nut to the fixing (1). Tighten the upper fixing (2) to 45Nm. Tighten the lower right fixing (3) to 45Nm. Tighten the lower left fixing (4) to 45Nm.

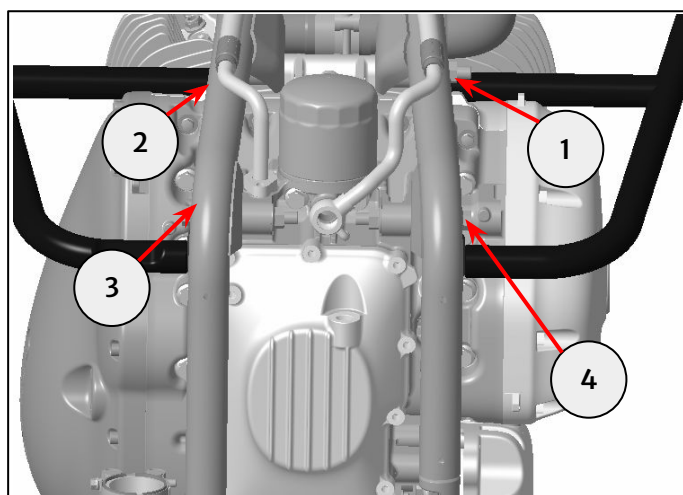

14mm socket with torque wrench
14mm spanner

Interceptor Bear models only

9 Slide the header pipe (1) into the rear clamp (2). Fit the header pipe into the right side engine mount (3) ensuring the gaskets are in place and refit the two header pipe fixings removed in step 1. Do not fully tighten at this stage.

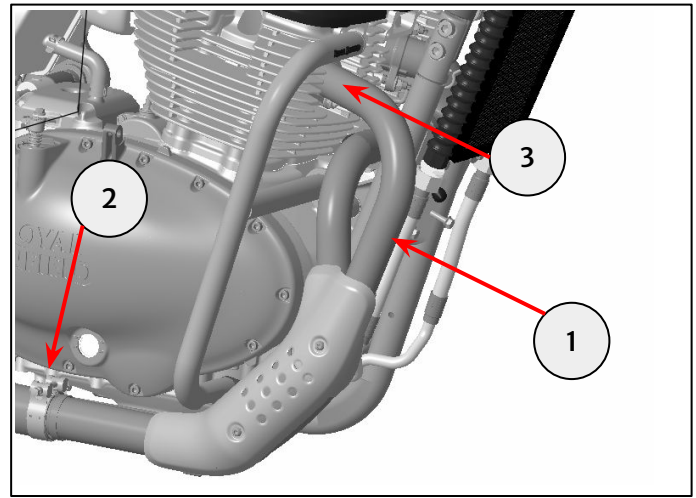

10 Slide the pipe into the front clamp (1). Tighten the two left header pipe fixings (2) removed in step 1, ensuring the gaskets are in place to **15Nm**. Tighten the two right side header pipe fixings (3) to **15Nm**. Tighten the clamps (1 and 4) to **32Nm**.

Note: 576287 - Gasket to be replaced while disturbing the exhaust assembly. Spares available through official RE dealers.

Note: After exhaust pipe assembly, ensure clearance between engine guard and surrounding parts.

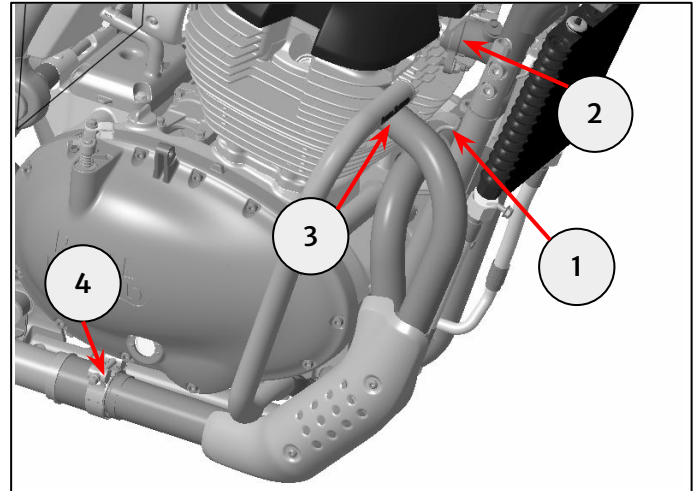

12mm socket with ratchet
8mm socket with ratchet



WARNING: After fitting any genuine Royal Enfield accessory always ride the motorcycle with caution and allow time to become familiar with any change in the motorcycle handling characteristics. Failure to become familiar with any change in the motorcycle handling characteristics may cause the motorcycle to become unstable and result in an accident.