

Part Number:
KXA00064, KXA00075

Models:
BSVI Classic, Bullet, Meteor 350,
Super Meteor 650, Shotgun 650

WARNING: Royal Enfield genuine accessories are designed to fit only the specific Royal Enfield motorcycle(s) that are specified above. They should not be fitted to any other type of motorcycle. Pay particular attention to the warnings and cautions contained in this instruction, failure to do so may result in an incorrect installation of the accessory which could result in an unsafe riding condition and possible accident. If in any doubt always seek help from your authorised Royal Enfield dealer.

WARNING: Before starting any accessory kit installation ensure the motorcycle is supported in a stable condition. Failure to support the motorcycle correctly could lead to motorcycle damage or personal injury.

WARNING: All fixings must be tightened to the torque values specified in this instruction. Failure to tighten fixings to the correct torque could result in an unsafe riding condition and possible accident

CAUTION: Care should be taken when fitting any accessory kit. Incorrect handling of kit components or the use of incorrect tools could lead to component or motorcycle damage.

NOTE: The content of this instruction is subject to change at any time without notice or liability. Royal Enfield reserves the right to revise the information presented at any time.

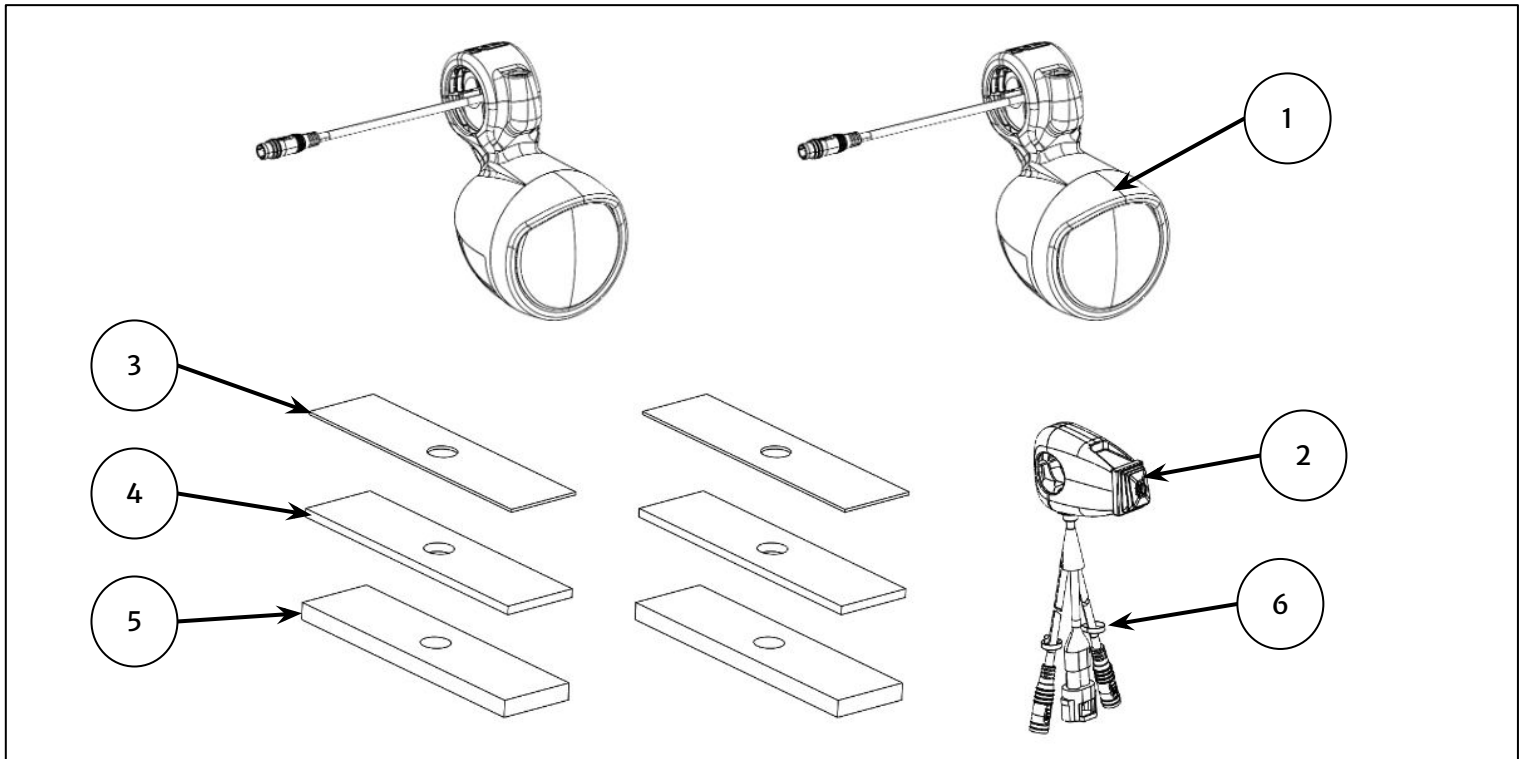

Item	Description	Qty
1	LED Fog Light Assembly	2
2	Fog Lamp Switch	1
3	1mm Rubber Sleeve	2
4	3mm Rubber Sleeve	2
5	6mm Rubber Sleeve	2
6	Cable Tie	2

All Models

1 Remove the side cover and disconnect the battery, as described in the Owner's Manual.

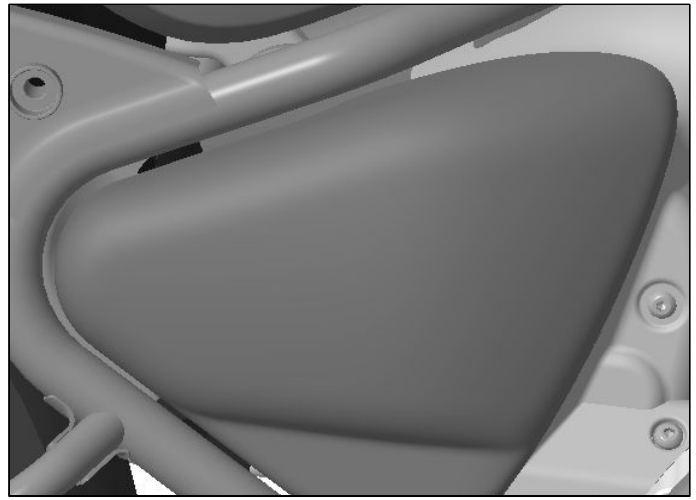

2 Remove the clamp from the light housing by removing the fixings (1).

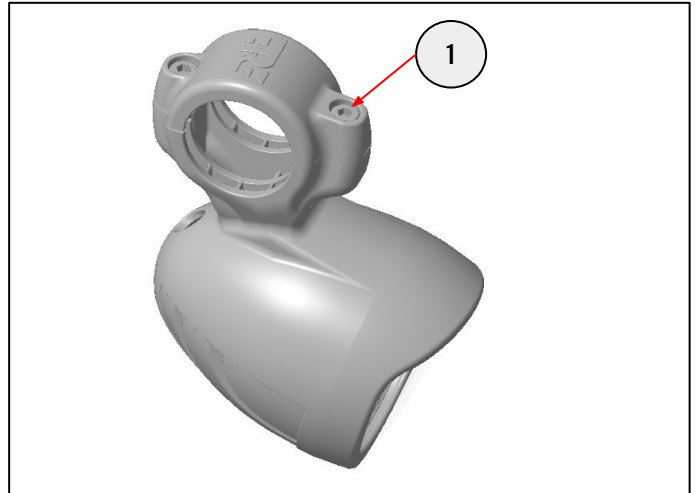
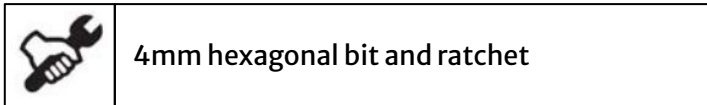

3 Place 3mm rubber sleeve (1) on light housing and insert the light harness (2) through the hole on the rubber sleeve. Keep the rubber sleeve as shown on image.

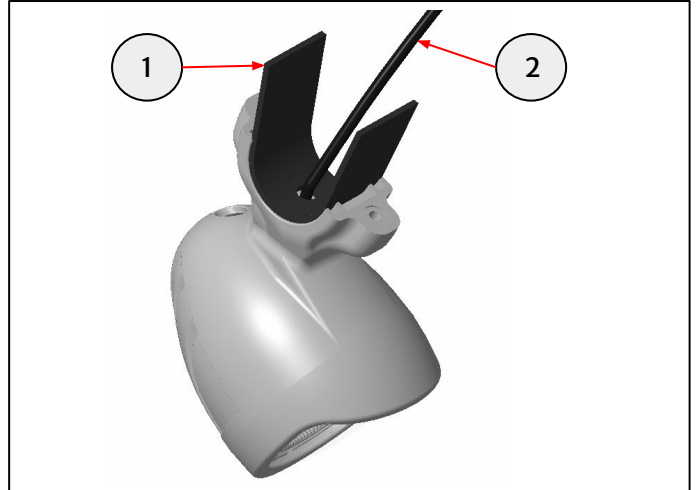

4 Route the cable (1) through the hole on the right hand side engine guard assembly (2) and pass the cable through the tube up to the engine guard mount.

Note: Routing the cable is made easier by orienting the engine guard with the mounts facing upwards.

For engine guard removal and fitment, refer to KXL00074/T5000014 fitting instructions.

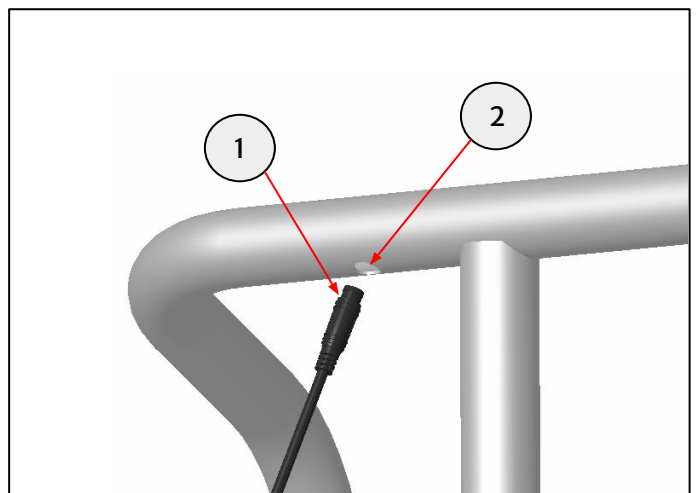

5 Align the light housing (1) on the right hand side engine guard assembly (2). Ensure that the hole on the rubber sleeve is aligned with the hole in the engine guard assembly.

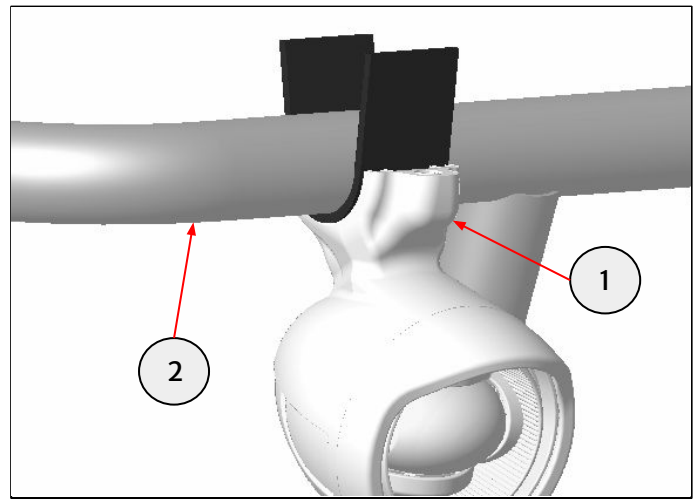

6 Fit the fixings (1) from the kit to secure the light housing (2) and the clamp (3), as shown. Do not fully tighten the fixing at this stage. Ensure the rubber sleeve (4) is seated properly as shown in the image.

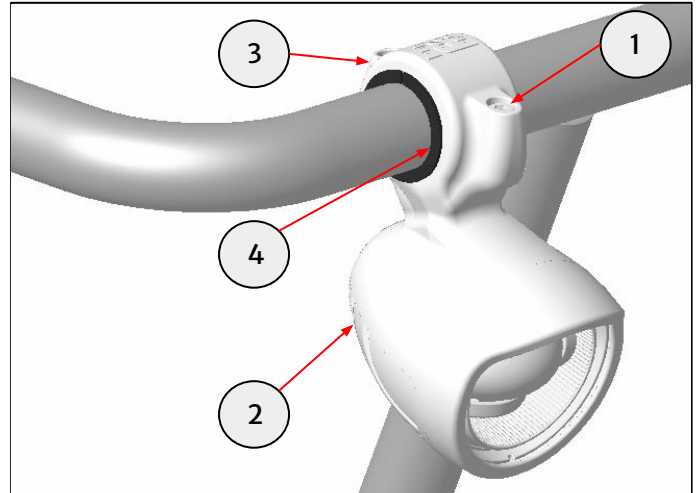

	4mm hexagonal bit and torque wrench
--	-------------------------------------

7 Repeat steps 2–6 for the left hand side.

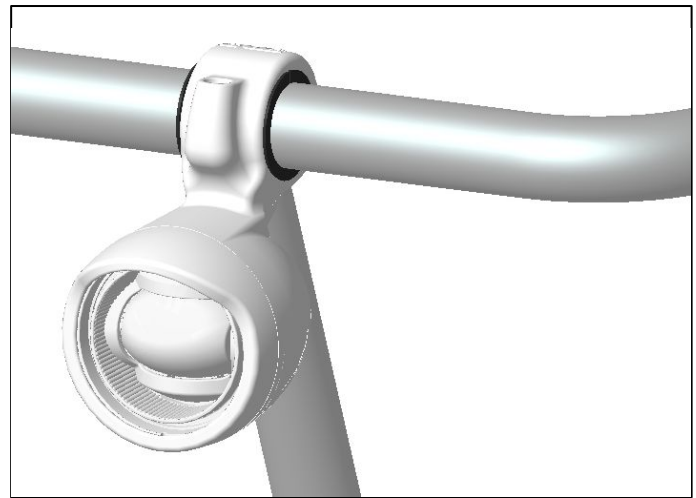

BSVI Classic, Bullet and Meteor 350 Models Only

8 Route both fog light cables (1) as shown in the image, inside the engine guard bracket (2). Ensure that cables are not trapped by any components.

For engine guard removal and fitment, refer to KXL00074 fitting instructions.

	4mm Hex bit socket and torque wrench
--	--------------------------------------

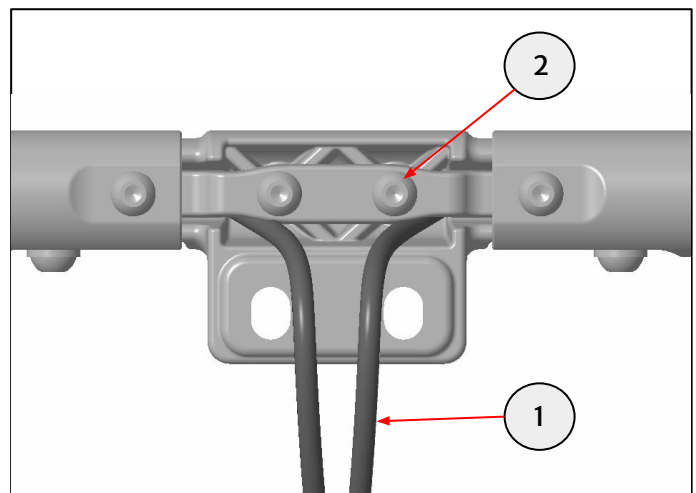

All Models

9 Fit the engine guard with assembled fog lights to the bike. Ensure the lamp is facing horizontally with the lens perpendicular to the ground. Tighten the fixings (1) to **4Nm**.



4mm hexagonal bit and torque wrench

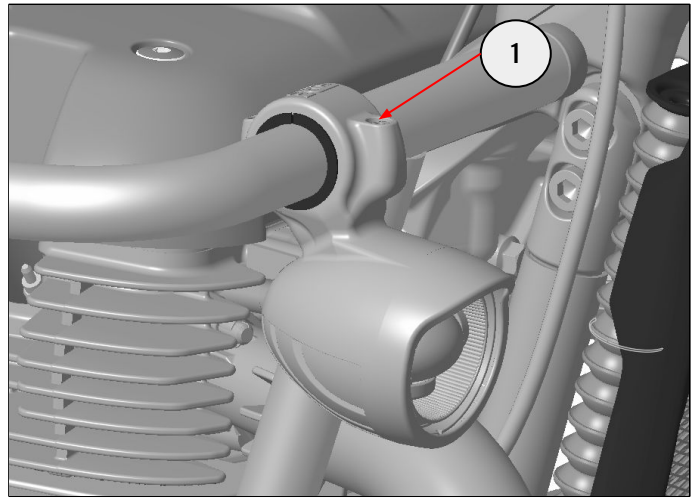

10 Remove the clamp from the switch by removing the fixings (1).



2.5mm hexagonal bit and ratchet

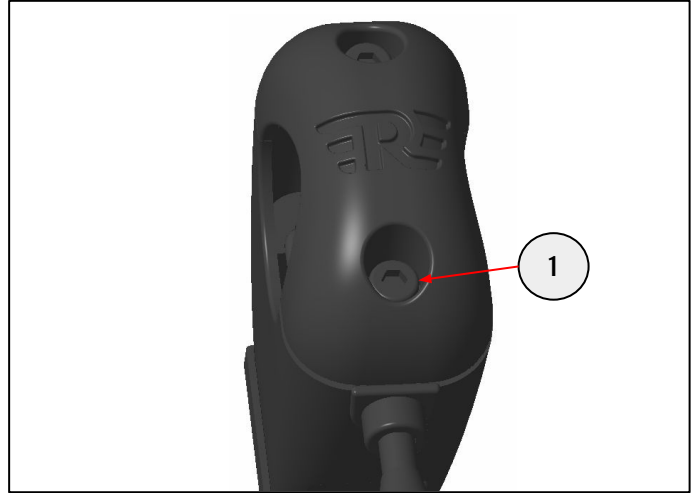

11 Align the switch (1) on the left hand side handlebar (2). Fit the fixings (3) to secure the switch (1) with the clamp (4).



2.5mm hexagonal bit and ratchet

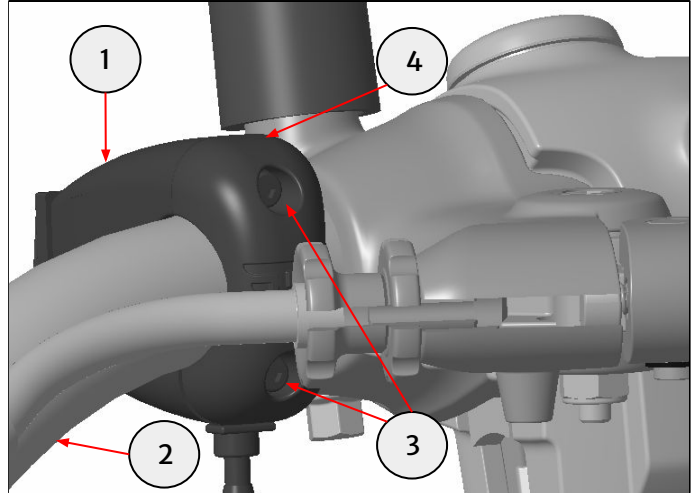

12 Tighten the fixings (1) to maintain a gap of 2 to 2.5mm between switch and clamp top and bottom.



2.5mm hexagonal bit and ratchet

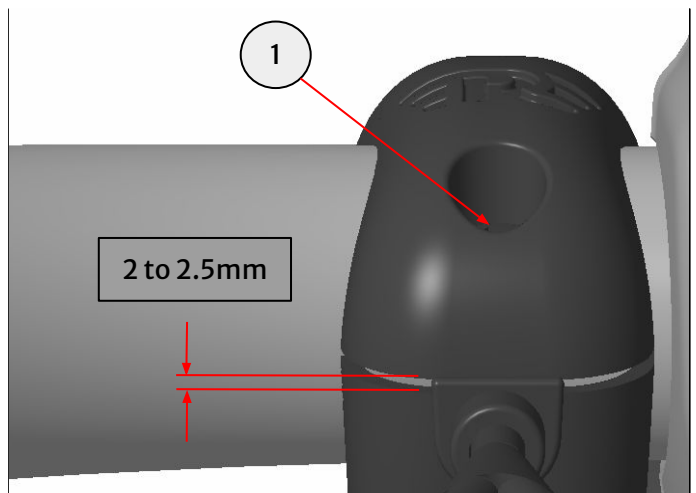

BSVI Classic and Bullet 350 Models Only

13 Remove fixings (1) on both sides and retain for reuse.



Phillips PZ2 bit and ratchet

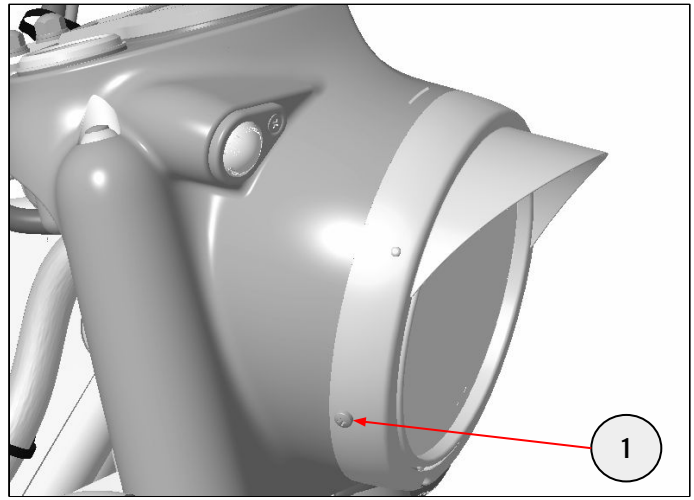

BSVI Meteor 350 and Super Meteor Models Only

14 Remove fixings (1) on both sides and retain for reuse.



Phillips PH2 bit and ratchet

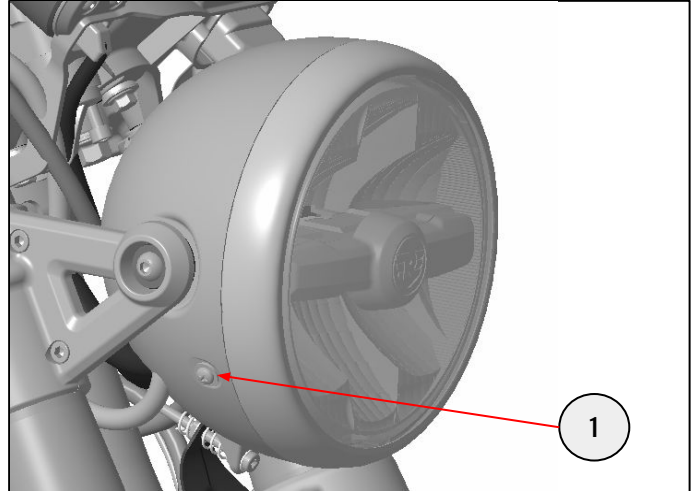

Shotgun 650 Models Only

15 Remove fixings (1) and fixings with spacers (2) and retain for reuse.



4mm hexagonal bit and ratchet

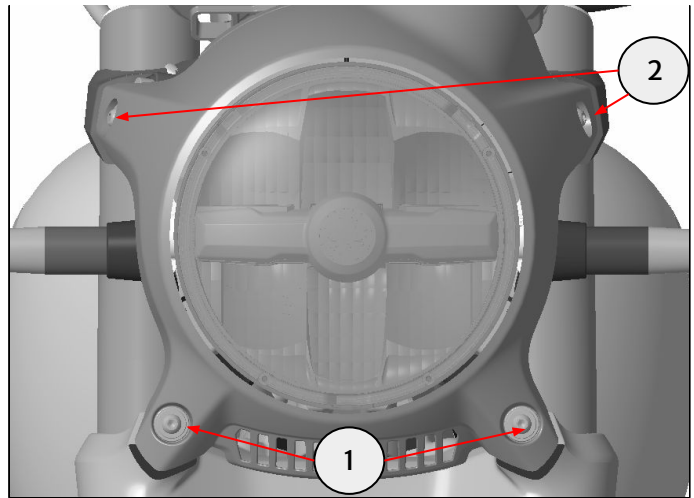

All Models

16 Remove the headlight assembly (1) by disconnecting the light harness (2).

Retain headlight assembly (1) for reuse.

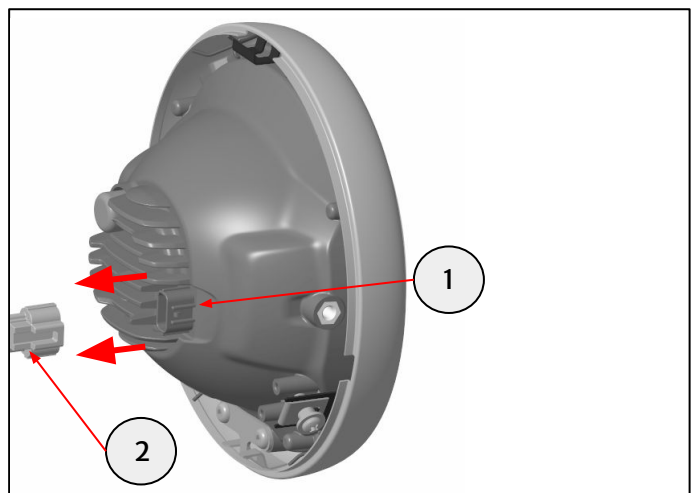

BSVI Meteor 350 Models Only

17 Remove the plastic retention plate (1) by removing the plastic rivets (2) and retain for reuse. The retention plate to be freely hanging on other cables when removed.



Phillips screwdriver

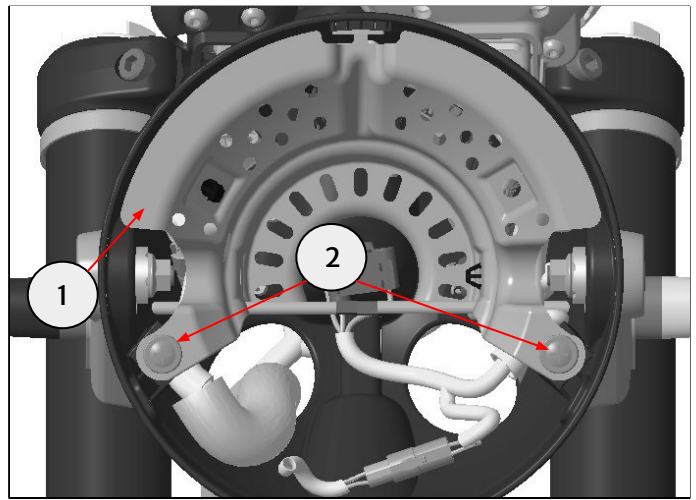

Super Meteor 650 and Shotgun 650 Models Only

18 Remove the plastic retention plate (1) by removing the fixing (2) and retain for reuse. The retention plate to be freely hanging on other cables when removed.



T20 Torx bit and ratchet

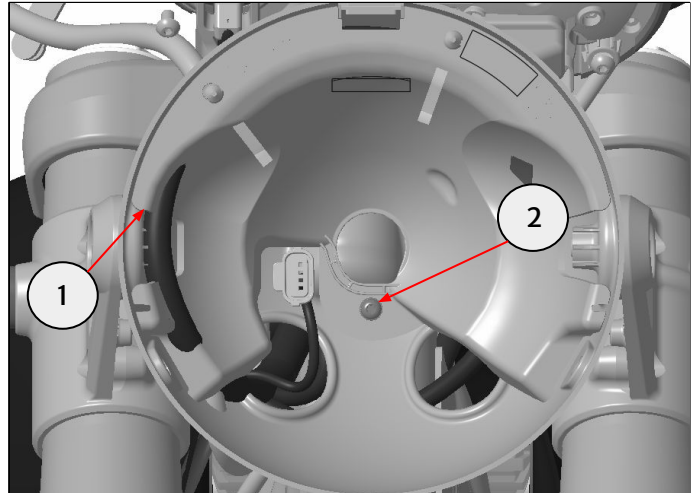

19 Route the left hand side fog light cable (1) along the brake hose (2) towards the headlight assembly. Use the cable tie (3) from the kit to secure the fog light cable (1) to the brake hose (2) as shown.

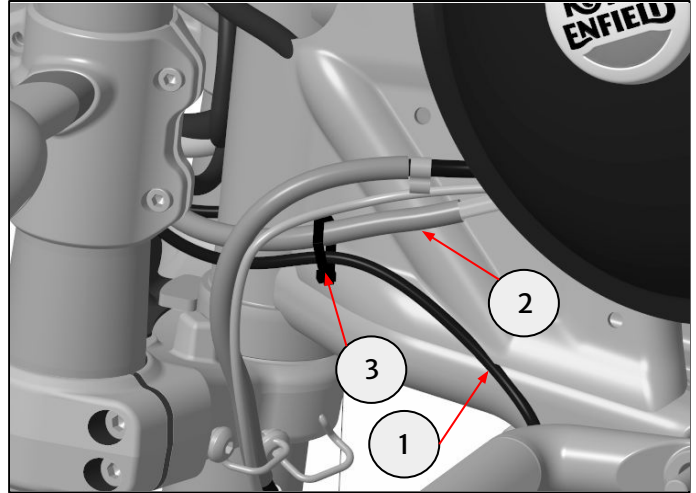

BSVI Classic, Bullet and Meteor 350 Models Only

20 Route both fog light cables (1) towards the headlight assembly, along the main harness (2).

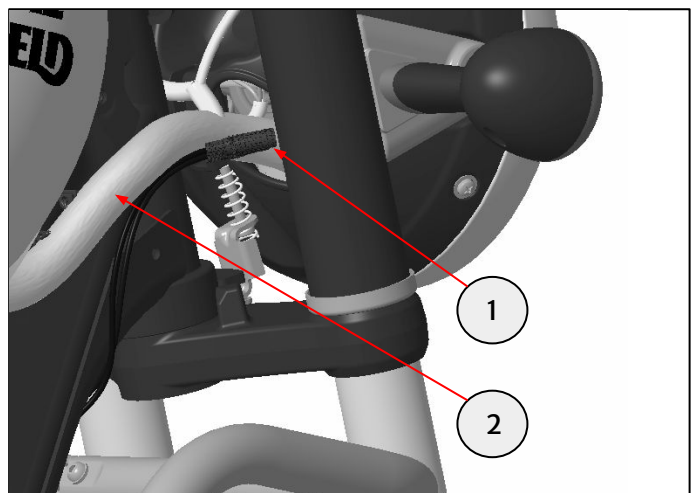

All Models

21 Remove all cable straps (1) on the handlebar and retain for reuse.

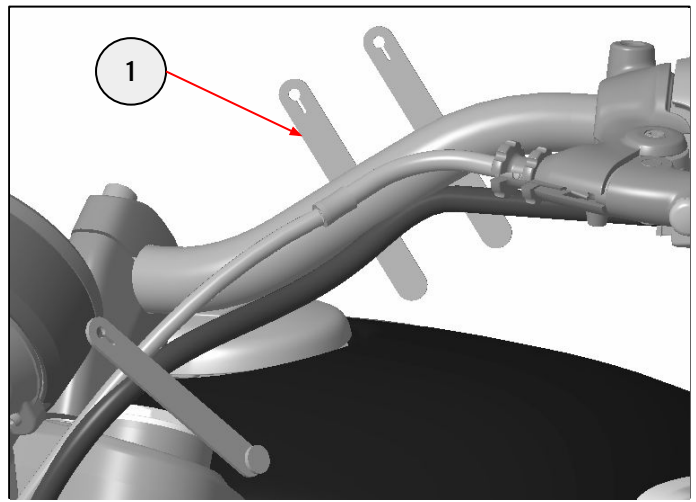

22 Route the fog light switch harness (1) along the switch cube cable (2). Pass it through the left hand side hole (3) in the back of the headlight and then refit the cable straps removed in step 21.

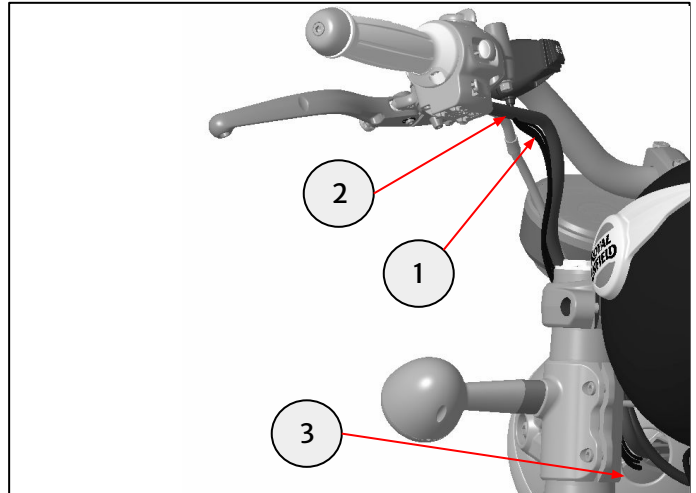

23 Take off the plastic cap from the connector (1) inside the headlight housing and connect it to the fog light switch connector (2).

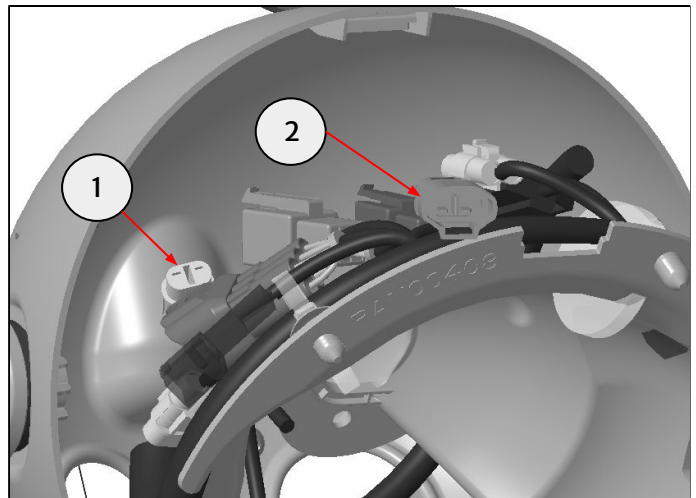

24 Route the two fog light switch cables (1) through the right hand side hole in the headlight housing (2).

BSVI Classic, Bullet 350 and Meteor 350 Models Only

Connect both connectors with left hand and right hand side fog light connectors.

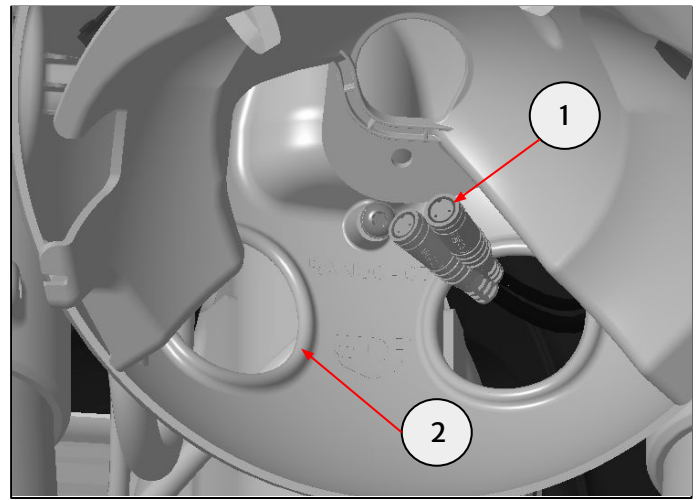

Super Meteor 650 and Shotgun 650 Models Only

Route the right hand side fog light cable (1) through the omega clip for the clutch cable (2) before connecting the fog light connectors. Use the cable tie (3) from the kit to secure the fog light cable (1) to the main harness (4) as shown.

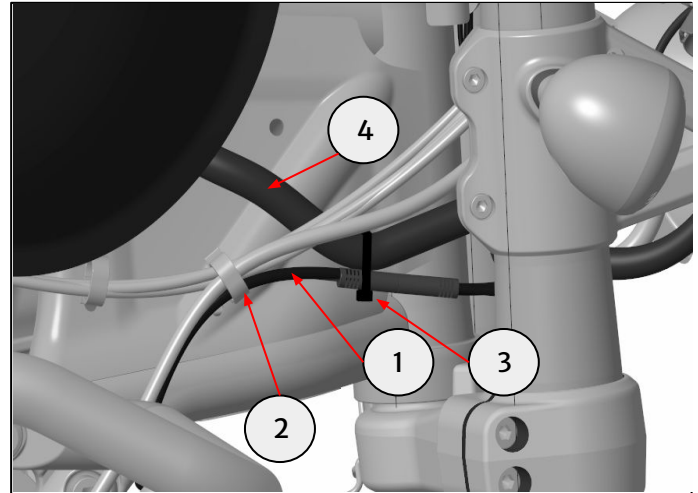

BSVI Classic, Bullet 350 and Meteor 350 Models Only

25 Use the cable tie (1) from the kit to secure the fog light cables (2) to the main harness (3).

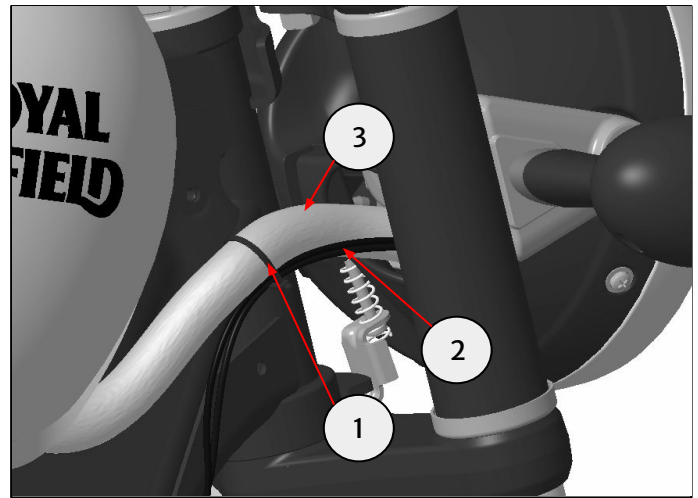

Meteor 350 Models Only

26 Assemble the plastic retention plate (1) into the headlight housing (2) by pressing on the plastic rivets (3) and tightening.

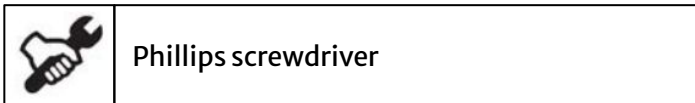

Phillips screwdriver

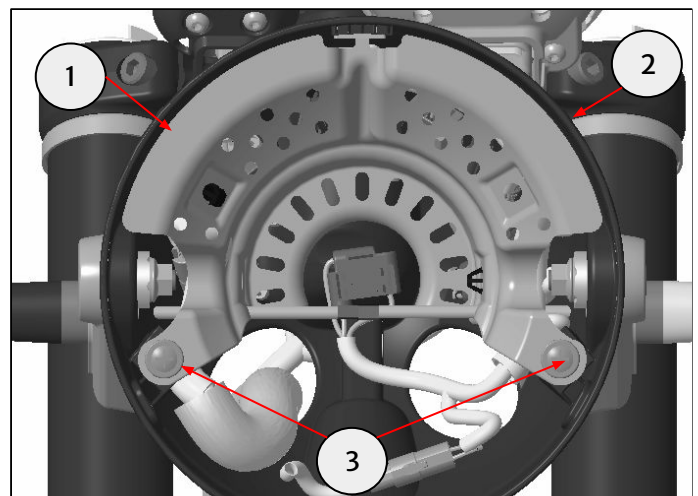

Super Meteor 650 and Shotgun 650 Models Only

27 Assemble the plastic retention plate (1) back to the headlight housing (2). Tighten the fixing (3) to **1.5 Nm**.



T20 Torx bit and torque wrench

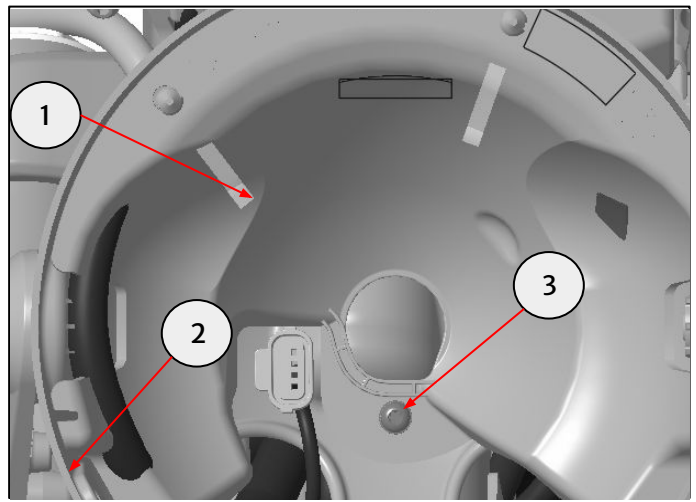

BSVI Classic and Bullet 350 Models Only

28 Any excess fog light harness length should be retained inside the headlight assembly. Reconnect the headlight connector to the vehicle. Assemble headlight (1) back to the headlight housing (2). Tighten fixings (3) on both sides to **6 Nm**.



Phillips PZ2 bit and torque wrench

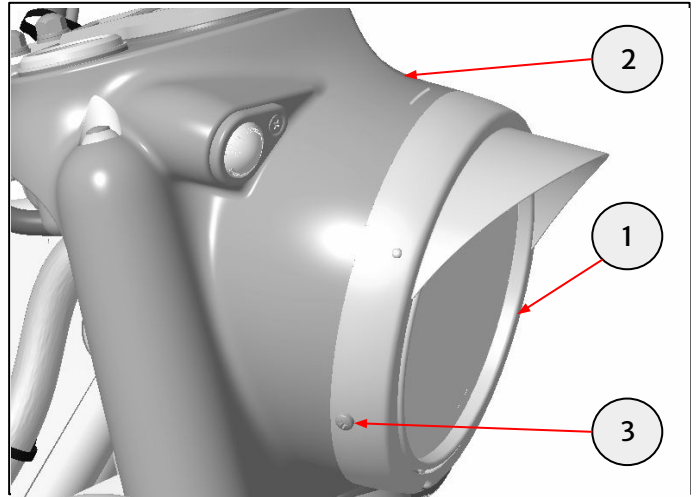

BSVI Meteor 350 and Super Meteor 650 Models Only

29 Any excess fog light harness length should be retained inside the headlight assembly. Reconnect the headlight connector to the vehicle. Assemble headlight (1) back to the headlight housing (2). Tighten fixings (3) on both sides to **2.5 Nm**.



Phillips PH2 bit and torque wrench

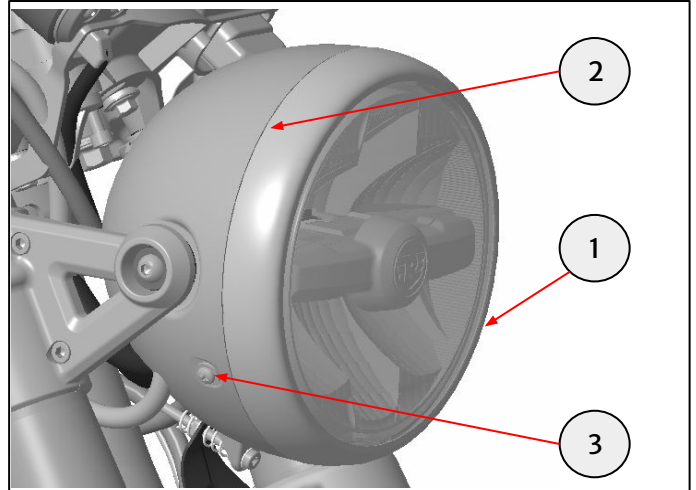

Shotgun 650 Models Only

30 Any excess fog light harness length should be retained inside the headlight assembly. Reconnect the headlight connector to the vehicle. Assemble headlight assembly (1) to the upper (2) and lower (3) yokes. Tighten the M6 x 20 fixings (4) and the M6 x 45 fixings with spacer (5) to **6 Nm**.



4mm hexagonal bit and torque wrench

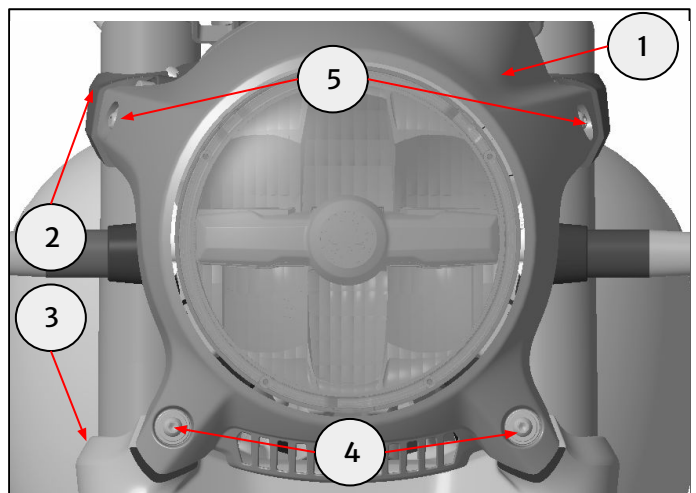

All Models

31 Before operation ensure fog light cables operate freely with no interference when handlebars are rotated from lock to lock.

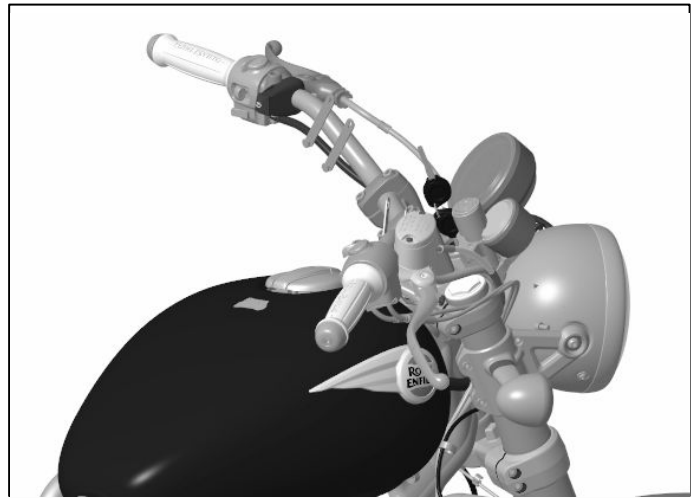

32 Connect the battery and assemble the side cover, as described in the Owner's Manual.

Note: Fog lamps will operate only when the engine is running.

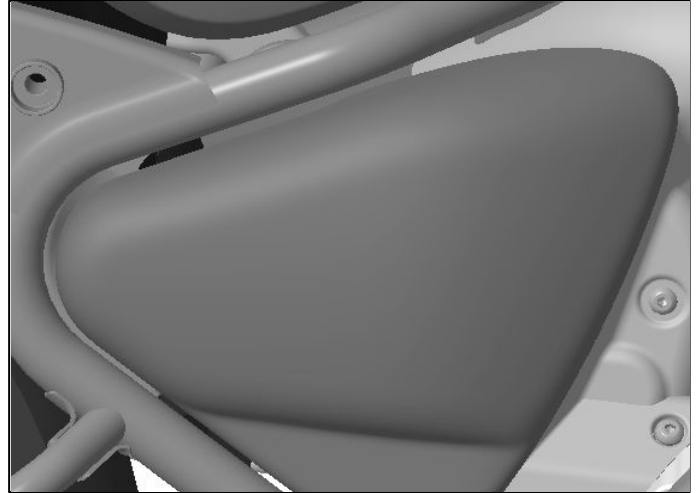

WARNING: After fitting any genuine Royal Enfield accessory always ride the motorcycle with caution and allow time to become familiar with any change in the motorcycle handling characteristics. Failure to become familiar with any change in the motorcycle handling characteristics may cause the motorcycle to become unstable and result in an accident.