

Part Number:
KXA00046, KXA00254, KXA00282,
KXA00081

Models:
BSVI Meteor 350

WARNING: Royal Enfield genuine accessories are designed to fit only the specific Royal Enfield motorcycle(s) that are specified above. They should not be fitted to any other type of motorcycle. Pay particular attention to the warnings and cautions contained in this instruction, failure to do so may result in an incorrect installation of the accessory which could result in an unsafe riding condition and possible accident. If in any doubt always seek help from your authorised Royal Enfield dealer.

WARNING: Before starting any accessory kit installation ensure the motorcycle is supported in a stable condition. Failure to support the motorcycle correctly could lead to motorcycle damage or personal injury.

WARNING: All fixings must be tightened to the torque values specified in this instruction. Failure to tighten fixings to the correct torque could result in an unsafe riding condition and possible accident

CAUTION: Care should be taken when fitting any accessory kit. Incorrect handling of kit components or the use of incorrect tools could lead to component or motorcycle damage.

NOTE: The content of this instruction is subject to change at any time without notice or liability. Royal Enfield reserves the right to revise the information presented at any time.

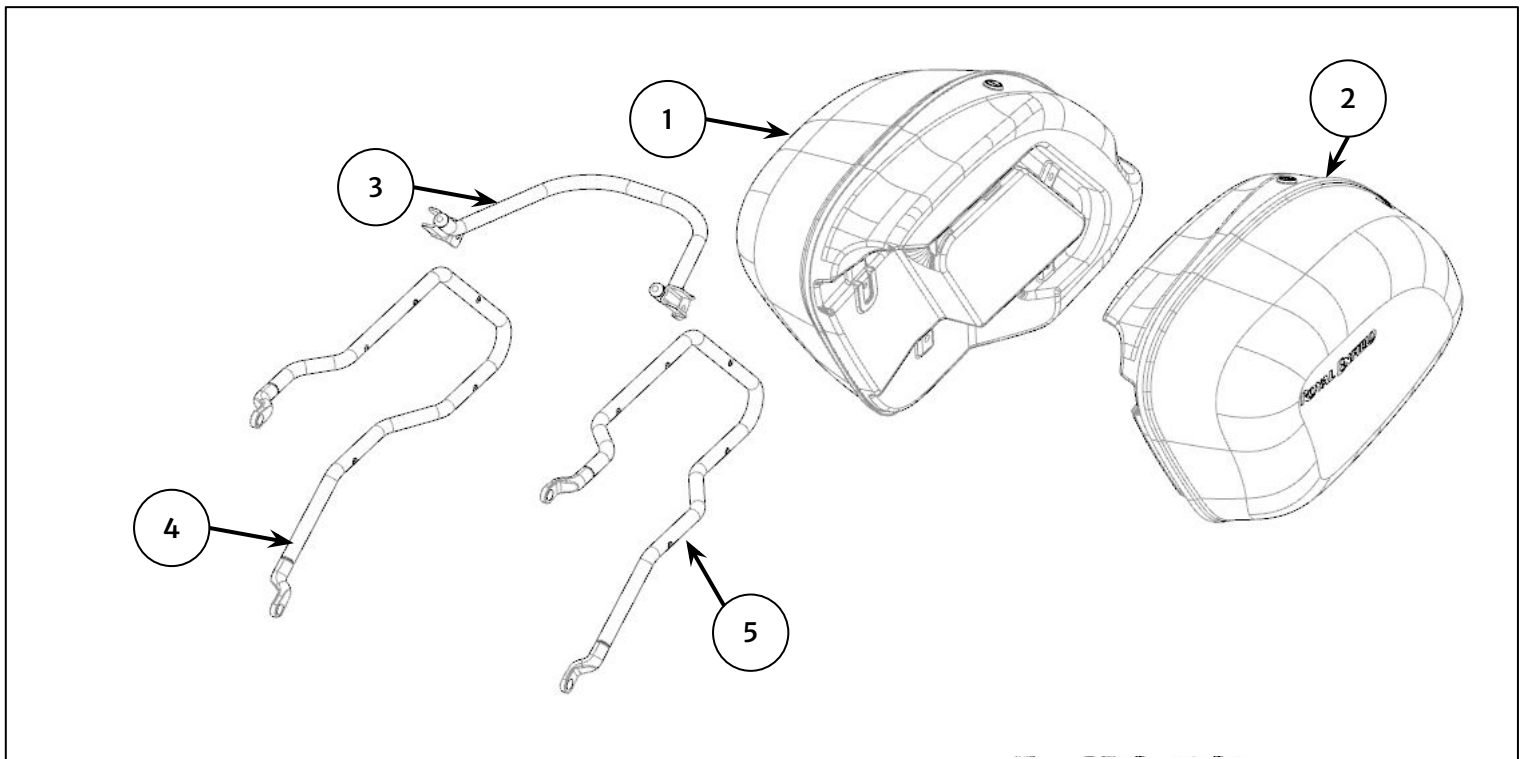

Item	Description	Qty
1	Pannier Box RH	1
2	Pannier Box LH	1
3	Tie Bar	1
4	Pannier Rail RH	1
5	Pannier Rail LH	1

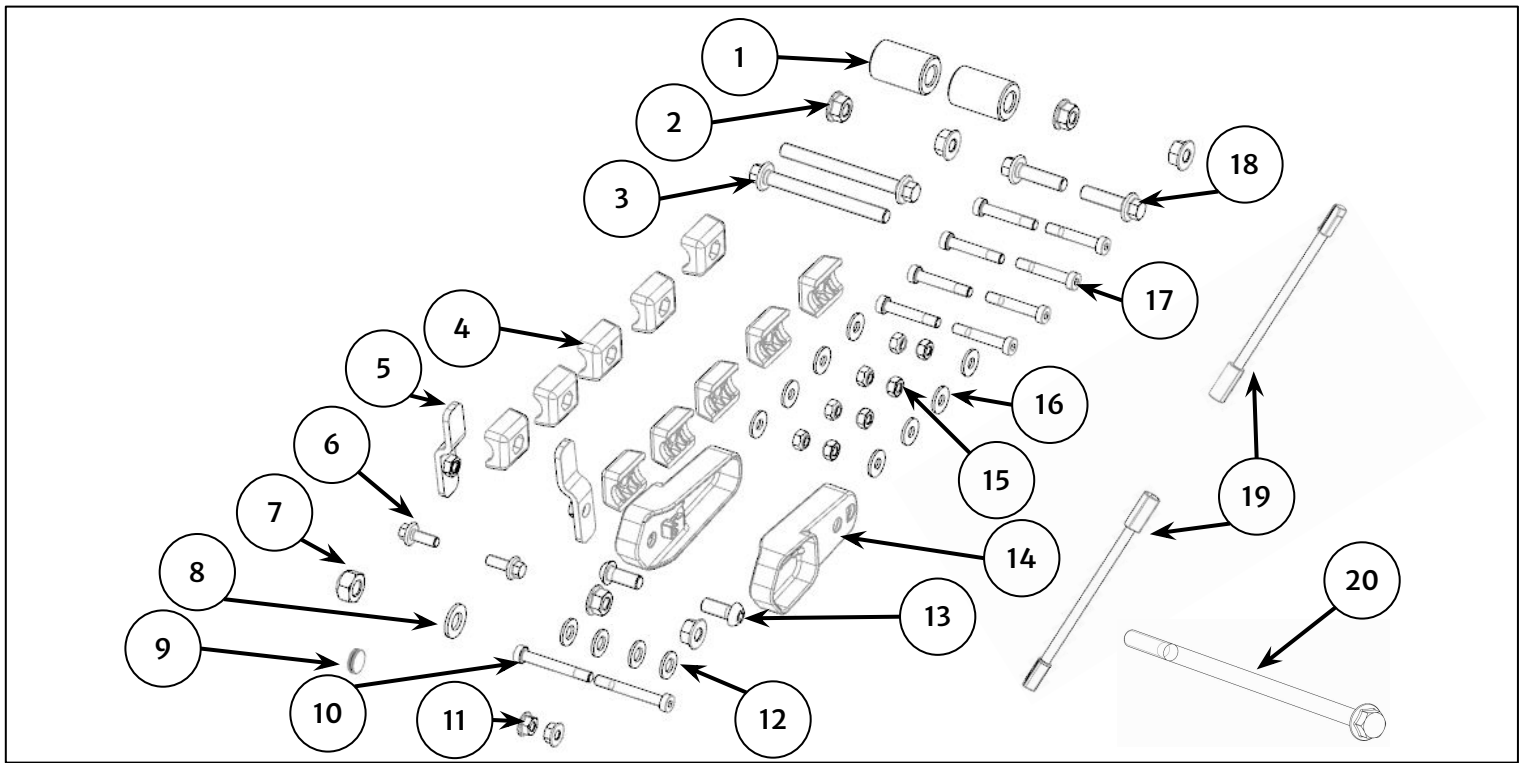

Item	Description	Qty
1	Spacer Boss	2
2	Nut, M8 Flange	6
3	Fixing, M8 x 80mm	2
4	Pannier Mount	10
5	Pannier Front Mount	2
6	Fixing, M6 x 16mm	2
7	Nut, M10	1
8	Washer, 10.5mm	1
9	Hole Cap	1
10	Fixing, M6 x 45mm	2
11	Nut, M6 Flange	2
12	Washer, 8.4mm	4
13	Fixing, M8 x 20mm	2
14	Indicator Relocation Bracket	2
15	Nut, M6 Nylon Locking	8
16	Washer, 6.4mm Black	10
17	Fixing, M6 x 35mm	8
18	Fixing, M8 x 30mm	2
19	Flying Lead	2
20	Fixing, M8 x 205mm	1

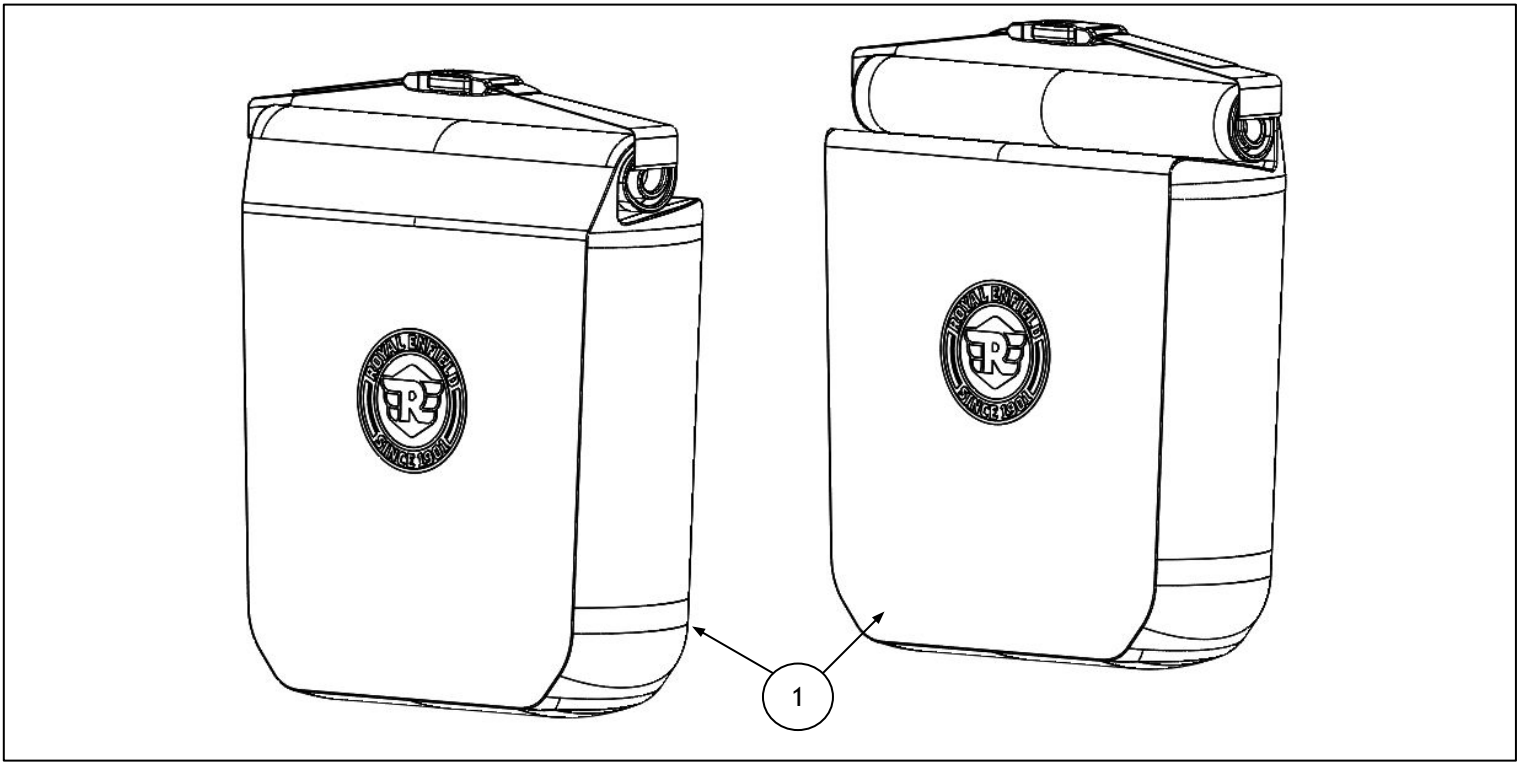

Item	Description	Qty
1	Long haul pannier waterproof inner bag	2

1 Ensure the bike is secured on its center stand as described in the owner's manual.

Also disconnect the battery as described in the owner's manual.



2 Ensure no weight is acting on the rear wheel (1), and remove the fixings (2 and 3) and the rear frame cap (4). Remove the saree guard (5) and side handle (6), then fill the rear mudguard hole with the cap from the kit.

Retain Fixings (2) and saree guard (5) for reuse. Retain fixings (3), the rear frame cap (4) and side handle (6) for reuse if the motorcycle is to be returned to its original condition.

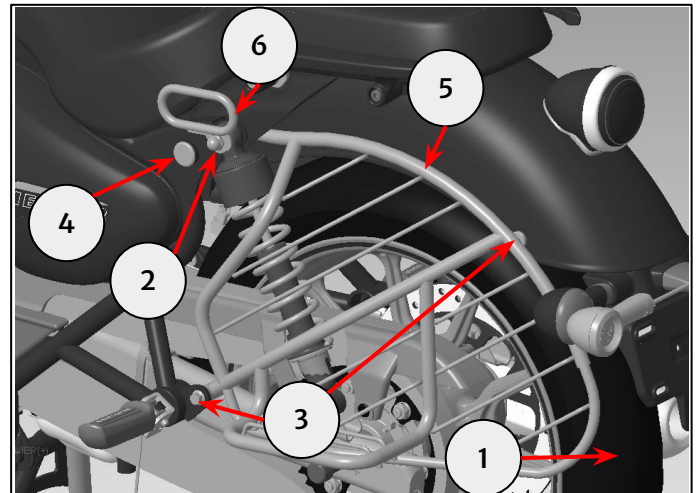

	17mm socket and ratchet 17mm spanner 12mm socket and ratchet 10mm socket and ratchet
--	---

3 Refit the fixing (1) removed in step 2 using the M10 nut (2) and 10.5mm washer (3) from the kit.

Tighten fixing (1) to **45NM**.

Note: When tightening, use the open side of the spanner to avoid the spanner getting trapped.

	17mm socket and torque wrench 17mm spanner
--	---

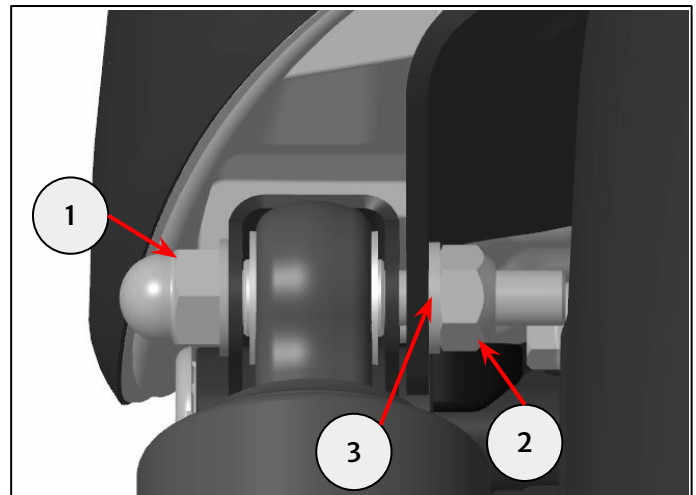

4 Remove the rear number plate moulding (1) by removing the fixings (2) and disconnecting the 3 cables (3).

Note: Rear wheel has been removed for visual purposes only.

Retain the rear number plate moulding (1) and fixings (2) for reuse.

	5mm hexagonal bit and ratchet
--	-------------------------------

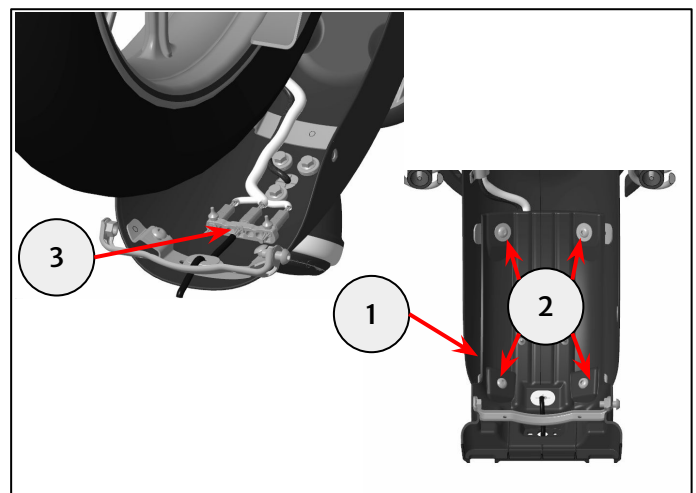

5 Remove the rear indicator (1) and steel indicator bracket (2) by removing the fixing (3).

Repeat step 5 for the right side.

Retain indicator (1), steel indicator bracket (2) and fixing (3) for reuse.

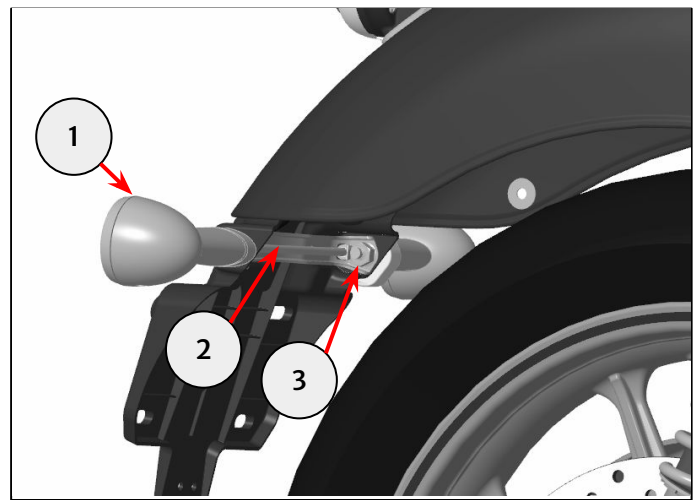
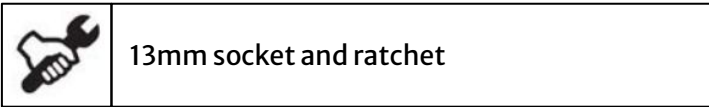

6 Fit the indicator (1) removed in step 5, into the extension bracket (2) from the kit and secure with the fixing (3) removed in step 5. Reroute the indicator cable (4) as shown, by folding the cable and passing it through the opening. Connect the indicator cable (4) to the flying lead (5) from the kit, as shown.

Do not fully tighten the fixing (3) at this stage.

Repeat step 6 for the right side.

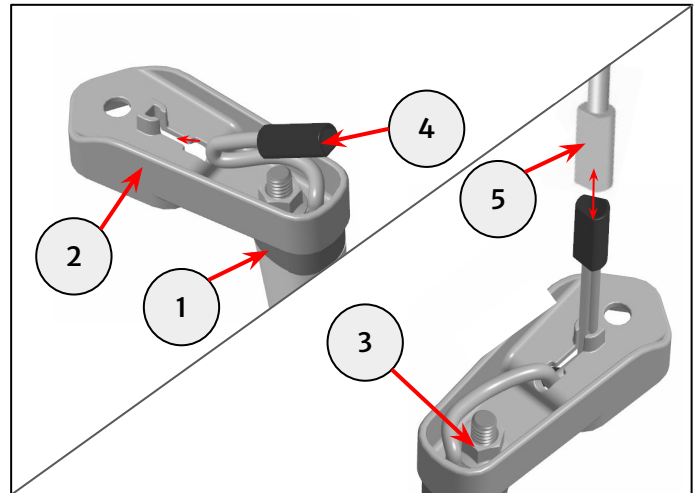
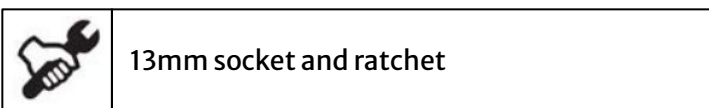

7 Align the indicator assembly (1) to the number plate mount (2). Feed the flying leads (3) through the rubber seal (4) and reconnect all 3 cables. Refit the number plate mount (2) using the fixings (5) removed in step 4.

Repeat step 7 for the right side.

Tighten fixings (5) to **10NM**.

Note: Rear mudguard and wheel have been removed for visual purposes only.

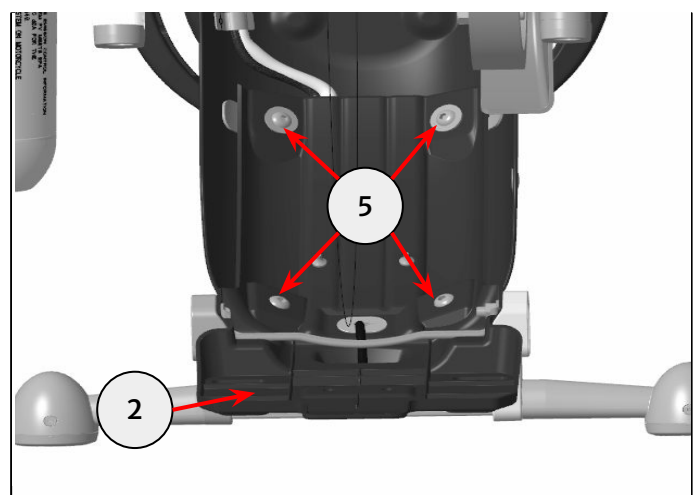
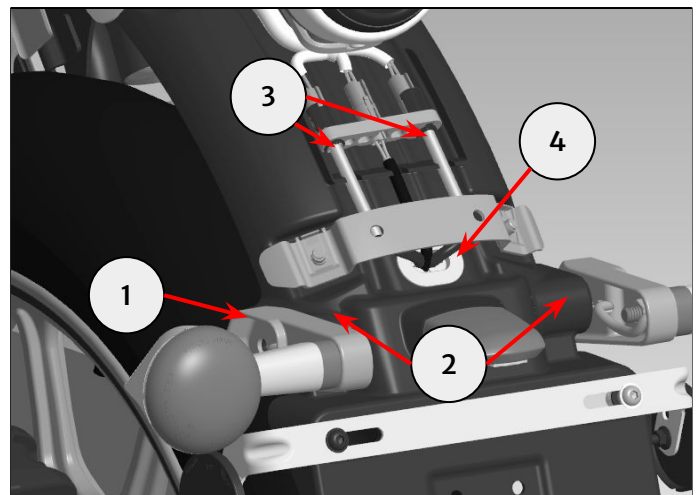
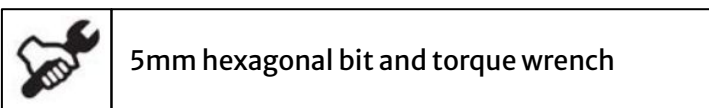

8 Align the extension bracket (1) rear hole to the number plate mount (2) and steel indicator bracket (3) removed in step 5.

Fit an M8 x 20mm fixing (4) through the holes and secure with an 8.4mm washer (5) and M8 flange nut (6) from the kit.

Tighten fixing (6) and (7) to **6NM**.

When tightening fixing (7) maintain the orientation of the indicator (8) using a 24mm spanner (9).

Repeat step 8 for the right side.

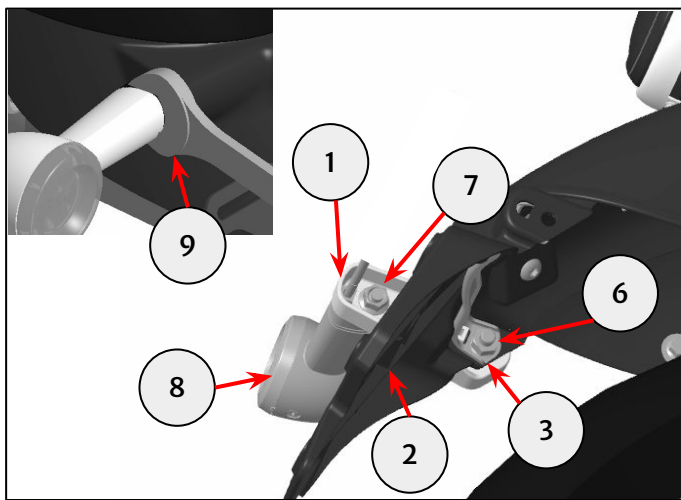

 5mm hexagonal bit and torque wrench
13mm socket and torque wrench
12mm spanner
24mm spanner

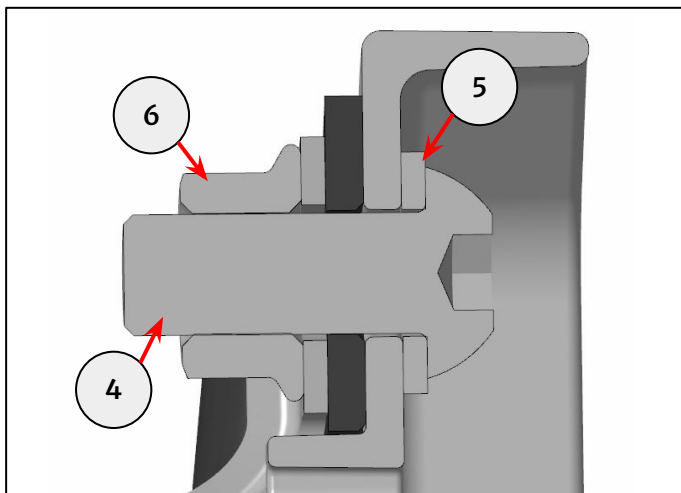

9 Fit a spacer boss (1) from the kit, into the frame sleeve on the frame. Align the top mounting hole of the left pannier rail (2) with the spacer boss (1), and the bottom mounting hole with the inside of the frame lower mounting hole (3).

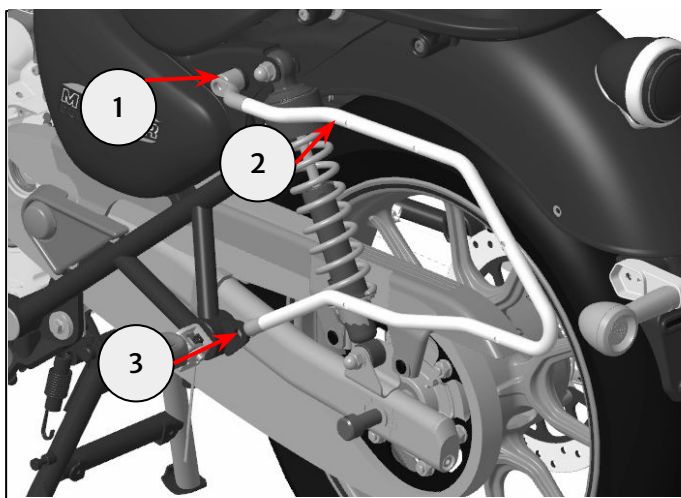

10 Fix the pannier rail (1) to the frame (2) using an M8x80mm fixing (3) and M8 flange nut (4) from the kit.

Tighten fixing (3) to **30NM**.

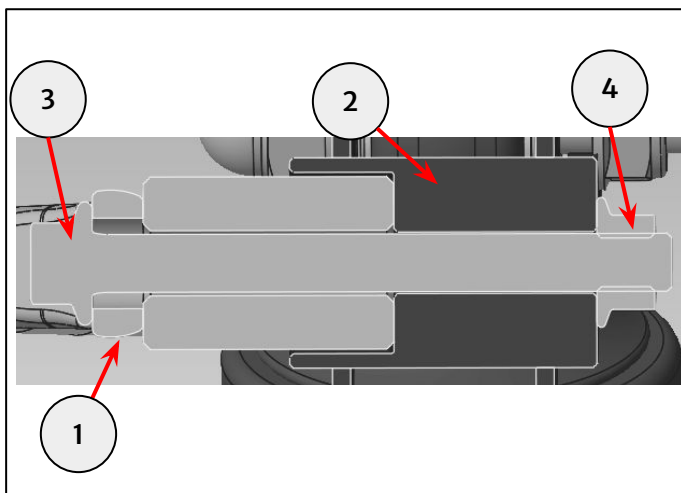

11 Fix the pannier rail (1) to the lower mounting hole of the rear frame (2) using an M8 x 30mm fixing (3) and an M8 flange nut (4).

Do not fully tighten at this stage.

Repeat steps 9–11 for the right side.



10mm socket and ratchet
13mm spanner

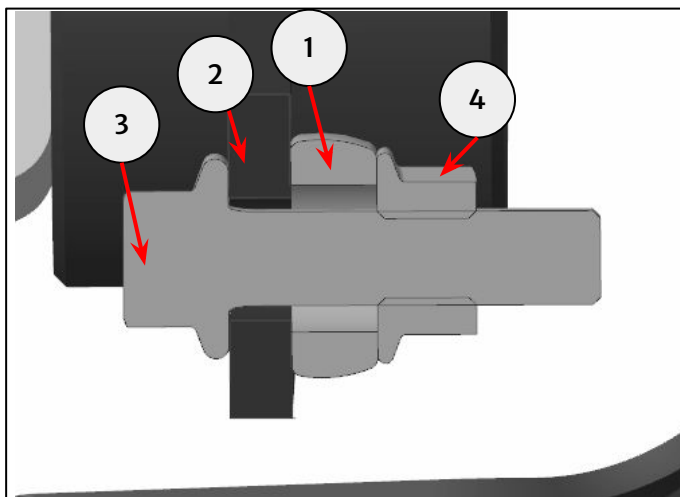

12 Align the tie bar (1) with the pannier rails (2) rear mounting hole and fit pannier mounts (3) from the kit as shown.

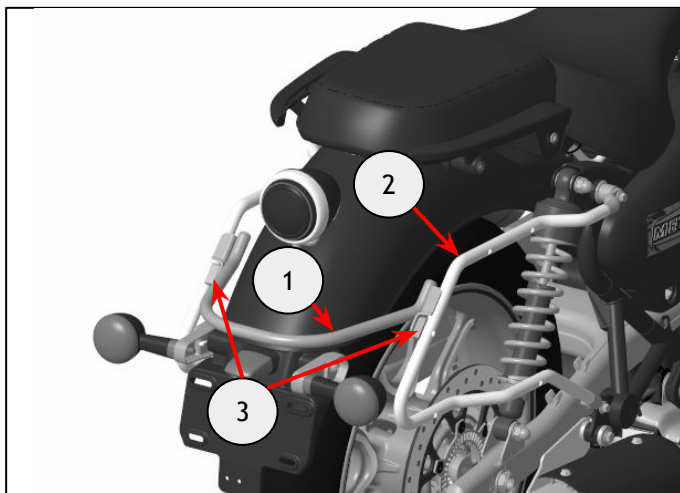

13 Examine the position of pannier rails and rear mudguard. If adjustment is required, refer to steps 22–30.

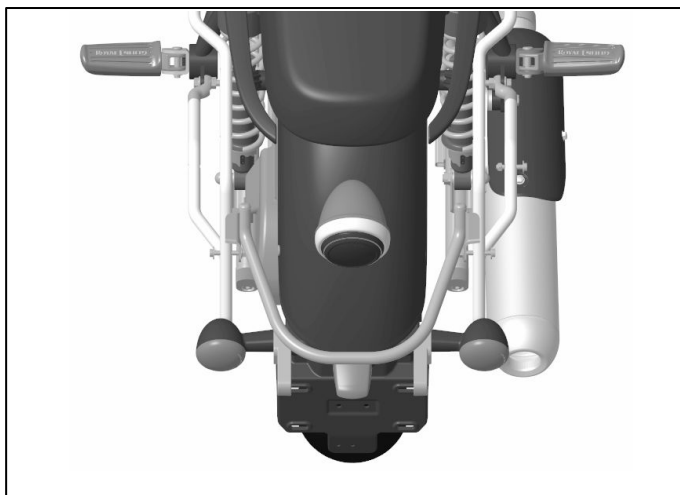

14 Loosely assemble the pannier mount (1) at the back of the pannier as shown using an M6 x 16mm fixing from the kit.



8mm socket and ratchet

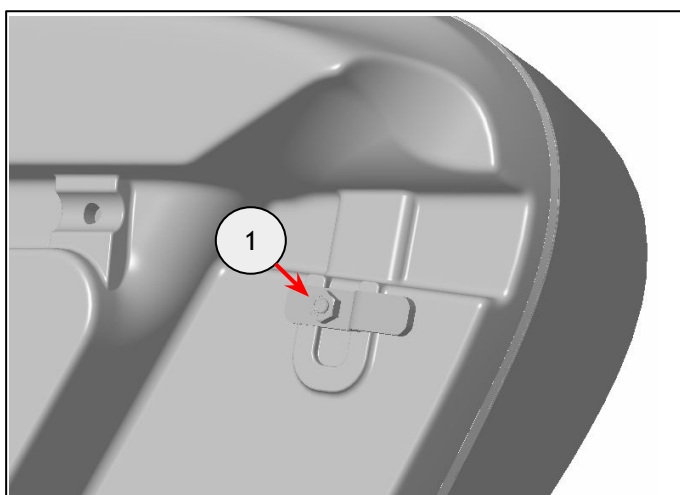

15 Secure the left pannier (1) to left pannier rail (2) using the M6 x 35mm fixings (3), 6.4 mm washers (4), pannier mounts (5) and M6 nylon locking nuts (6) from the kit.

Do not fully tighten at this stage.



4mm hexagonal bit and ratchet

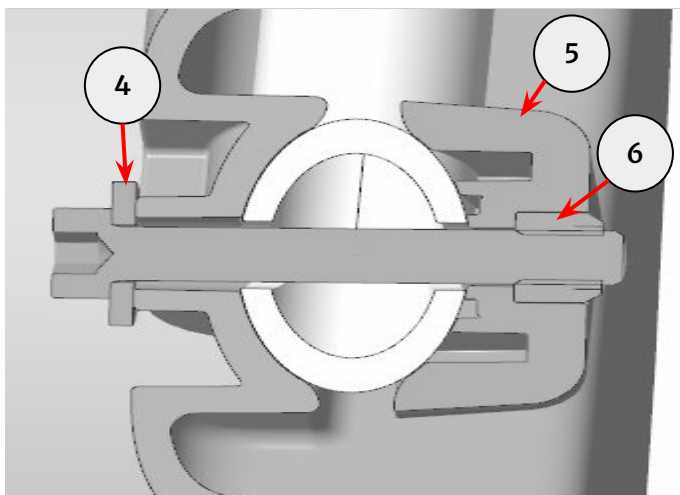
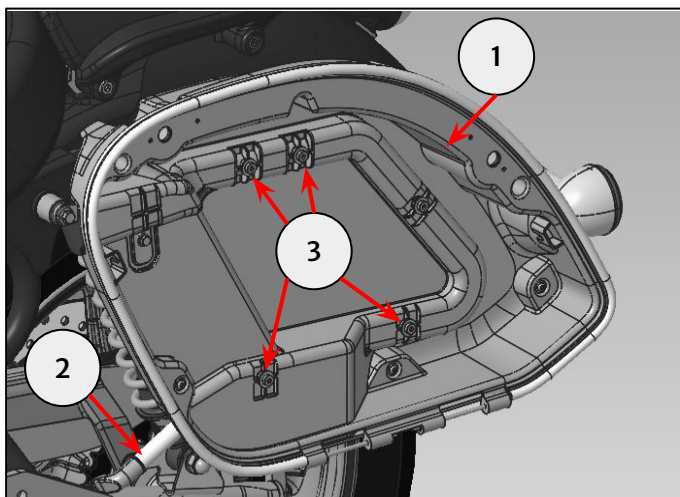

16 Fix the left pannier (1) to the left pannier rail (2) and the tie bar mount (3) using an M6 x 45mm fixing (4), pannier mount (5), an M6 flange nut (6) and 6.4 mm washer (7) from the kit.

Do not fully tighten at this stage.

Repeat step 14-16 for the right side.



4mm hexagonal bit and ratchet
10mm spanner

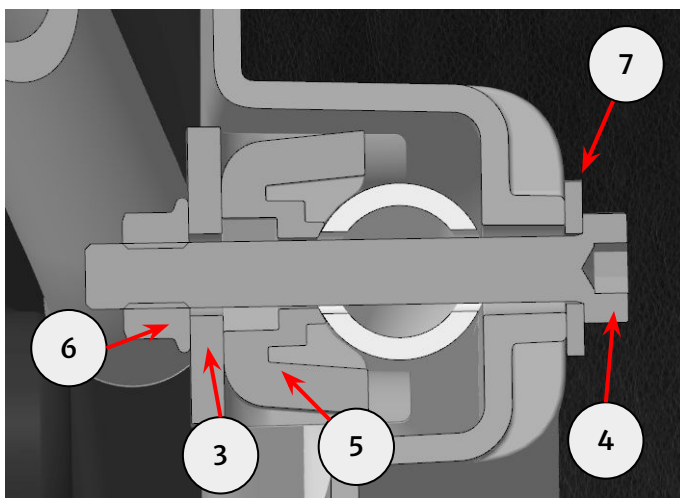
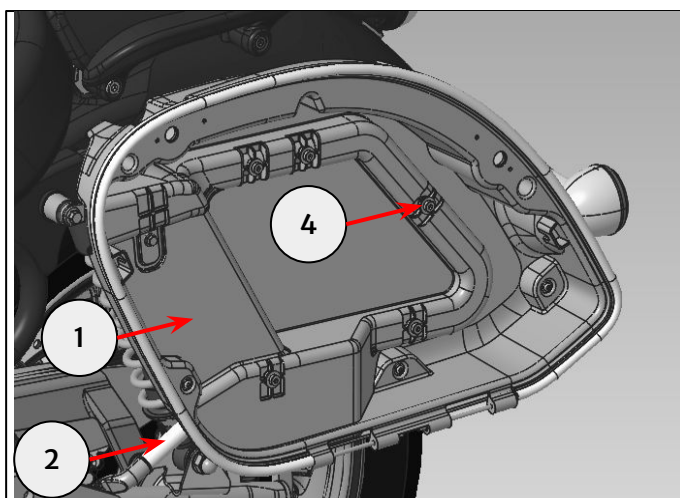

17 Tighten fixings (1) to **10NM**, fixings (2) to **6NM** and fixing (3) to **30NM**.

Repeat step 17 on the right side.



4mm hexagonal bit and torque wrench
10mm spanner
13mm spanner
12mm socket and torque wrench.

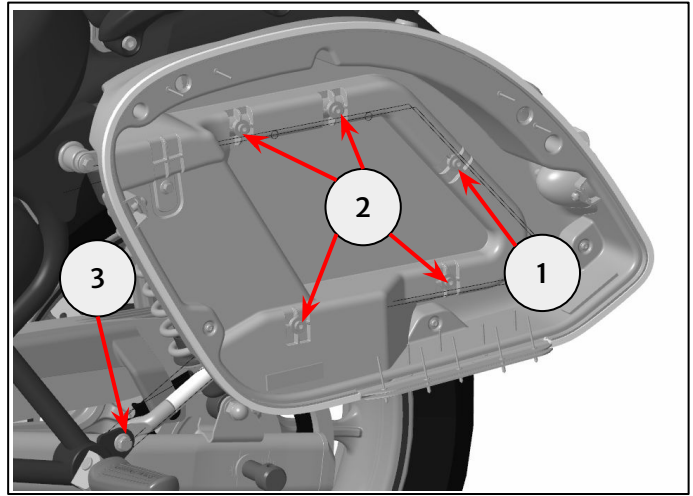

18 Rotate the pannier mount (1).

Tighten to **10 Nm**.

Repeat step 18 on the right side.



8mm socket and torque wrench

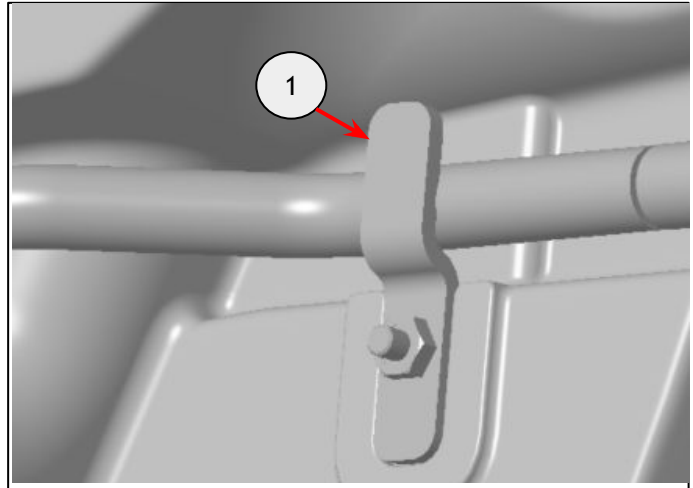

19 Reconnect the battery as described in the owner's guide.



20 Fill the inner bags (1), leaving enough room to roll the top and fit them in the panniers (2).

Note: Max capacity 5kg per pannier.

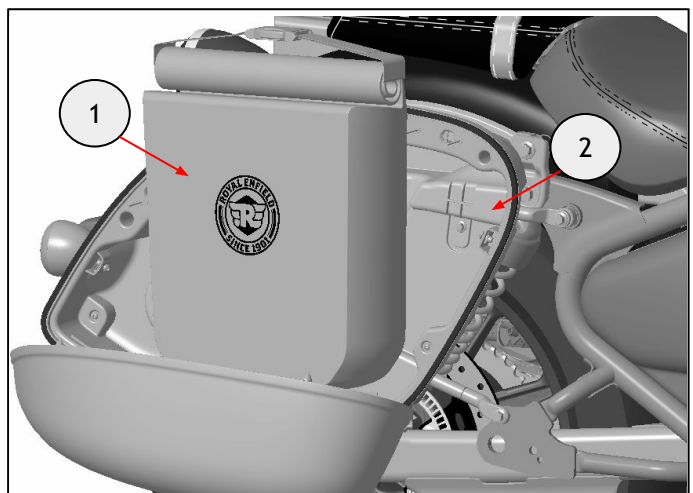

For KXA00282:

21 Remove the rear reflector assembly (1) by removing the nut (2), fixing (3) and washer (4).

Repeat step 21 on the right side.

Retain the rear reflector assembly (1), the nut (2), fixing (3) and washer (4) for if the motorcycle is to be returned to its original condition.



4mm hexagonal bit and ratchet
10mm spanner

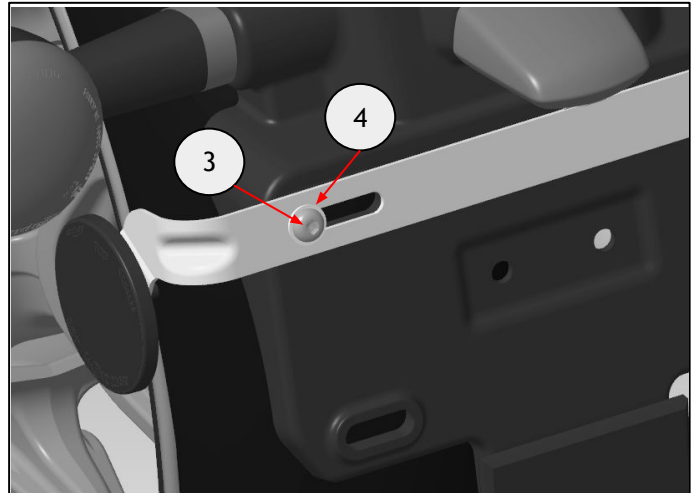
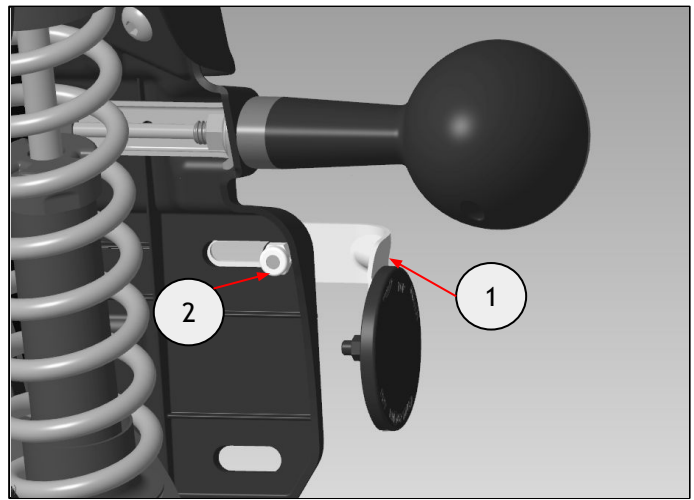

22 Remove the rear grab rails, pillion seat and rider seat as described in the Owner's Manual.

Retain the fixings for reuse.



6mm hexagonal bit and ratchet
10mm socket

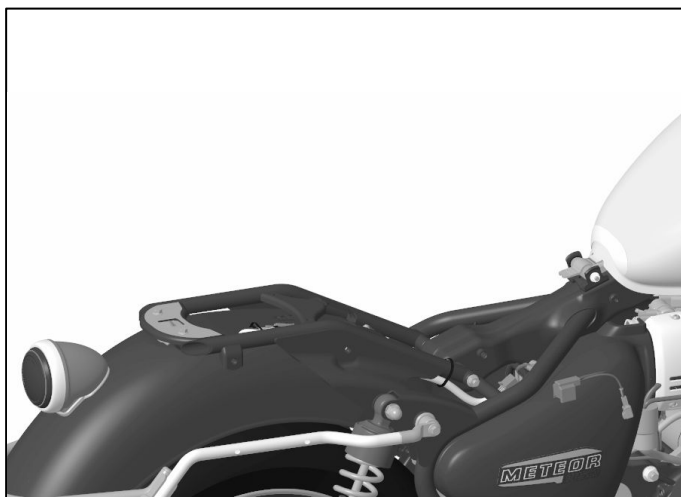

23 Loosen the rear mudguard fixings (1) and front mudguard fixings (2).

Do not fully remove.



10mm socket and ratchet
10mm spanner

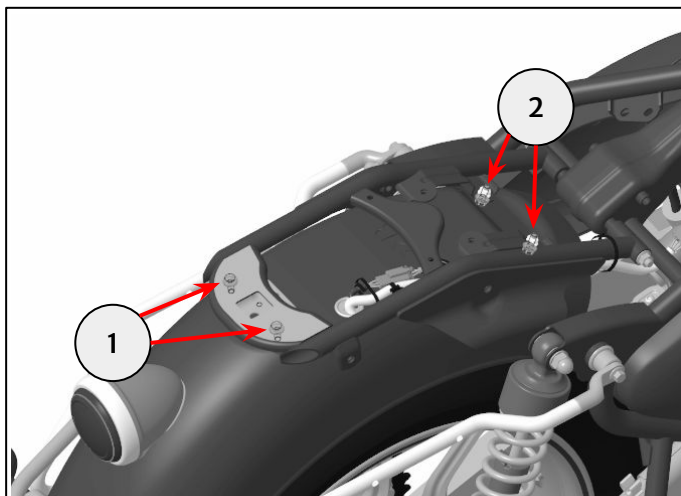

24 Loosen the upper fixing (1) and nut (2) of the right hand side rear suspension unit

Repeat on left hand side.

Do not fully remove.



17mm socket and ratchet
17mm spanner

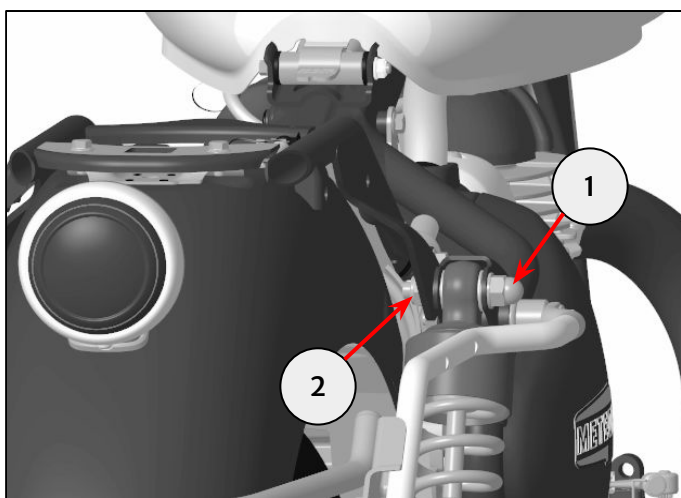

25 Remove nut (1) and remove fixing (2).

Retain nut (1) for reuse.



12mm socket and ratchet
12mm spanner

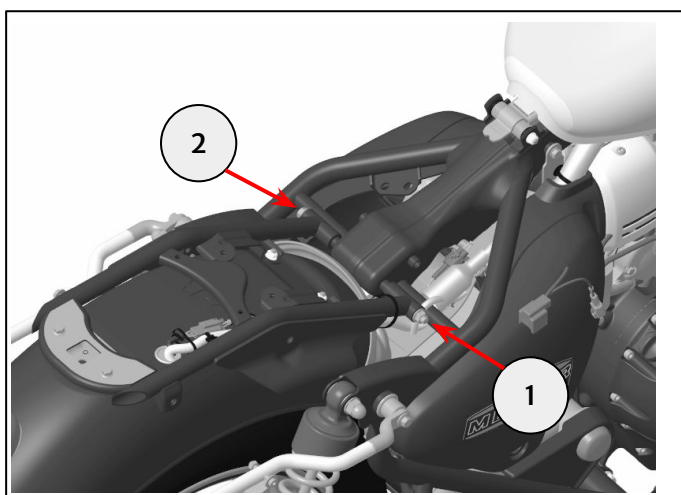

26 Pull rear of subframe to left (1) to open up gap (2). Size of gap will vary depending on amount of adjustment required.

Do not use excessive force.

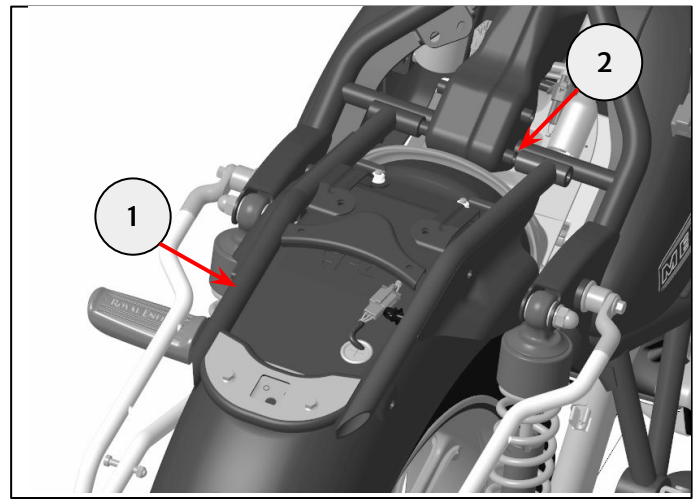

27 Fit 1 or 2 (8.4mm) washers (1) from the kit, as necessary, to fill gap in right hand side of rear subframe.

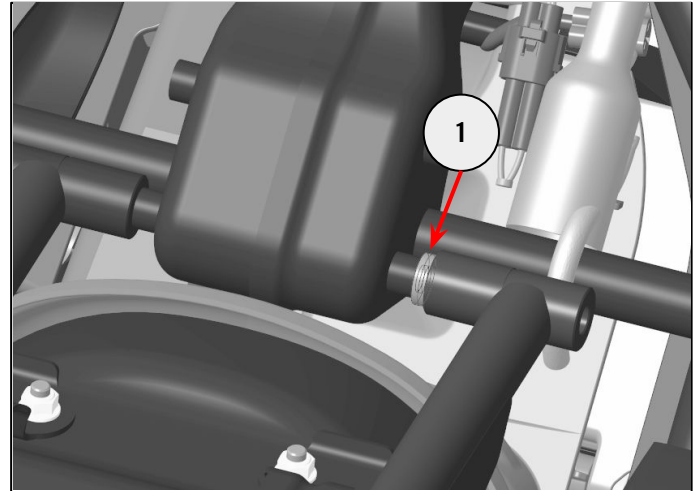

28 Fit the M8 x 205mm fixing (1) from the kit to secure subframe (2) and washers (3). Fit the M8 nut (4) removed in step 25.

Tighten fixing (1) to 25Nm.

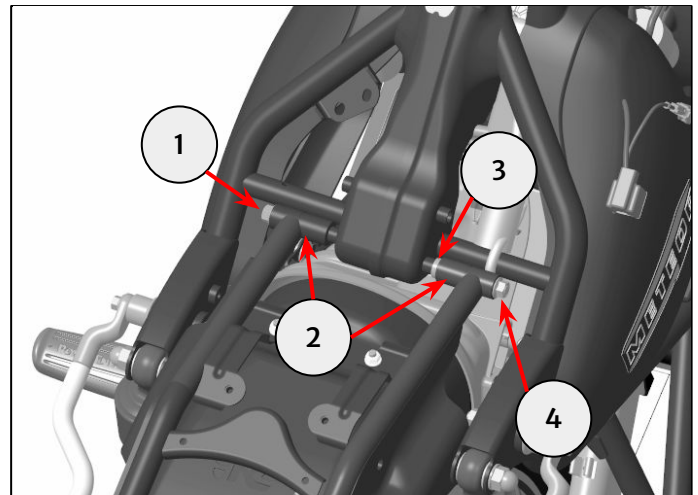

12mm socket and torque wrench
12mm spanner

29 Pull mudguard (1) to the left and hold in place. Retighten fixings (2), and then fixings (3) using nuts (4) removed in step 23.

Tighten fixings to 10Nm.

Note: Rear wheel hidden for visual purposes.



10mm socket and torque wrench
10mm spanner

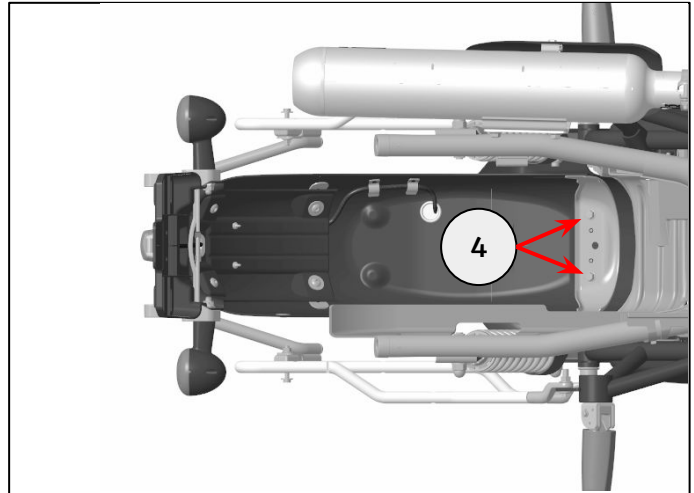
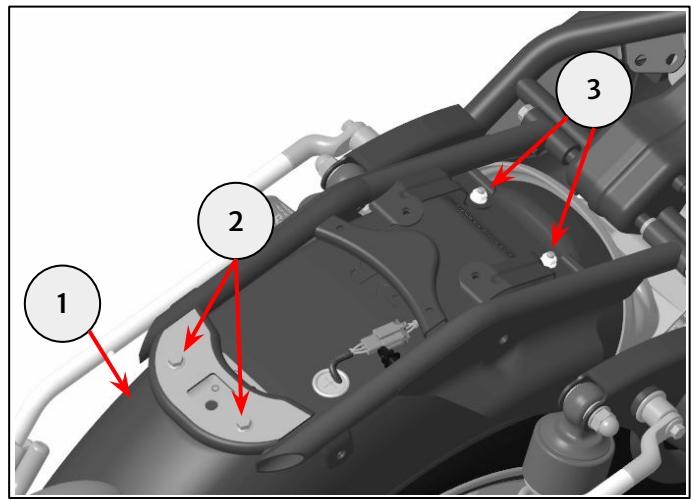

30 Tighten fixing (1) to 45NM.

Repeat on left hand side.

Observe position of mudguard. Repeat steps 23-30 as necessary until satisfactory position of mudguard is achieved.

Note: When tightening, use the open side of the spanner to avoid the spanner getting trapped.



17mm socket and torque wrench
17mm spanner

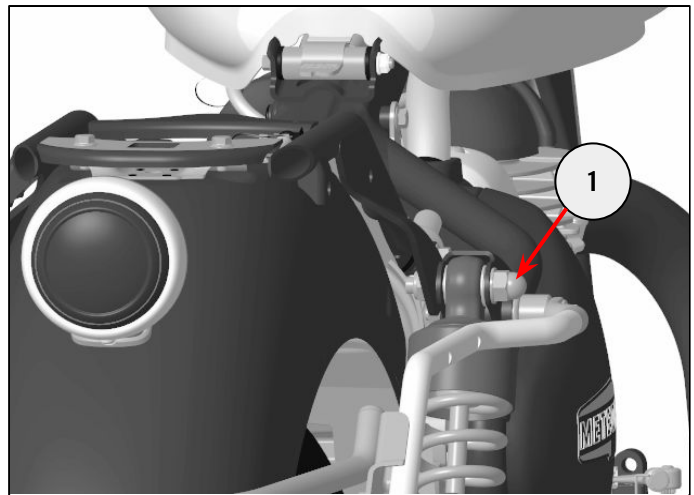

31 Reassemble the pillion seat, rider seat and grab rails as described in the Owner's Manual. Fit using the fixings removed in step 22.

Tighten Fixings (1) to **10 NM**.

Tighten Fixings (2) to **25 NM** and repeat on other side.

Return to step 14 to continue with pannier fitment.



6mm hexagonal bit and torque wrench
10mm socket and torque wrench

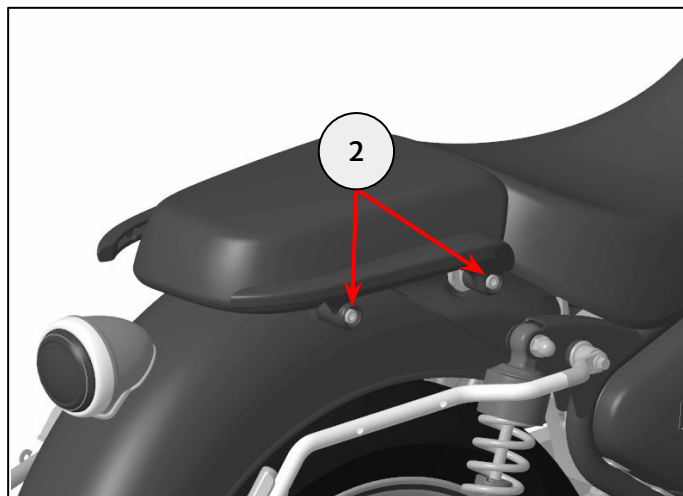
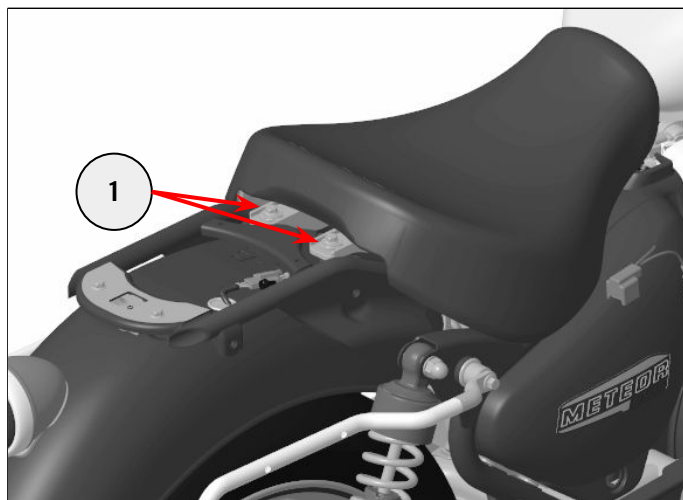

WARNING: After fitting any genuine Royal Enfield accessory always ride the motorcycle with caution and allow time to become familiar with any change in the motorcycle handling characteristics. Failure to become familiar with any change in the motorcycle handling characteristics may cause the motorcycle to become unstable and result in an accident.