



Part Number:
KXA00478

Models:
Guerrilla 450

 **WARNING:** Royal Enfield genuine accessories are designed to fit only the specific Royal Enfield motorcycle(s) that are specified above. They should not be fitted to any other type of motorcycle. Pay particular attention to the warnings and cautions contained in this instruction, failure to do so may result in an incorrect installation of the accessory which could result in an unsafe riding condition and possible accident. If in any doubt always seek help from your authorised Royal Enfield dealer.

 **WARNING:** Before starting any accessory kit installation ensure the motorcycle is supported in a stable condition. Failure to support the motorcycle correctly could lead to motorcycle damage or personal injury.

 **WARNING:** All fixings must be tightened to the torque values specified in this instruction. Failure to tighten fixings to the correct torque could result in an unsafe riding condition and possible accident

 **CAUTION:** Care should be taken when fitting any accessory kit. Incorrect handling of kit components or the use of incorrect tools could lead to component or motorcycle damage.

NOTE: The content of this instruction is subject to change at any time without notice or liability. Royal Enfield reserves the right to revise the information presented at any time.

Parts Supplied: KXA00478

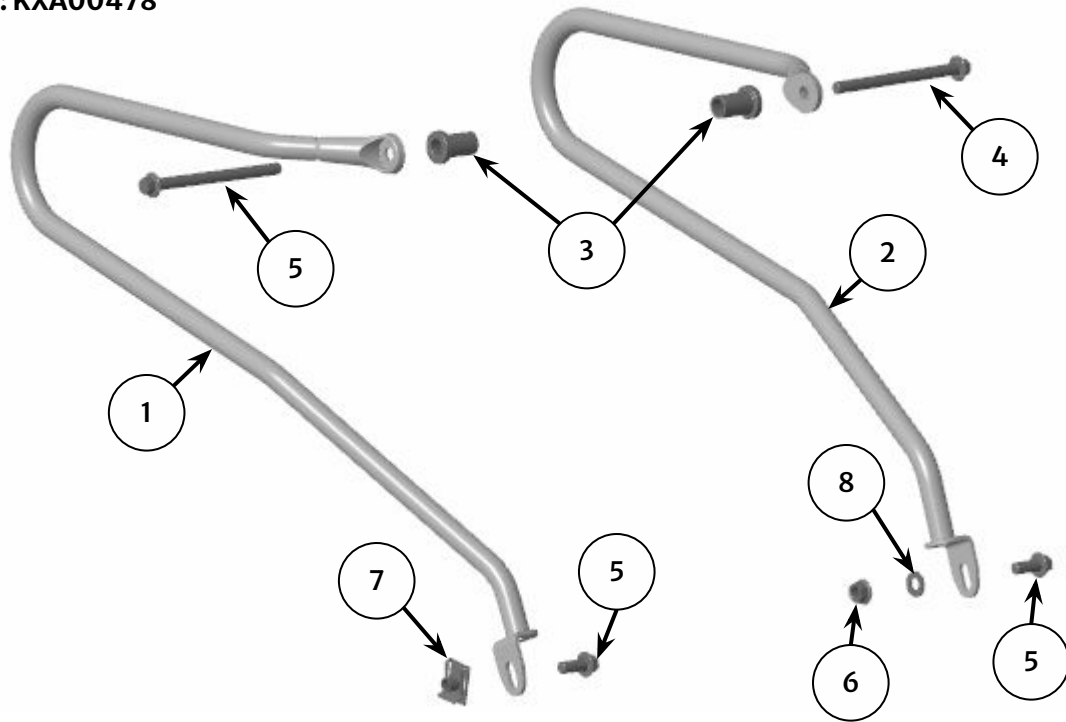

Item	Description	Qty
1	Pannier rail, right hand	1
2	Pannier rail, left hand	1
3	Spacer boss	2
4	Fixing, M8 x 105mm	2
5	Fixing, M8 x 20mm	2
6	Nut, M8	1
7	Clip nut, M8	1
8	Washer	1

1 Remove the seat as described in the Owner's Manual.

Remove the front fixings securing the right hand grab handle (1).

Retain the nuts (4) for reuse. Retain the grab handle (1), fixings (2) and washers (3) for reuse if the motorcycle is to be returned to its original condition.

Repeat for the left hand grab handle.



6mm hexagonal bit and ratchet
12mm spanner

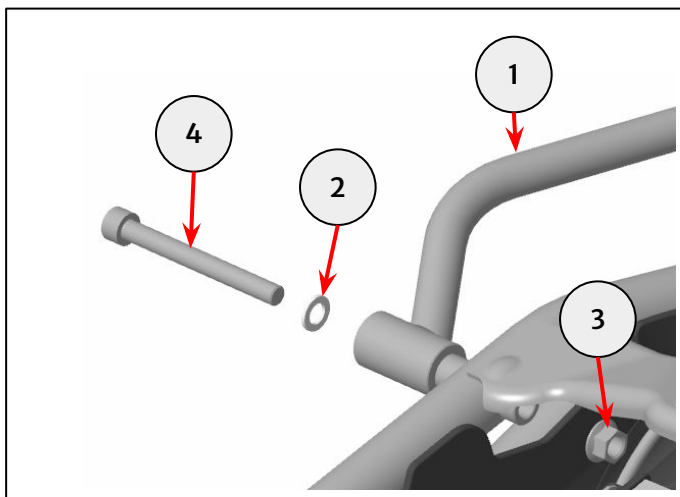

Right hand side

2 Collect the right hand pannier rail (1) and spacer boss (2) from the kit and assemble to the front grab rail mount on the frame using an M8 x 105mm fixing (3) from the kit and an M8 nut (4) removed in step 1.

Do not fully tighten the fixing at this stage.



10mm socket and ratchet
12mm spanner

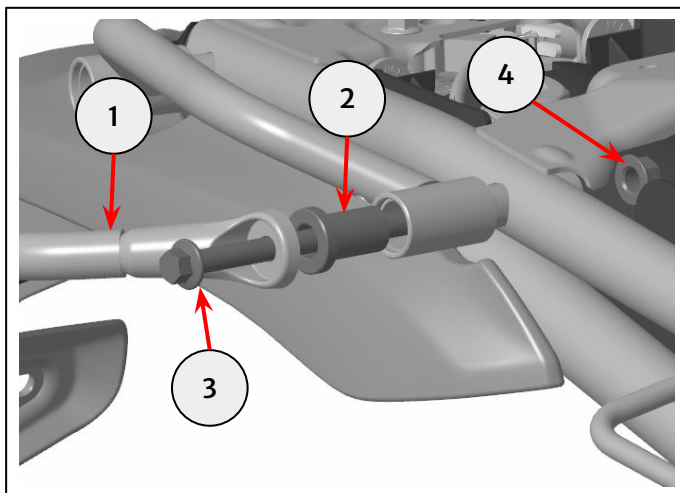

3 Insert the clip nut (1) to the bracket on the frame, as shown. Fit the pannier rail lower mount (2) using an M8 x 20mm fixing (3) from the kit.

Tighten both upper and lower fixings to **30 Nm**.

Note: Tighten upper fixing to **45 Nm** if fitting in conjunction with the GMA Top Box Rack.



10 mm socket and torque wrench

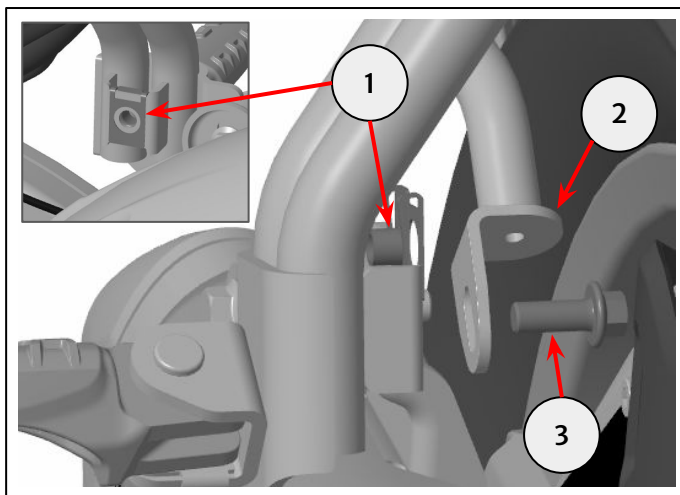

Left hand side

4 Collect the left hand pannier rail (1) and spacer boss (2) from the kit and assemble to the front grab rail mount on the frame using an M8 x 105mm fixing (3) from the kit and an M8 nut (4) removed in step 1.

Do not fully tighten the fixing at this stage.



10mm socket and ratchet
12mm spanner

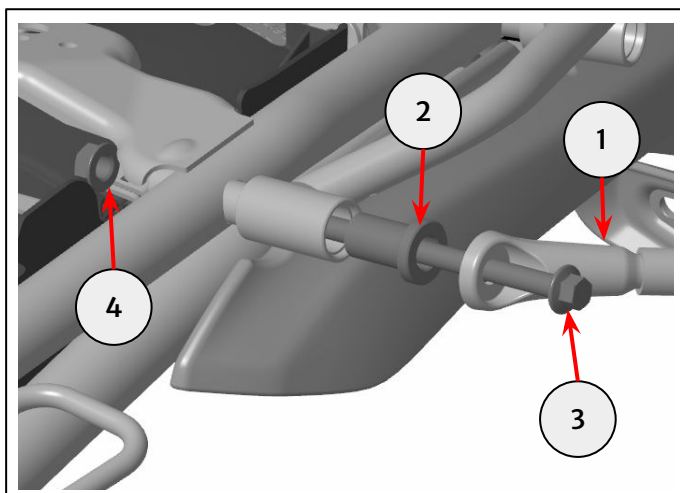

5 Collect an M8 x 20mm fixing (1) nut (2) and a washer (3) from the kit to secure the pannier rail lower mount (4) to the pillion footrest mount (5), as shown.

Tighten both upper and lower fixings to **30 Nm**.

Note: Tighten upper fixing to **45 Nm** if fitting in conjunction with the GMA Top Box Rack.

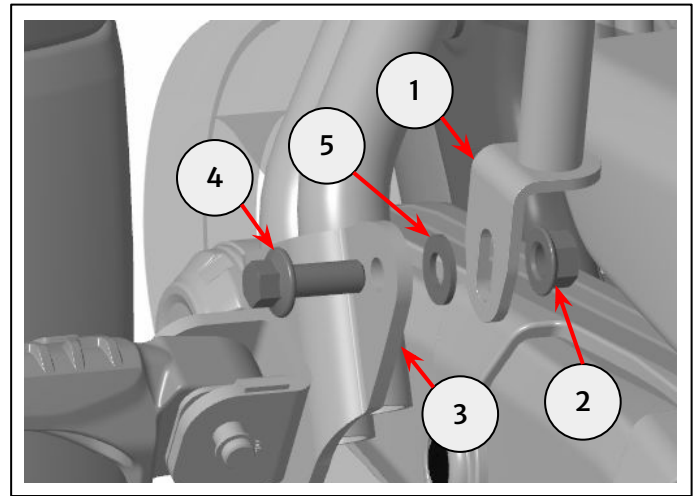
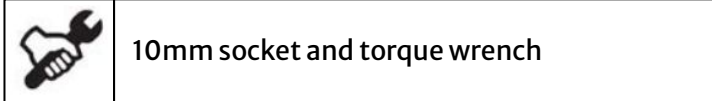

6 Refit the seat as described in the Owner's Manual.



WARNING: After fitting any genuine Royal Enfield accessory always ride the motorcycle with caution and allow time to become familiar with any change in the motorcycle handling characteristics. Failure to become familiar with any change in the motorcycle handling characteristics may cause the motorcycle to become unstable and result in an accident.