

Part Number:
1990445

Models :
Continental GT 650 (2018 onwards)
Interceptor INT 650 (2018 onwards)
INT 650 (US Only) (2018 onwards)

WARNING: Royal Enfield genuine accessories are designed to fit only the specific Royal Enfield motorcycle(s) that are specified above. They should not be fitted to any other type of motorcycle. Pay particular attention to the warnings and cautions contained in this instruction, failure to do so may result in an incorrect installation of the accessory which could result in an unsafe riding condition and possible accident. If in any doubt always seek the help from your authorised Royal Enfield dealer.

WARNING: Before starting any accessory kit installation ensure the motorcycle is supported in a stable condition. Failure to support the motorcycle correctly could lead to motorcycle damage or personal injury.

WARNING: All fixings must be tightened to the torque values specified in this instruction. Failure to tighten fixings to the correct torque could result in an unsafe riding condition and possible accident.

CAUTION: Care should be taken when fitting any accessory kit. Incorrect handling kit components or the use of incorrect tools could lead to component or motorcycle damage.

NOTE: The content of this instruction is subject to change at any time without notice or liability. Royal Enfield reserves the right to revise the information presented at any time.

NOTE: The rear suspension mount finisher kit must not be fitted if a lift handle, or accessory pannier mounts are fitted to the motorcycle.

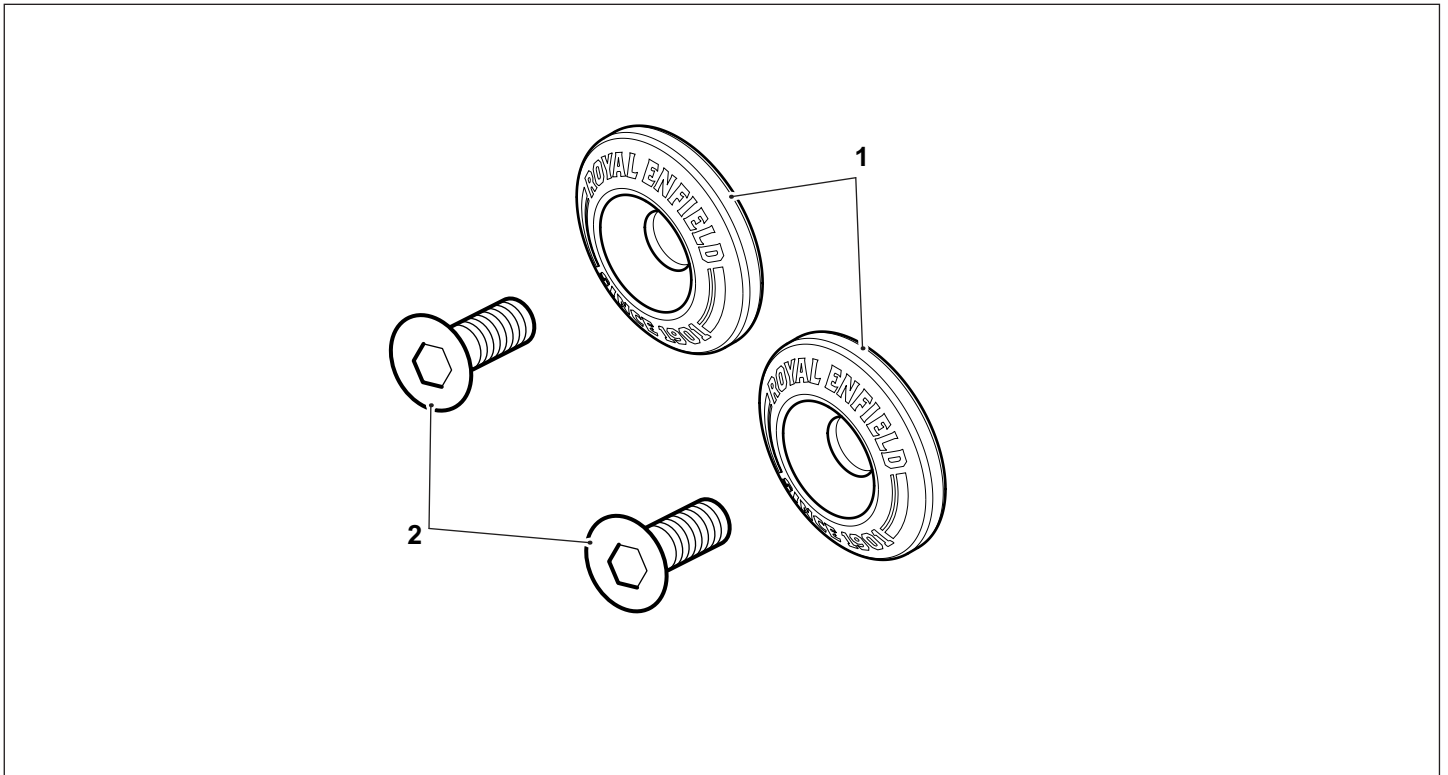

Item	Description	Qty
1	Finisher	2
2	Fixing	2

Models with a Lift Handle fitted

1 Remove the rear suspension top fixing (1) and washer (2) retaining the front of the lift handle (3) to the rear suspension top mounting (4) on the left hand side of the motorcycle.

Retain the washer for reuse. Discard the fixing.

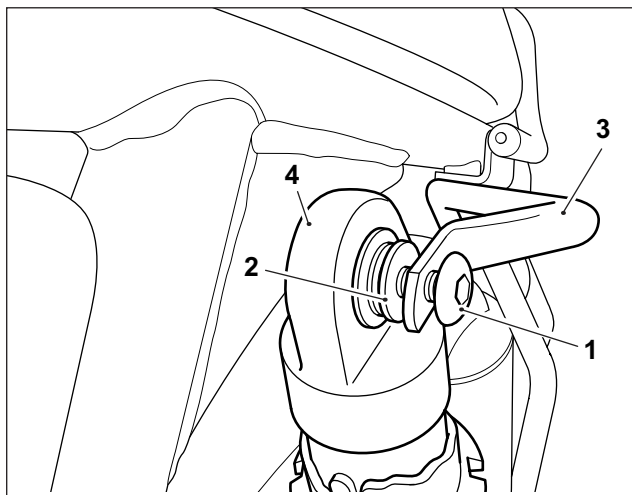

6mm Allen socket with ratchet

2 Remove the front grab rail fixing (1) securing the lift handle (2) to the motorcycle frame (3). Remove the lift handle from the motorcycle. Retain the lift handle for reuse if the accessory rear suspension finishers are to be removed.

Retain the grab rail fixing for reuse.

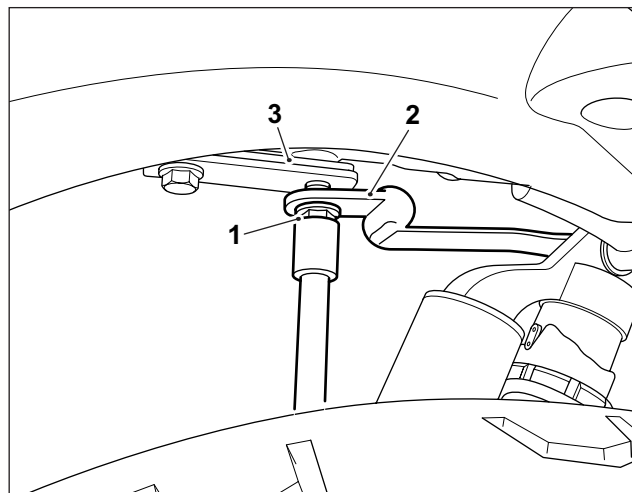

12mm Bi-hexagonal socket with ratchet

3 Refit the front grab rail fixing (1). Tighten the fixing (1) to **25 Nm**.



12mm Bi-hexagonal socket with torque wrench

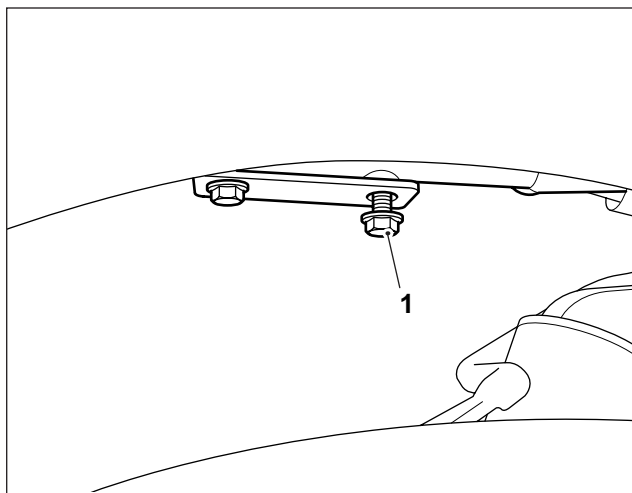

Models without a Lift Handle fitted

4 Remove the rear suspension top fixing (1) and washer (2) on the left hand side of the motorcycle.

Retain the washer for reuse. Discard the fixing.

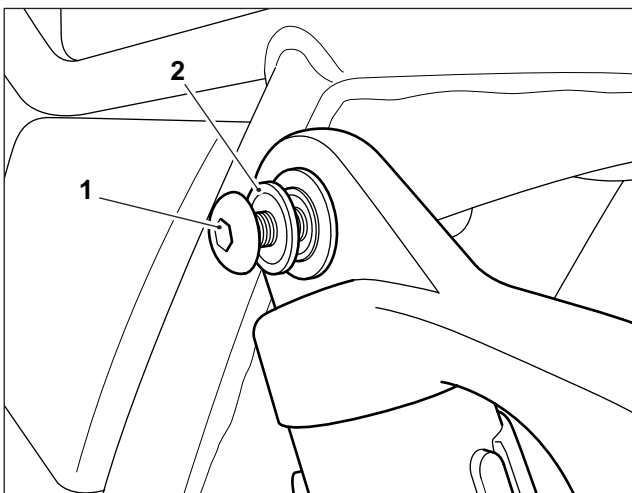

6mm Allen socket with ratchet

All Models

5 Fit one of the finishers (1) from the kit on to the left hand rear suspension top mounting (2) with the original washer (3). Fit a fixing (4) from the kit to secure the finisher to the suspension mount.

Tighten the fixing (4) to **22 Nm**.

	6mm Allen socket with torque wrench
---	-------------------------------------

6 Repeat steps 4 and 5 for the right hand side of the motorcycle.

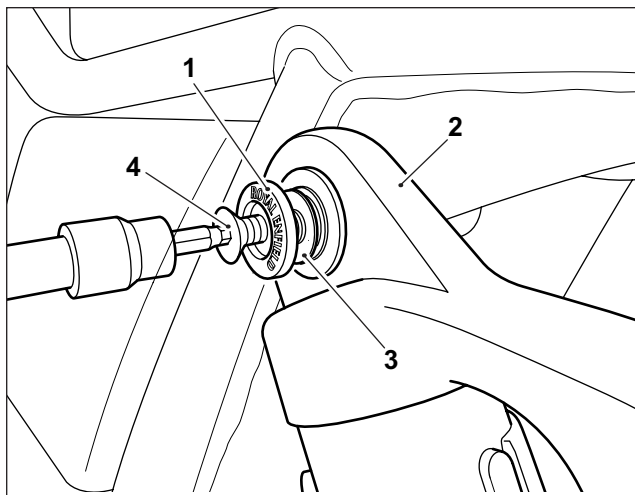

⚠ WARNING: After fitting any genuine Royal Enfield accessory always ride the motorcycle with caution and allow time to become familiar with any change in the motorcycle handling characteristics. Failure to become familiar with any change in the motorcycle handling characteristics may cause the motorcycle to become unstable and result in an accident.