

Part Number:
KXA00064, KXA00075, KXA00156 and
KXA00157

Models:
BSVI Meteor, Classic & Bullet
With VIN starting ME3J3A5FAL3

WARNING: Royal Enfield genuine accessories are designed to fit only the specific Royal Enfield motorcycle(s) that are specified above. They should not be fitted to any other type of motorcycle. Pay particular attention to the warnings and cautions contained in this instruction, failure to do so may result in an incorrect installation of the accessory which could result in an unsafe riding condition and possible accident. If in any doubt always seek help from your authorised Royal Enfield dealer.

WARNING: Before starting any accessory kit installation ensure the motorcycle is supported in a stable condition. Failure to support the motorcycle correctly could lead to motorcycle damage or personal injury.

WARNING: All fixings must be tightened to the torque values specified in this instruction. Failure to tighten fixings to the correct torque could result in an unsafe riding condition and possible accident.

CAUTION: Care should be taken when fitting any accessory kit. Incorrect handling of kit components or the use of incorrect tools could lead to component or motorcycle damage.

NOTE: The content of this instruction is subject to change at any time without notice or liability. Royal Enfield reserves the right to revise the information presented at any time.

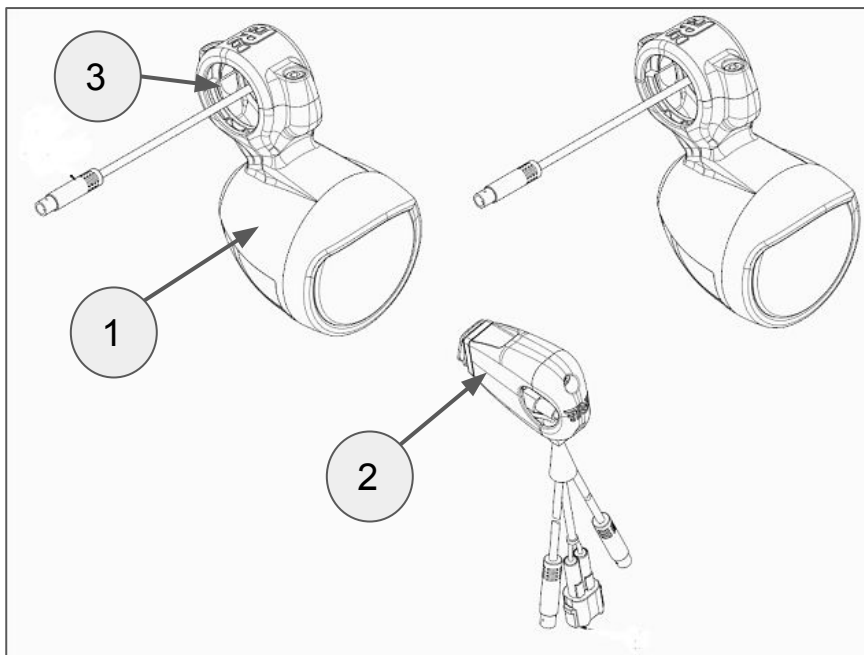

Item	Description	Qty
1	LED FOG LIGHT ASSY	2
2	FOG LAMP SWITCH	1
3	RUBBER SLEEVE	2

1 Remove the clamp from the light housing by removing fastener (1) both front and rear fastener.



(1) 4mm Hex bit socket and wrench

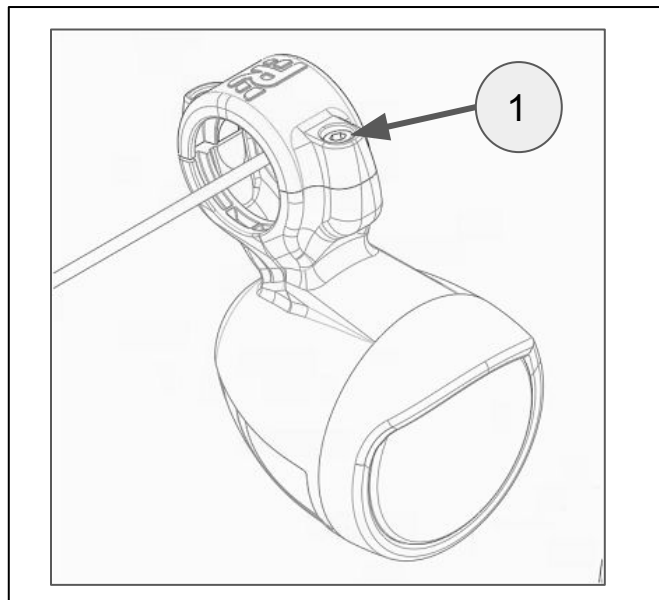

2 Place 3mm thick rubber sleeve (2) on light housing and insert the light harness through hole on the rubber sleeve. Keep the sleeve as shown on image.

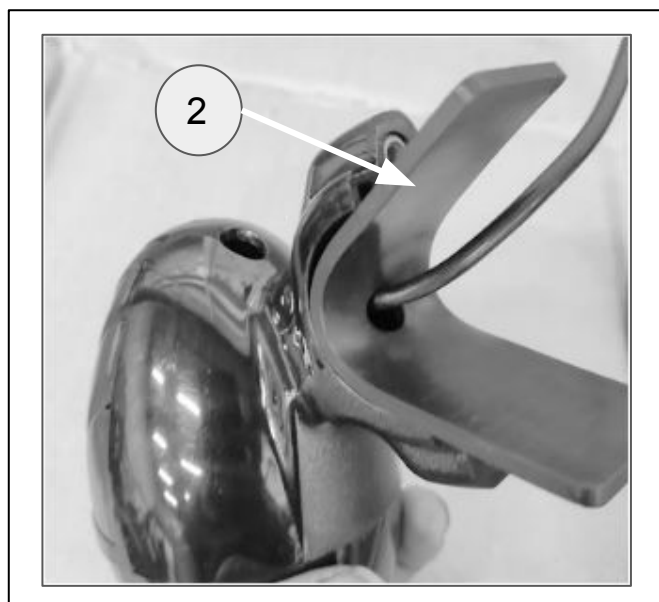

3 Insert the light connector (3) through the hole on the engine guard tube and pass cable through the tube to the open end of the engine guard. To removing and refitting the engine guard Ref:KXL00074 engine guard instruction.

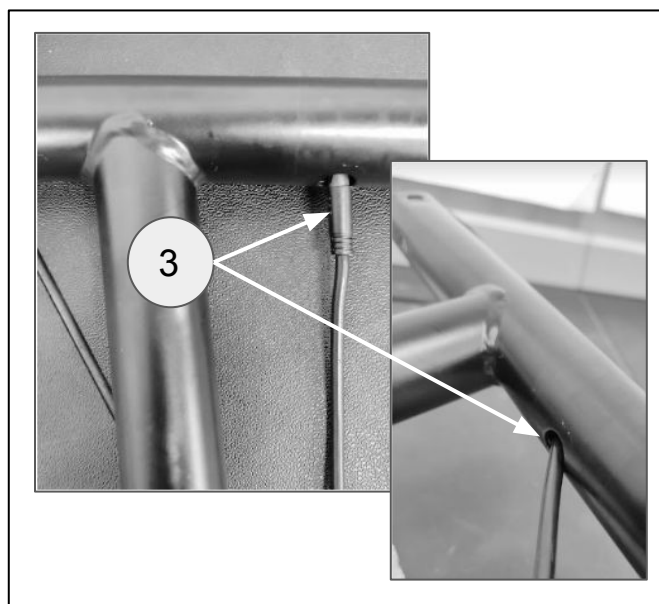

4 Position the Light housing (4) on engine guard RH side with rubber sleeve and align the housing central to the hole in the engine guard tube. Tighten the clamp (5) with housing, using the fastener (1), only hand tight at this stage. Ensure the rubber sleeve (6) is seated properly as shown in the image. Repeat the same on the LH side.

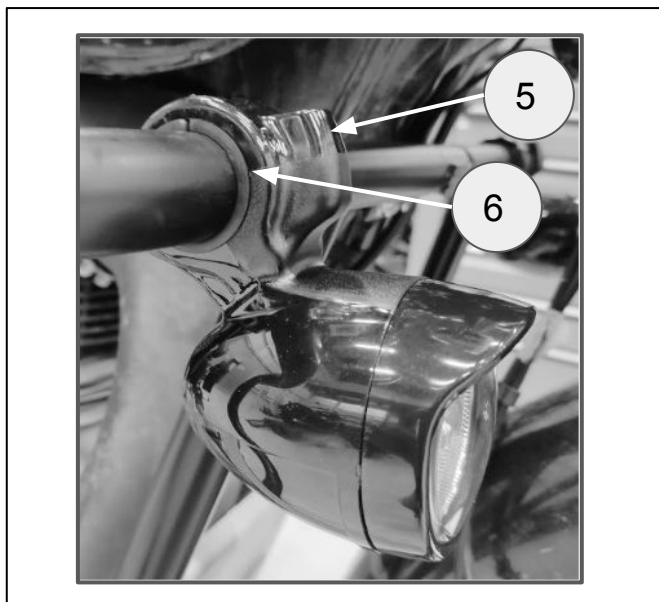
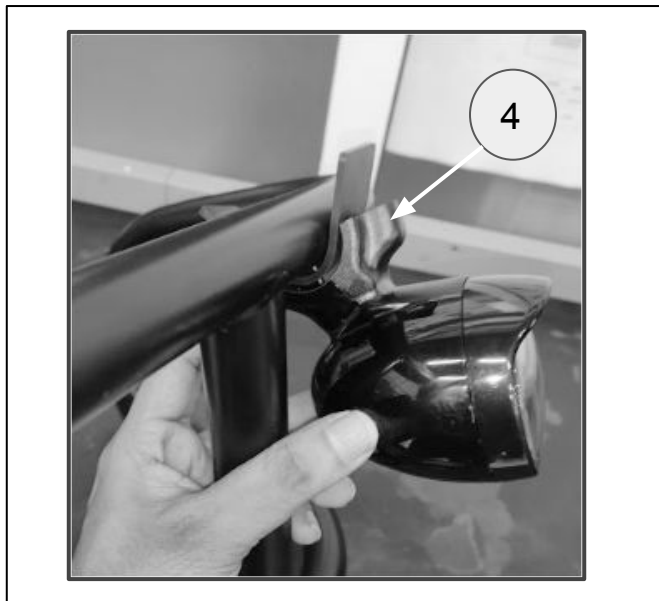
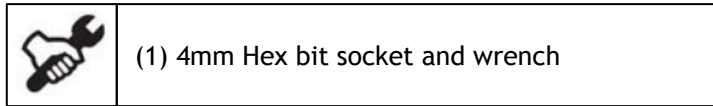

5 Route the fog light harnesses (7) as shown in the image inside the engine guard bracket, ensuring that the cables are not trapped by any components. Follow the engine guard instructions KXL00074 to tighten the fixings (8) as specified.

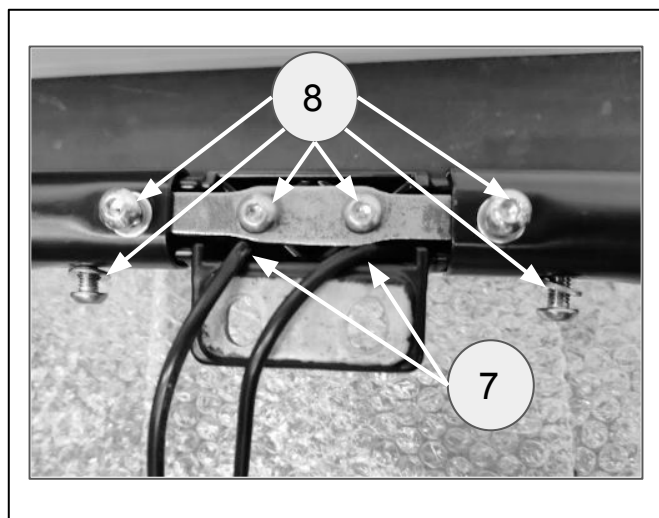

6 After mounting the lamp over the engine guard follow the engine guard fitting instruction KXL00074 to mount the engine guard on the vehicle. After mounting the engine guard, ensure the lamp is facing horizontally, with the lens perpendicular to the ground when the vehicle is facing the forward direction. Torque the fasteners (1) 2 Nos to **4Nm**.



(1) 4mm Hex bit socket and torque wrench

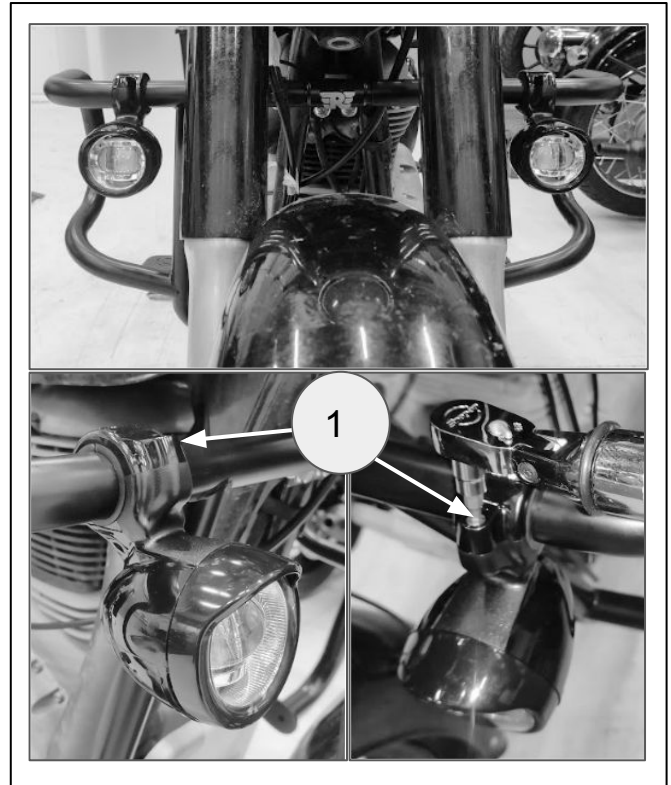

7 Assemble the switch housing (9) over the handlebar LH side by loosening the fastener (10) and removing switch clamp (11). orientate the switch perceptually upright to the rider on the handlebar and close the switch (9) with clamp (11) . Tight the fastener (10) 2 Nos until maintain gap 2 to 2.5mm between switch and clamp top and bottom.

Not need to disturb or remove any other switch fitted on the handlebar to fit this switch.



(10) 2.5mm Hex bit socket and torque wrench



8 Ensure the ignition is off and open the RH side cover on the vehicle to remove negative terminal from battery to avoid electrical damage. Remove the headlamp from head lamp assy, following the relevant procedure below.

BSVI Classic & Bullet: Remove headlamp screw 2Nos (12) and remove headlamp from nacelle assy by removing headlamp connector, retain screw (12) for reuse.



(12) PZ2 bit socket and wrench



BSVI Meteor : Remove headlamp screw 2Nos (13) and remove headlamp from headlamp assy by removing headlamp connector. retain screw (13) for reuse.

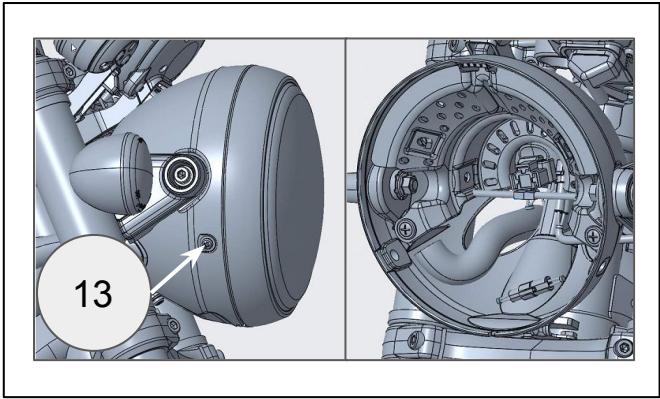
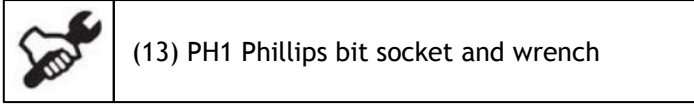

9 Route RH side Fog light harness (7) from engine guard to inside the headlamp assy as shown in images below. Route the harness between the header and RH side fork, then take through the RH side opening on rear of head lamp assy. Repeat for the LH side Fog light harness, routing the harness through the RH side opening on rear of head lamp assy.

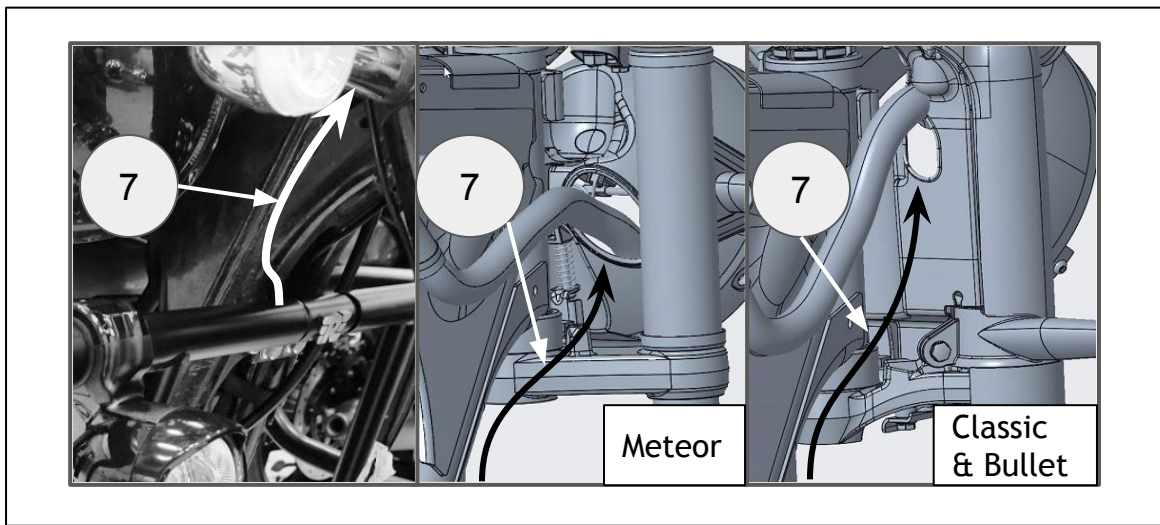

10 Route the Fog light switch harness (14) inside the headlamp assy, take through the LH side opening on rear of head lamp assy. Use the two wire strap available on handlebar to tie the hanging switch harness with handlebar.

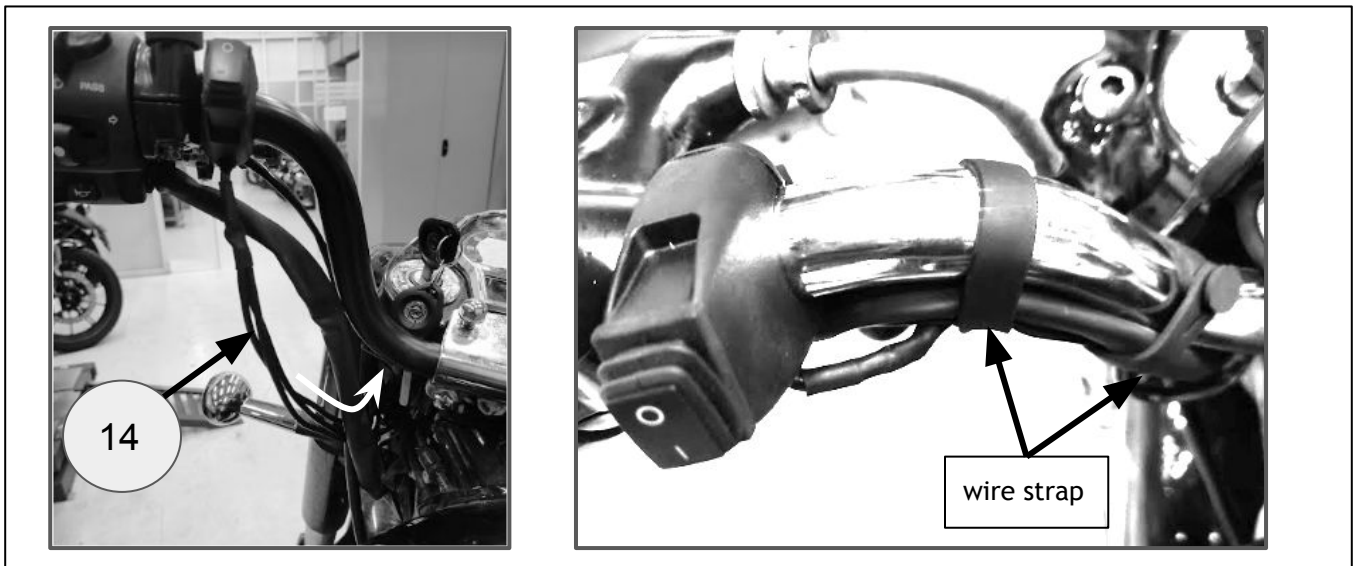

11 Connect both LH and RH fog lamp connector (15) with switch connector (16) as shown on image.

Use the wire strap available on kit to tie the fog lamp harness which hanging on RH side with main wire harness on RH side. ensure fog lamp harness not stuck with headstock stopper by rotating the handlebar fully.

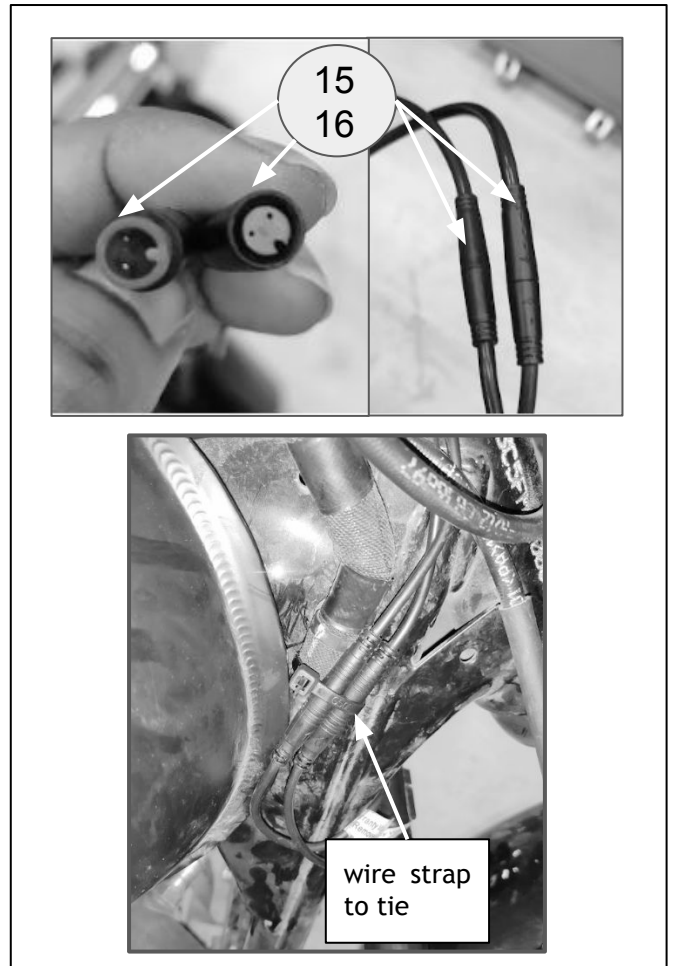

12 Assemble the switch connector (19) with the accessory connector RED (18) which can be found inside the headlamp assy.

Note: The accessory connector RED (18) may be fitted with a cap for protection, remove the cap and connect to the switch connector.

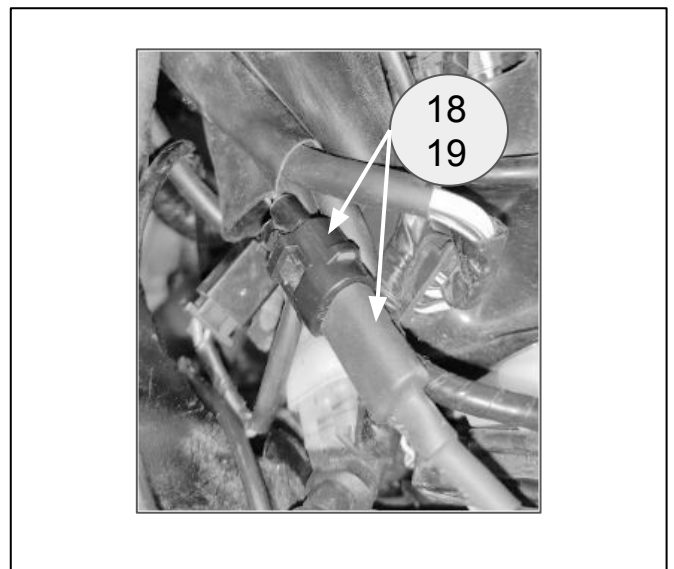

13 Any excess fog light harness length should be retained inside the headlamp assy. Reconnect the headlamp connector to the vehicle.
Assemble headlamp with head lamp assy, following the required headlamp mounting procedure below:

BSVI Classic & Bullet: Mount the headlamp to nacelle headlamp assy and reuse screw (12) 2Nos, torque the screw (12) to **4Nm**.

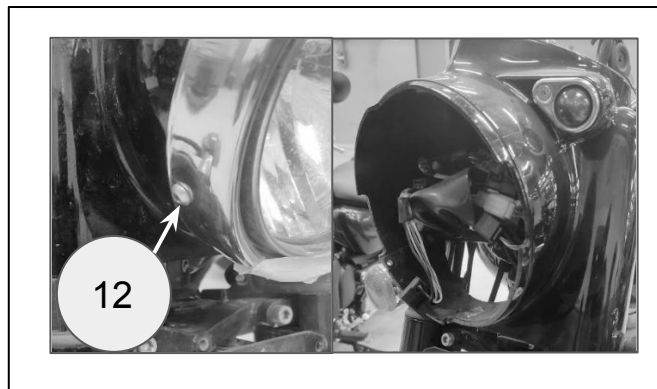
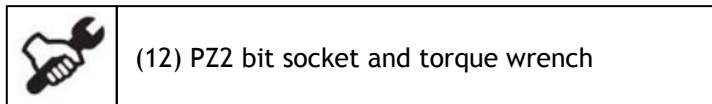

BSVI Meteor : Mount the headlamp to headlamp assy and reuse screw (13) 2 Nos, torque the screw (13) to **5Nm**.

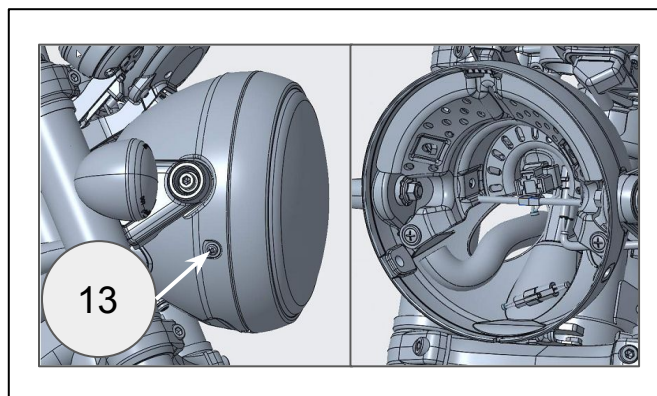
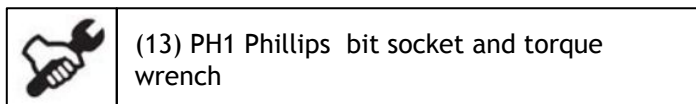

14 connect the negative terminal to battery negative and Close the side cover. Turn ON the fog lamp switch to ensure the lamp is operating correctly.

Note: Fog lamps will operate only when the engine is running.

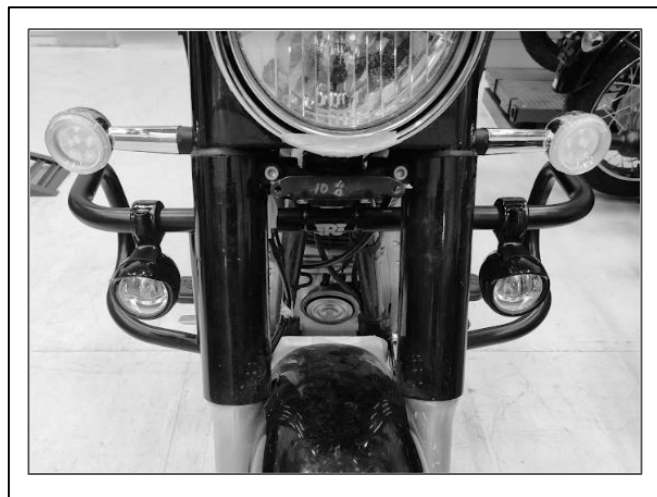

WARNING: After fitting any genuine Royal Enfield accessory always ride the motorcycle with caution and allow time to become familiar with any change in the motorcycle handling characteristics. Failure to become familiar with any change in the motorcycle handling characteristics may cause the motorcycle to become unstable and result in an accident.