

**Part Number:**

1990216, 1990245

**Models:**

Himalayan

**WARNING:** Royal Enfield genuine accessories are designed to fit only the specific Royal Enfield motorcycle(s) that are specified above. They should not be fitted to any other type of motorcycle. Pay particular attention to the warnings and cautions contained in this instruction, failure to do so may result in an incorrect installation of the accessory which could result in an unsafe riding condition and possible accident. If in any doubt always seek the help from your authorised Royal Enfield dealer.

**WARNING:** Before starting any accessory kit installation ensure the motorcycle is supported in a stable condition. Failure to support the motorcycle correctly could lead to motorcycle damage or personal injury.

**WARNING:** All fixings must be tightened to the torque values specified in this instruction. Failure to tighten fixings to the correct torque could result in an unsafe riding condition and possible accident.

**CAUTION:** Care should be taken when fitting any accessory kit. Incorrect handling kit components or the use of incorrect tools could lead to component or motorcycle damage.

**NOTE:** The content of this instruction is subject to change at any time without notice or liability. Royal Enfield reserves the right to revise the information presented at any time.

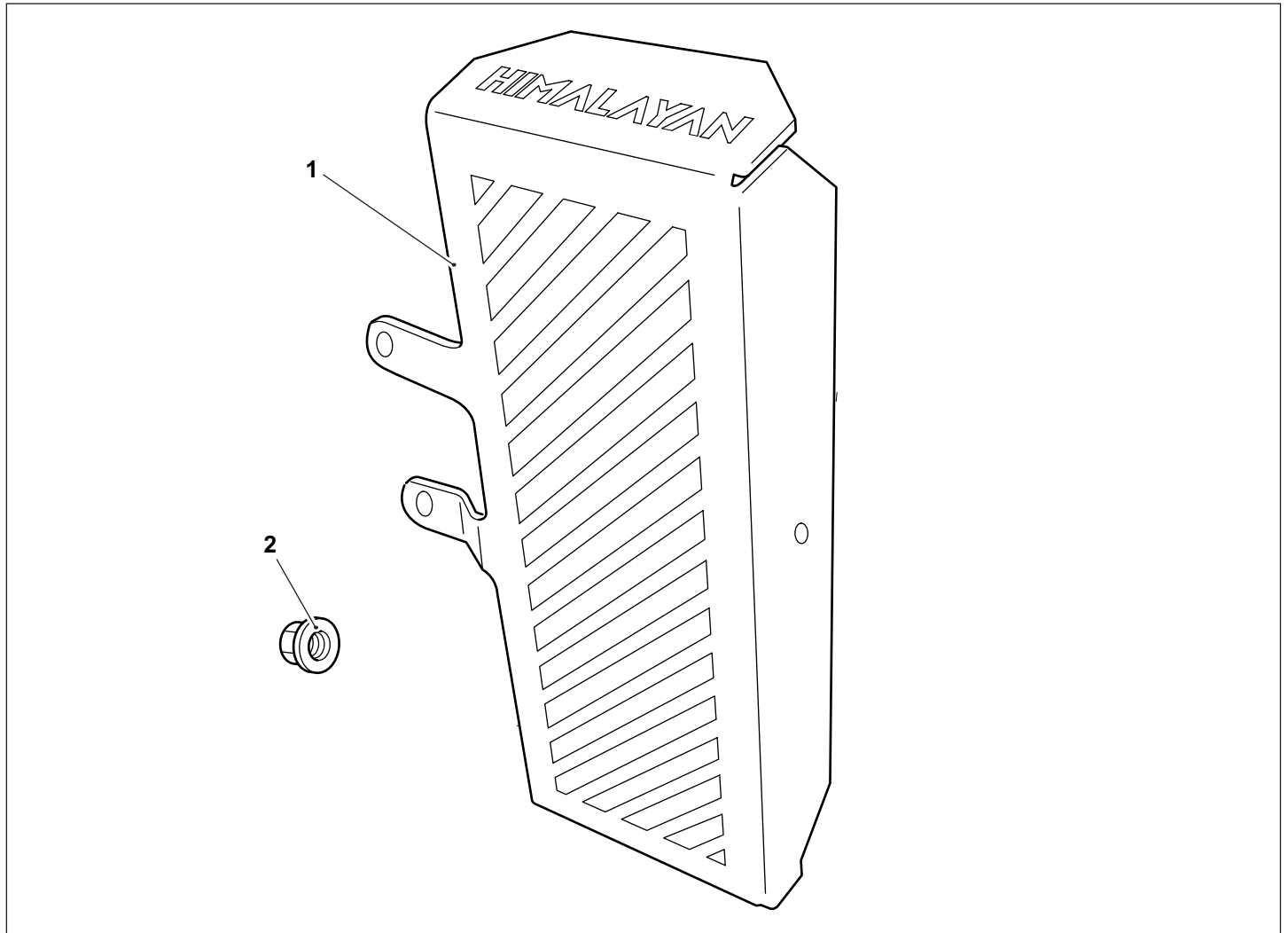



Item	Description	Qty
1	Oil cooler guard	1
2	Flanged lock nut	1

**WARNING:** If the engine has recently been running the engine and exhaust system will be hot. Before working near to the engine or exhaust system always allow time for the engine and exhaust system to cool. Touching any part of a hot engine or exhaust system will cause burn injuries.

**CAUTION:** When the original oil cooler guard is removed the oil cooler is not secured to the motorcycle. Ensure the oil cooler hoses are not damaged or strained when fitting the accessory oil cooler guard.

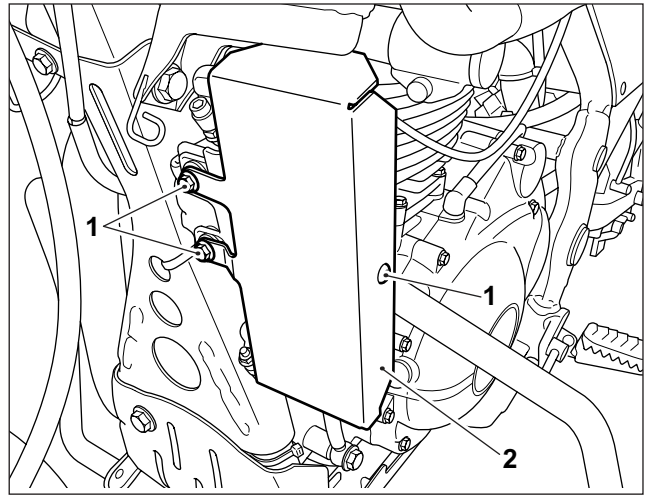
**1** Remove the three fixings (1) securing the original oil cooler guard (2) and remove the oil cooler guard from the motorcycle. Retain the fixings for re-use. Retain the original oil cooler guard for re-use if returning the motorcycle to its original condition.



	4mm Allen socket with ratchet 10mm Bi-hexagonal socket with ratchet
---	--

**2** Align the accessory oil cooler guard (1) with the fixing positions on the oil cooler mounting bracket (2) and refit the original fixings (3), as shown. Do not fully tighten the fixings at this stage.

**NOTE:** Check that there is clearance between the oil cooler guard and the front subframe fabrication, as arrowed. If there **IS NO** clearance between the oil cooler guard and the front subframe continue from *Step 3*. If there **IS** clearance between the oil cooler guard and the front subframe, continue from *Step 9*.

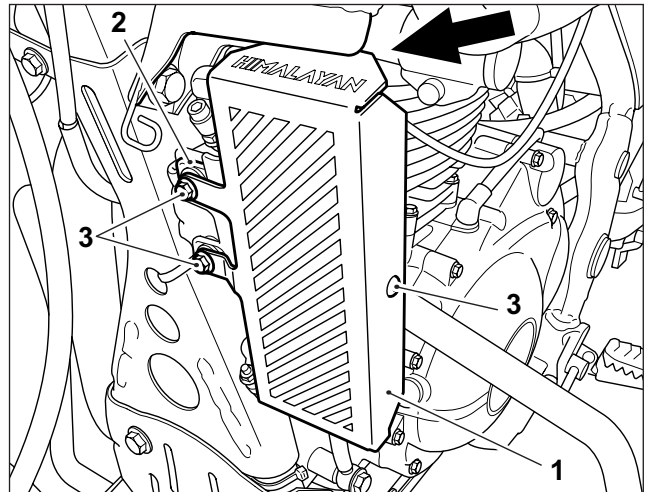

**3** Remove the oil cooler guard and place to one side with the fixings. Taking care not to strain the oil cooler pipes, carefully ease the oil cooler (1) forward slightly off its mounting bracket (2) to gain access to the mounting bracket fixing (3) on the left hand side of the motorcycle.

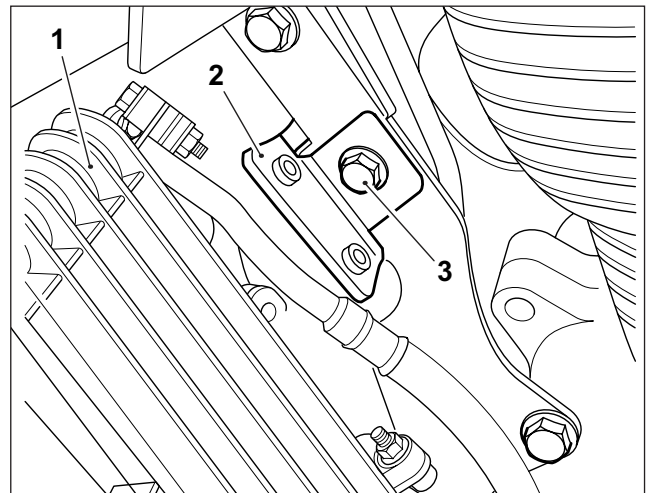

**4** From the right hand side of the motorcycle, remove the nut (1) securing the clutch cable retaining clip (2). Retain the nut for reuse. Remove the lock nut (3) and discard.

	14mm spanner 13mm Bi-hexagonal socket with ratchet 17mm spanner
---	---

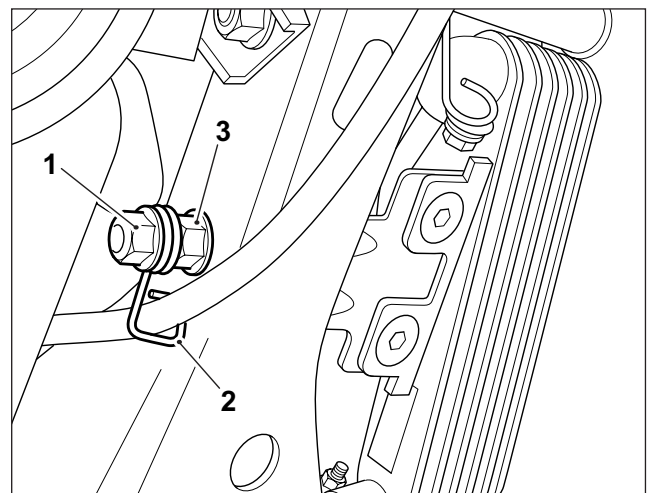

**5** Rotate the oil cooler mounting bracket (1) slightly in an anti-clockwise direction as shown, ensuring the oil cooler (2) can still be located correctly on the mounting bracket. This will provide the required clearance between the oil cooler guard and the front subframe.

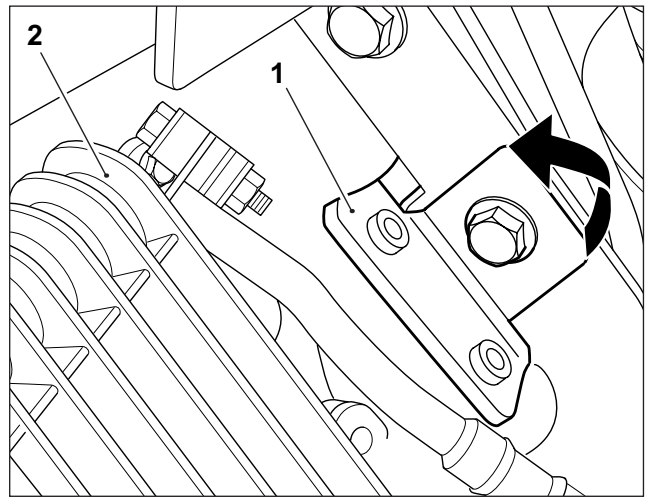

**6** Using the new lock nut (1) from the kit secure the oil cooler mounting bracket (2) in it's new position. Tighten the fixing (3) to **50Nm**.

	13mm Bi-hexagonal socket with torque wrench 17mm spanner
--	---

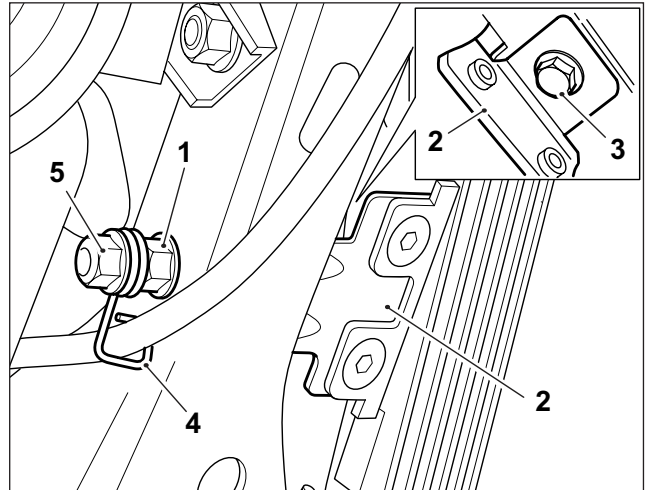

**7** Refit the clutch cable retaining clip (4) and secure with the original nut (5). Tighten the nut to **25Nm**.

	14mm Bi-hexagonal socket with torque wrench
--	---

**8** Refit the accessory oil cooler guard, as described in step 2.

**9** Refit the original fixing (1) on the right hand side of the oil cooler guard (2) , as shown. Tighten the fixing to **10 Nm**.

	4mm Allen socket with torque wrench
--	-------------------------------------

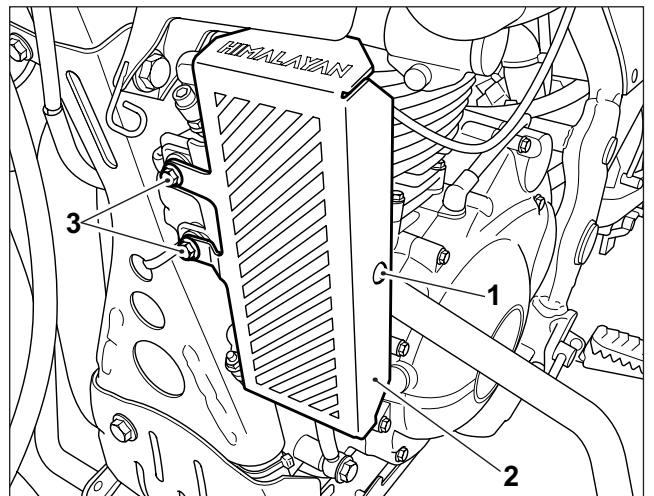

**10** Tighten the fixings (3) securing the oil cooler guard and oil cooler to the mounting bracket to **12 Nm**.

	10mm Bi-hexagonal socket with torque wrench
--	---

**⚠ WARNING:** After fitting any genuine Royal Enfield accessory always ride the motorcycle with caution and allow time to become familiar with any change in the motorcycle handling characteristics. Failure to become familiar with any change in the motorcycle handling characteristics may cause the motorcycle to become unstable and result in an accident.