

**Part Number:**  
1990524

**Models:**  
Interceptor Bear 650 (all years)

**WARNING:** Royal Enfield genuine accessories are designed to fit only the specific Royal Enfield motorcycle(s) that are specified above. They should not be fitted to any other type of motorcycle. Pay particular attention to the warnings and cautions contained in this instruction, failure to do so may result in an incorrect installation of the accessory which could result in an unsafe riding condition and possible accident. If in any doubt always seek help from your authorised Royal Enfield dealer.

**WARNING:** Before starting any accessory kit installation ensure the motorcycle is supported in a stable condition. Failure to support the motorcycle correctly could lead to motorcycle damage or personal injury.

**WARNING:** All fixings must be tightened to the torque values specified in this instruction. Failure to tighten fixings to the correct torque could result in an unsafe riding condition and possible accident

**CAUTION:** Care should be taken when fitting any accessory kit. Incorrect handling of kit components or the use of incorrect tools could lead to component or motorcycle damage.

**NOTE:** The content of this instruction is subject to change at any time without notice or liability. Royal Enfield reserves the right to revise the information presented at any time.

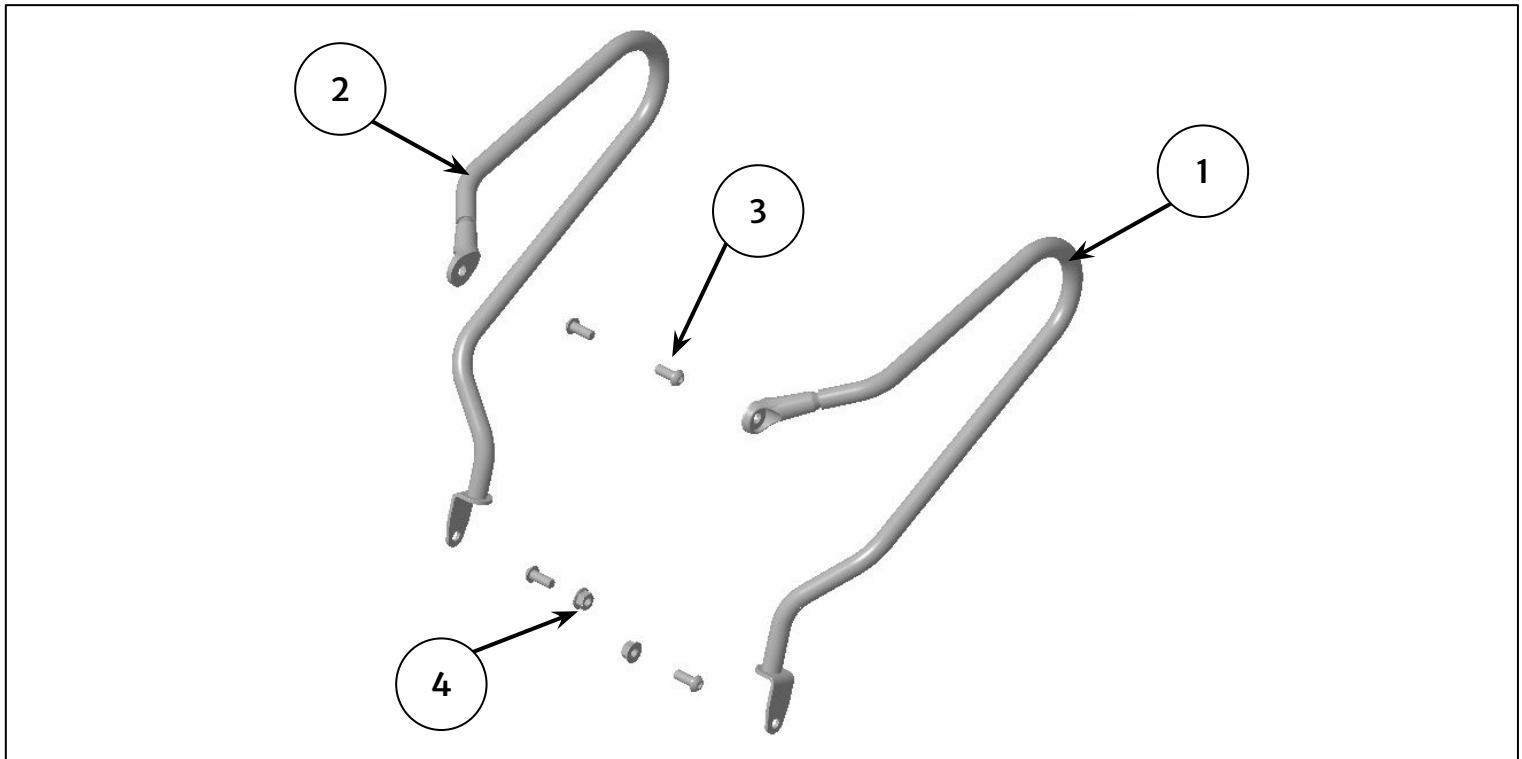

| Item | Description              | Qty |
|------|--------------------------|-----|
| 1    | Pannier rail, left hand  | 1   |
| 2    | Pannier rail, right hand | 1   |
| 3    | Fixing, M8 x 20mm        | 4   |
| 4    | Nut, M8                  | 2   |

**1** Remove the right hand upper RSU mount fixing (1) and washer (2). Discard and replace the fixing if the motorcycle is to be returned to its original condition. Retain the washer for reuse.

 **WARNING:** Do not move the motorcycle after removing the fixing.

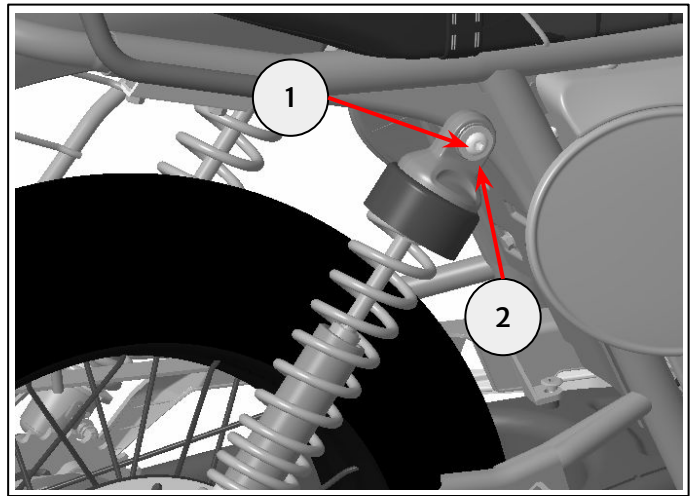
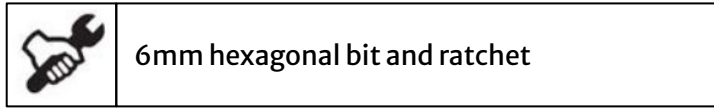

## Fitment without Rear Rack 1990536

**2** Align the right hand pannier rail upper mount (1) and the washer removed in step 1 (2) with the upper RSU mount (3). Fit the M8 x 20mm fixing (4) to secure the pannier rail to the motorcycle frame, as shown.

Do not fully tighten the fixing at this stage.

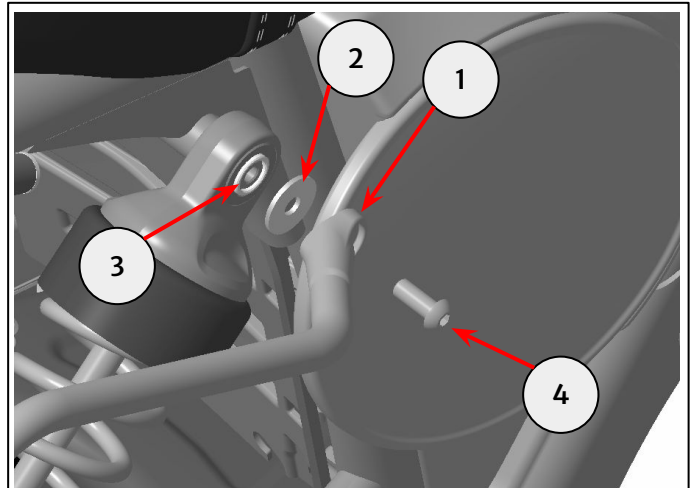
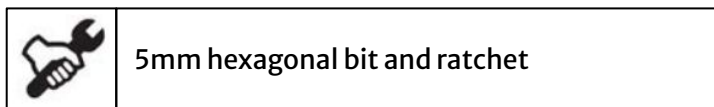

**3** Align the pannier rail lower mount (1) with the silencer mount plate (2). Fit the M8 x 20mm fixing (3) and nut (4) to secure the pannier rail, as shown.

Tighten the upper fixing to **22Nm**. Tighten the lower fixing (3) to **15Nm**.

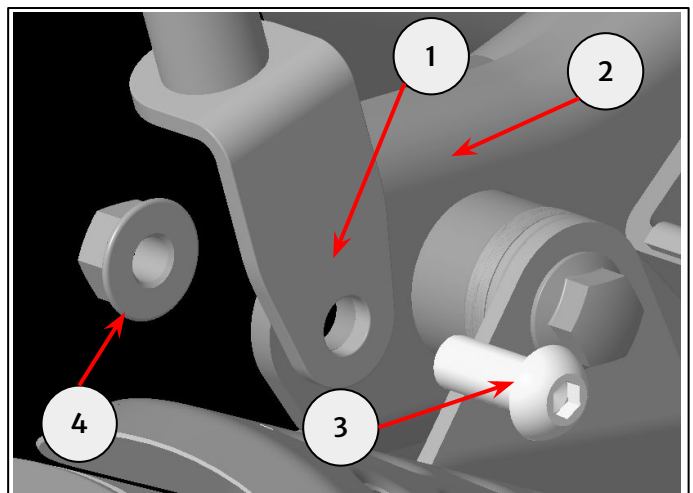
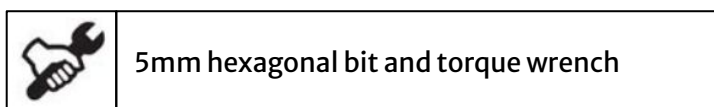

**4** Repeat steps 1 and 2 on the left hand side of the motorcycle for the left hand pannier rail.

### For motorcycles with a saree guard fitted

Remove the fixing (1) and nut from the pillion footrest hanger. Retain for reuse if the motorcycle is to be returned to its original condition.

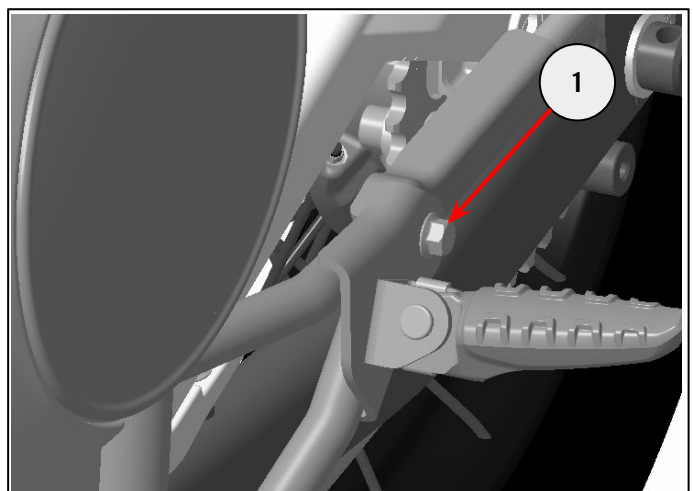
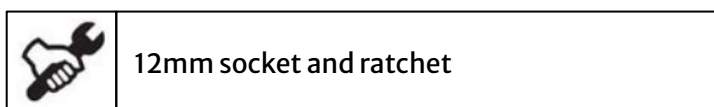

5 Align the pannier rail lower mount (1) with the silencer mount plate (2). Fit the M8 x 20mm fixing (3) and nut (4) to secure the pannier rail and saree guard (where applicable).

Tighten the upper fixing to **22Nm**. Tighten the lower fixing (3) to **15Nm**.



5mm hexagonal bit and torque wrench

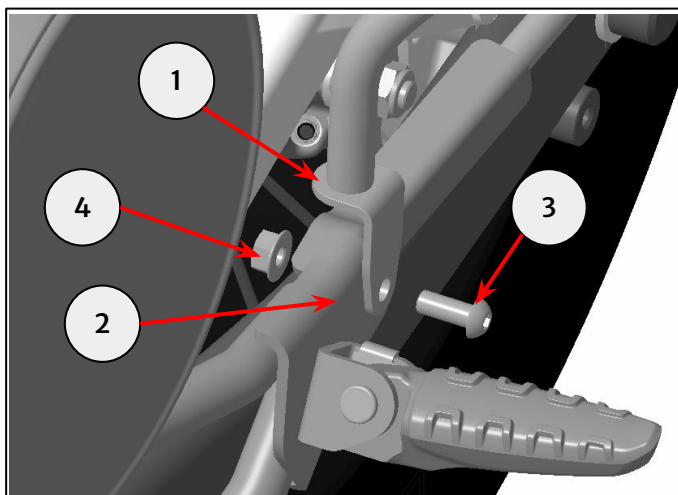

## Fitment with Rear Rack 1990536

**Note:** Rear Rack must be fitted first. See rear rack fitting instructions.

6 Remove the right hand upper RSU mount fixing (1). Discard and replace the fixing if the motorcycle is to be returned to the rear rack only condition.



**WARNING:** Do not move the motorcycle after removing the fixing.



6mm hexagonal bit and ratchet

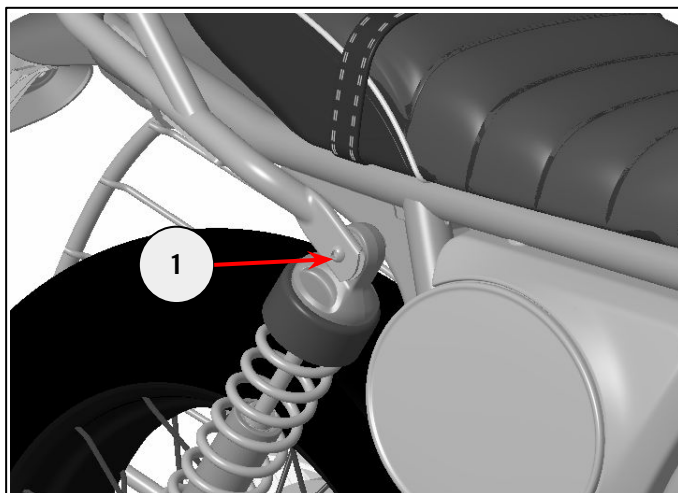

7 Align the pannier rail upper mount (1) with the rear rack (2) and upper RSU mount (3). Fit the M8 x 30mm fixing (4) from the rear rack kit to secure the pannier rail upper mount to the motorcycle frame, as shown.

Do not fully tighten the fixing at this stage.



5mm hexagonal bit and ratchet

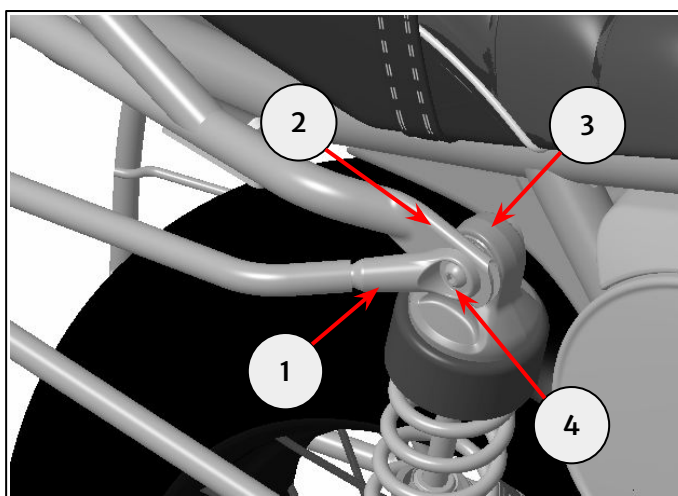

8 Align the pannier rail lower mount (1) with the spacer (2) from the rear rack kit to the bracket on the motorcycle frame (3). Fit the M8 x 30mm fixing (4) from the rear rack kit and M8 nut (5) to secure the pannier rail lower mount, as shown.

Tighten the upper fixing to **22Nm**. Tighten the lower fixing (4) to **15Nm**.



5mm hexagonal bit and torque wrench

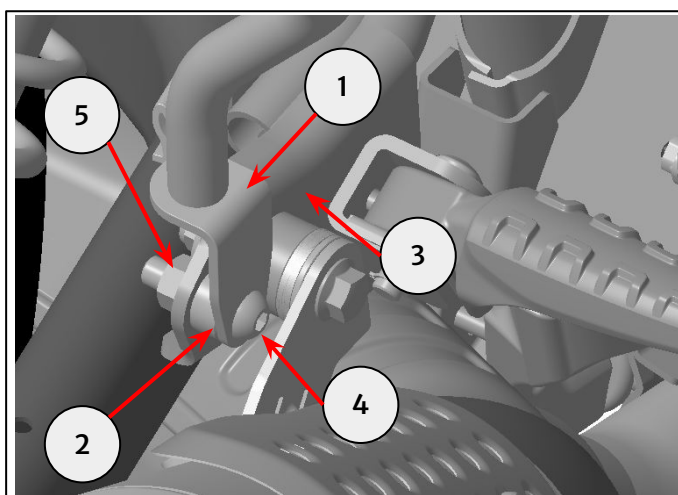

**9** Repeat steps 6 and 7 on the left hand side of the motorcycle for the left hand pannier rail.

**For motorcycles with a saree guard fitted**

Remove the fixing (1) and nut from the pillion footrest hanger. Retain for reuse if the motorcycle is to be returned to its original condition.

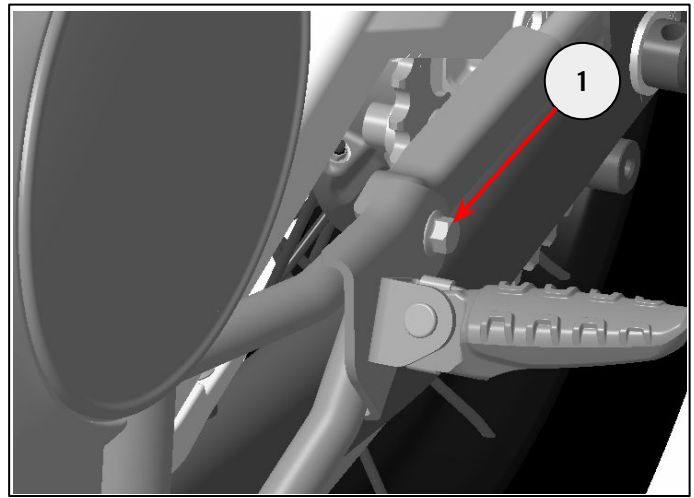

12mm socket and ratchet

**10** Align the pannier rail lower mount (1) with the spacer (2) from the rear rack kit to the bracket on the motorcycle frame (3). Fit the M8 x 30mm fixing (4) from the rear rack kit and M8 nut to secure the pannier rail and saree guard (where applicable).

Tighten the upper fixing to **22Nm**. Tighten the lower fixing (4) to **15Nm**.

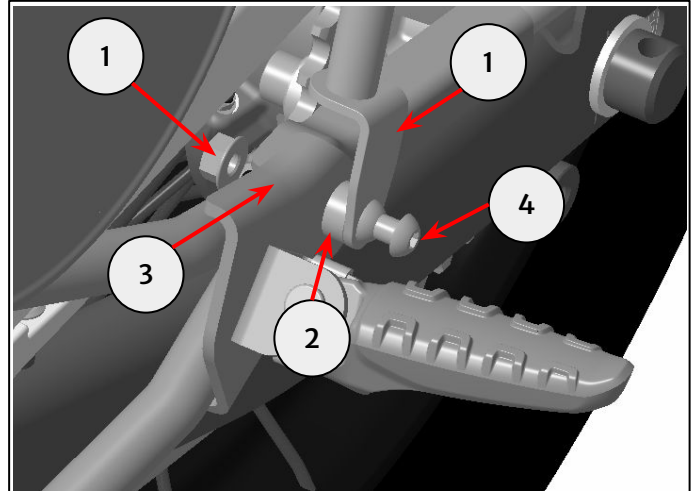

5mm hexagonal bit and torque wrench



**WARNING:** After fitting any genuine Royal Enfield accessory always ride the motorcycle with caution and allow time to become familiar with any change in the motorcycle handling characteristics. Failure to become familiar with any change in the motorcycle handling characteristics may cause the motorcycle to become unstable and result in an accident.