

Part Number:
1990475

Models:
Interceptor (2018 Onwards)
Continental GT (2018 Onwards)
With VIN starting ME3P, ME3C or ME3FP

WARNING: Royal Enfield genuine accessories are designed to fit only the specific Royal Enfield motorcycle(s) that are specified above. They should not be fitted to any other type of motorcycle. Pay particular attention to the warnings and cautions contained in this instruction, failure to do so may result in an incorrect installation of the accessory which could result in an unsafe riding condition and possible accident. If in any doubt always seek help from your authorised Royal Enfield dealer.

WARNING: Before starting any accessory kit installation ensure the motorcycle is supported in a stable condition. Failure to support the motorcycle correctly could lead to motorcycle damage or personal injury.

WARNING: All fixings must be tightened to the torque values specified in this instruction. Failure to tighten fixings to the correct torque could result in an unsafe riding condition and possible accident.

CAUTION: Care should be taken when fitting any accessory kit. Incorrect handling of kit components or the use of incorrect tools could lead to component or motorcycle damage.

NOTE: The content of this instruction is subject to change at any time without notice or liability. Royal Enfield reserves the right to revise the information presented at any time.

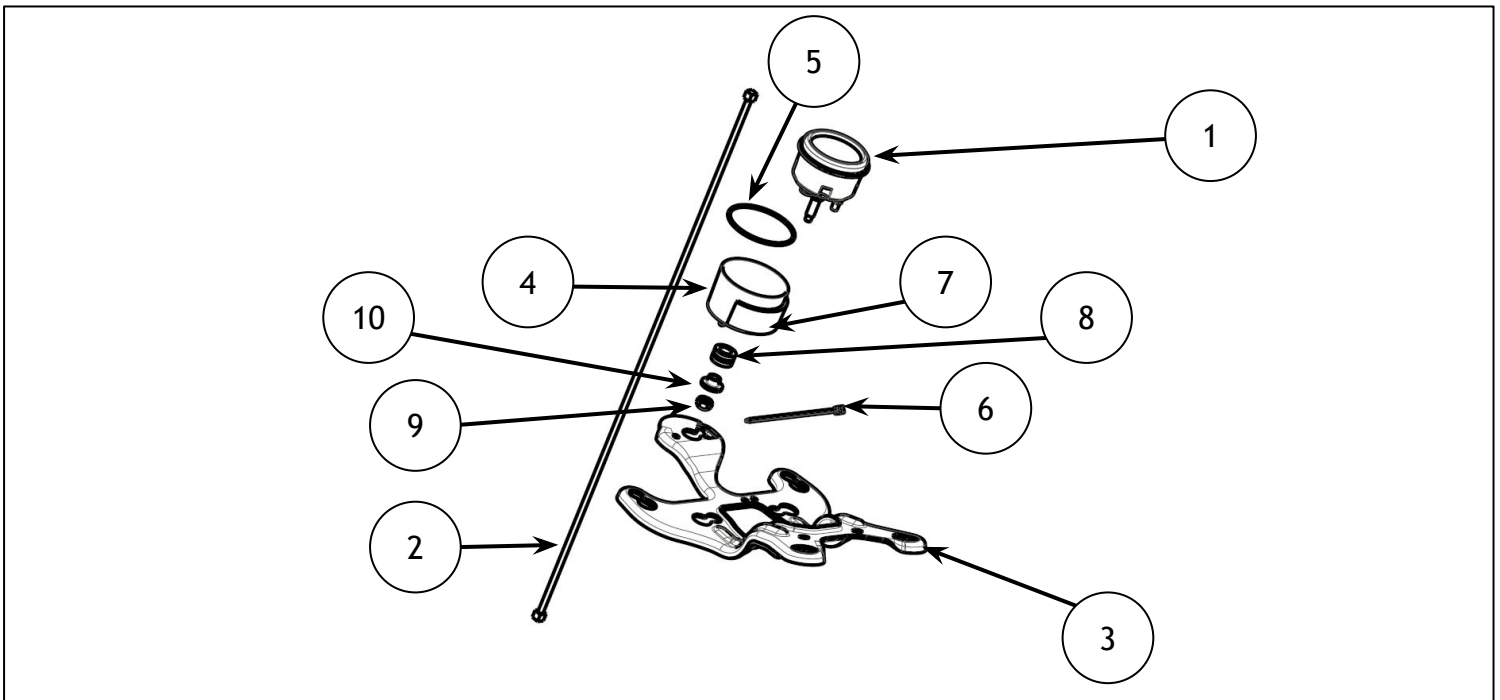

Item	Description	Qty
1	Tripper Unit	1
2	Electrical Cable	1
3	Instrument Mount	1
4	Tripper Mount	1

5	O-Ring	1
6	Cable Tie	1
7	Foam	1
8	Grommet	1
9	Nut (L), M6	1
10	Top Hat, M6	1

All Motorcycles

1 Remove the side cover (1) and seat and disconnect the battery, as described in the Owner's Manual.

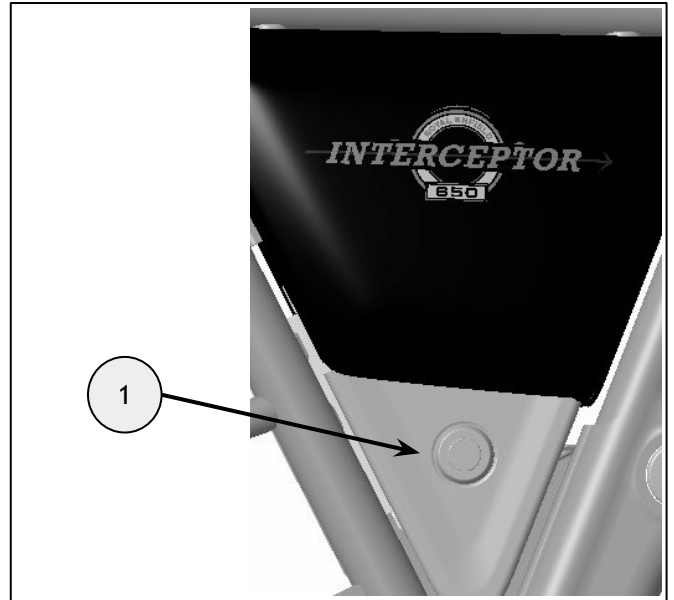

Motorcycles without a Royal Enfield GMA Screen fitted

2 Remove and unplug the headlight (1) as described in the Owner's Manual. Unplug all electrical connectors in the headlight bowl. Unbolt the 2 fixings (2) that attach the headlight bowl to the fork clamps. Retain the fixings for reuse. Remove the headlight bowl (3).

	PH1 screwdriver
--	-----------------

	12mm socket and ratchet
--	-------------------------

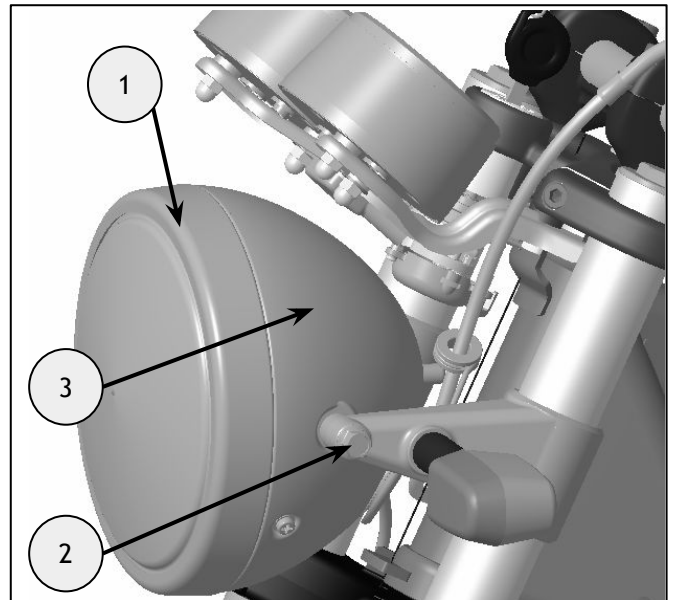

3 Remove the instrument cluster (1), retaining the 4 fixings (2) for reuse. Remove the 2 ignition barrel fixings (3) and 2 top yoke fixings (4), retaining all for reuse. Remove the bracket (5) from the motorcycle.

All models

	10mm socket, 5mm hexagonal bit and ratchet
--	--

Interceptor models

	14mm socket and ratchet
--	-------------------------

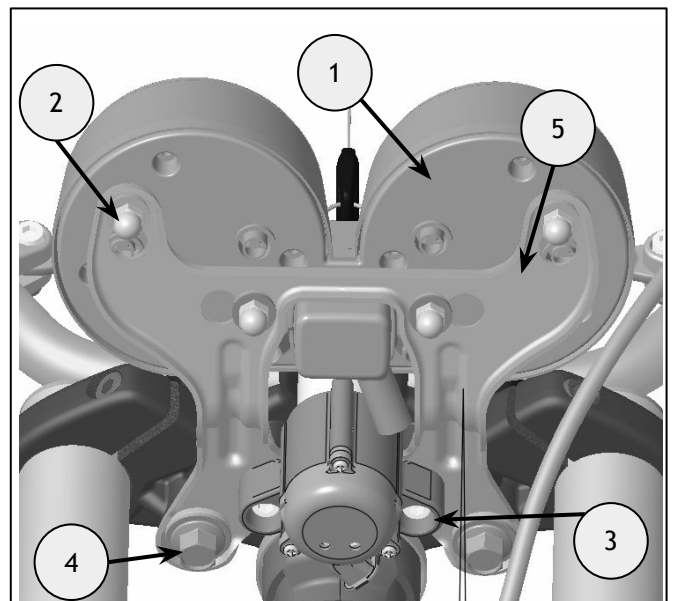

4 Remove the 4 grommets from the original instrument mount and fit them into the instrument mount from the kit (1). Take the rubber grommet from the kit and fit into the new mount where the tripper unit will fit (2).

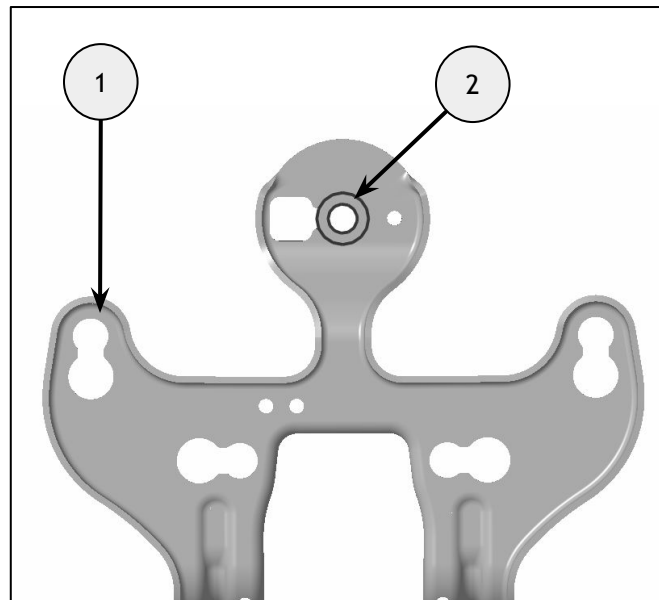

5 Fit the instrument mount from the kit (1) to the top yoke and refit the ignition barrel (2) from step 3. Reuse the top yoke fixings (3) from step 3 and torque to **45Nm** (Interceptor) or **10Nm** (Continental GT) and the ignition barrel fixings (4) from step 3 to **10Nm**.

All models

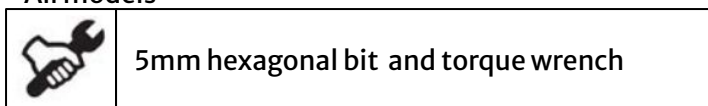

Interceptor models

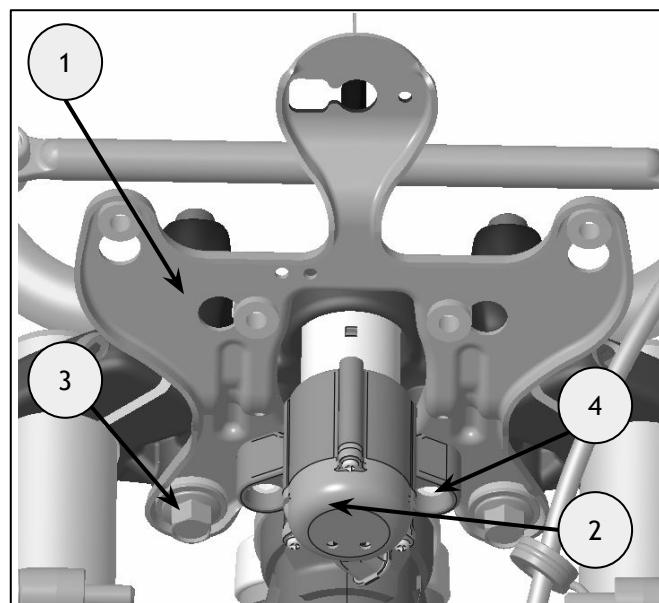
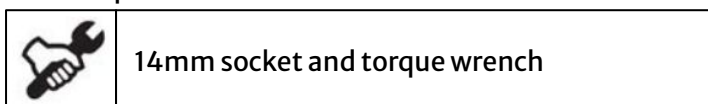

6 Refit the instrument cluster (1) from step 3 to the instrument mount (2). Reuse the fixings (3) from step 3 and torque to **5Nm**.

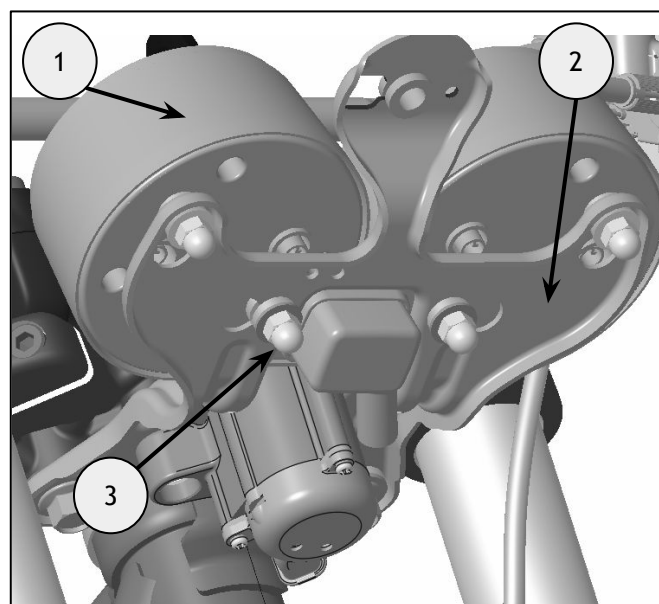
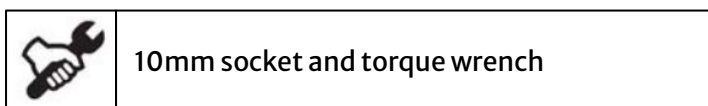

7 Fix the tripper unit (1), O-ring (2) and tripper mount (3) onto the instrument bracket (4). Insert the top hat (5) into the grommet from the bottom side and secure in place with the nut (6). Torque to **5Nm**. Plug the electrical cable (not shown) into the tripper unit.

	<p>10mm socket and torque wrench</p>
---	--------------------------------------

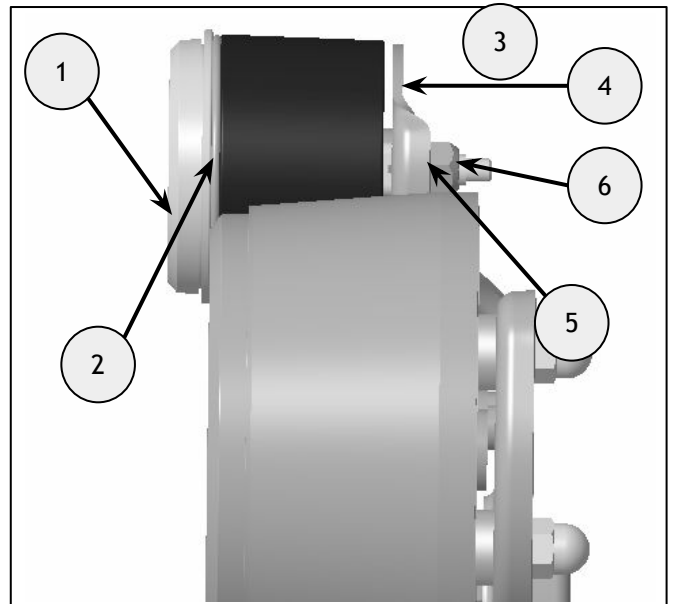

8 Refit the headlight bowl (1) and fixings (2). Do not fully tighten the fixings at this stage. Reconnect all electrical connectors inside the headlight bowl. Thread the tripper electrical cable through the back of the headlight bowl (3) and plug it into the unused yellow accessory connector within the headlight bowl.

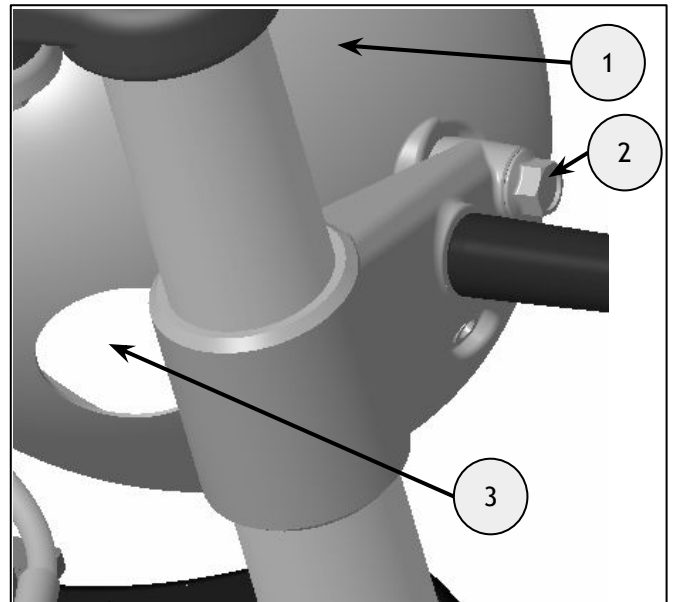

9 Torque the headlight bowl mount fixings to **25Nm** (1), ensuring all wires are not pulled on or kinked. Refit the headlight assembly (2) and tighten the PH1 fixings. Reconnect the battery and reassemble the seat/side cover, as described in the Owner's Manual. The tripper will come on with the engine. Ensure the headlight beam is correctly adjusted as described in the Owner's manual.

	<p>12mm socket and torque wrench</p>
--	--------------------------------------

	<p>PH1 screwdriver</p>
--	------------------------

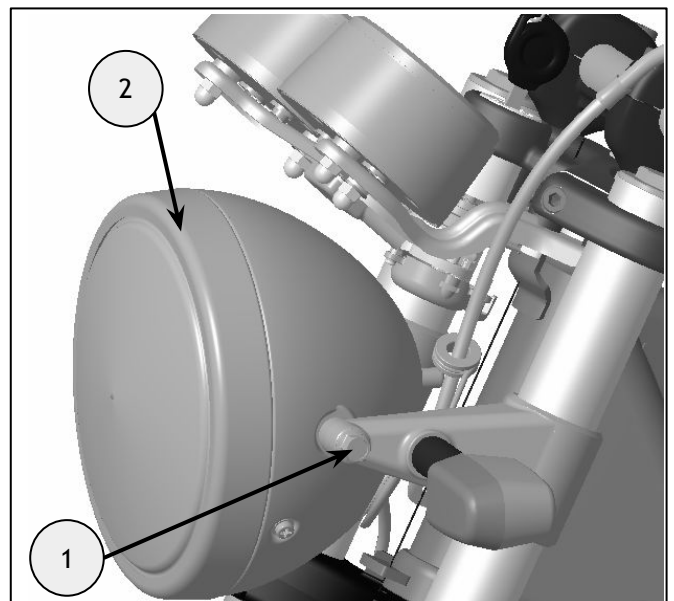

10 Use the cable tie to fix the electrical cable (not shown) onto the mount using the two holes as cable tie loop points (1). Do not pull the cable tie as tight as possible. Tighten until the electrical cable is suitably fixed in place and cut any excess cable tie tail. Check the steering action for free movement.

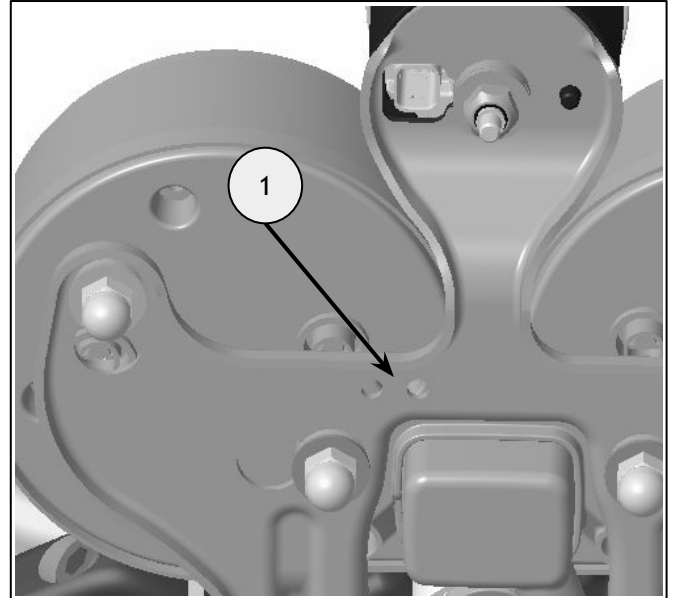

Motorcycles with a Royal Enfield GMA Screen fitted

11 Remove the 4 fixings (1) holding on the screen embellisher and/or screen and remove. Retain fixings for reuse. Complete steps 2 to 10 before continuing to step 12.



3mm hexagonal bit and ratchet

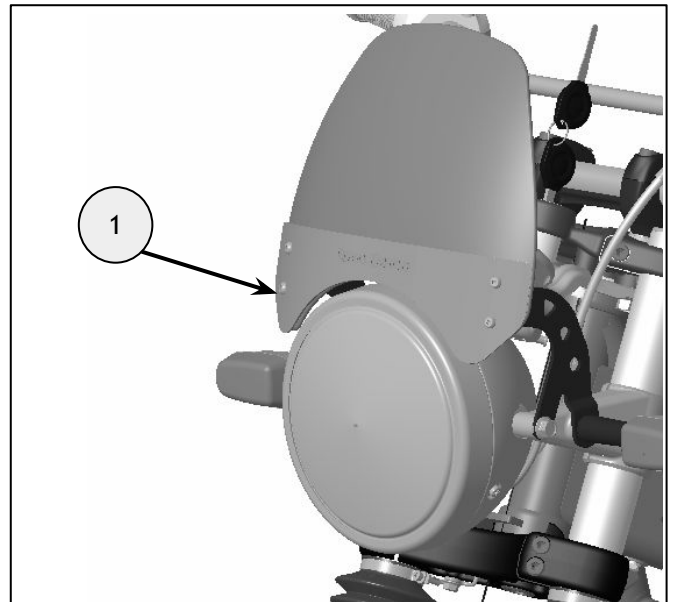

12 Align the screen embellisher and/or screen with the screen mounts and fix in place with the 4 fixings (1). Torque to 2Nm.



3mm hexagonal bit and torque wrench

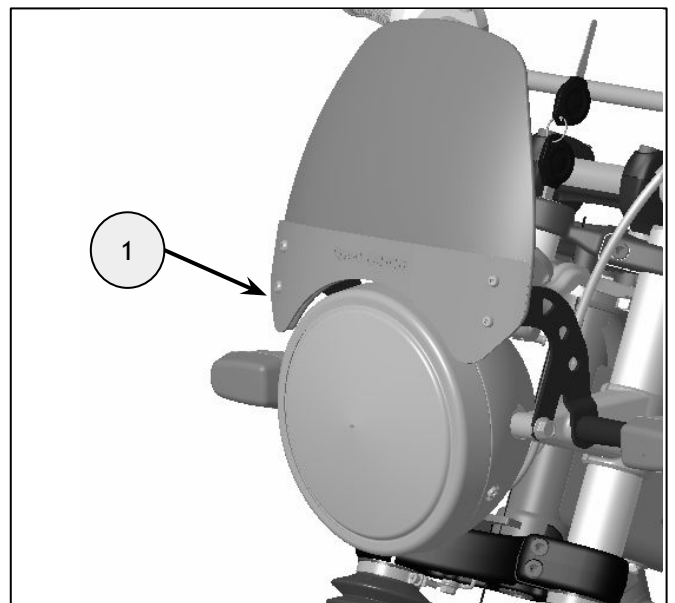

WARNING: After fitting any genuine Royal Enfield accessory always ride the motorcycle with caution and allow time to become familiar with any change in the motorcycle handling characteristics. Failure to become familiar with any change in the motorcycle handling characteristics may cause the motorcycle to become unstable and result in an accident.