





Part Number:  
1990401  
KXA00485

Models:  
Guerrilla 450

- 

**WARNING:** Royal Enfield genuine accessories are designed to fit only the specific Royal Enfield motorcycle(s) that are specified above. They should not be fitted to any other type of motorcycle. Pay particular attention to the warnings and cautions contained in this instruction, failure to do so may result in an incorrect installation of the accessory which could result in an unsafe riding condition and possible accident. If in any doubt always seek help from your authorised Royal Enfield dealer.
- 

**WARNING:** Before starting any accessory kit installation ensure the motorcycle is supported in a stable condition. Failure to support the motorcycle correctly could lead to motorcycle damage or personal injury.
- 

**WARNING:** All fixings must be tightened to the torque values specified in this instruction. Failure to tighten fixings to the correct torque could result in an unsafe riding condition and possible accident
- 

**CAUTION:** Care should be taken when fitting any accessory kit. Incorrect handling of kit components or the use of incorrect tools could lead to component or motorcycle damage.

**NOTE:** The content of this instruction is subject to change at any time without notice or liability. Royal Enfield reserves the right to revise the information presented at any time.

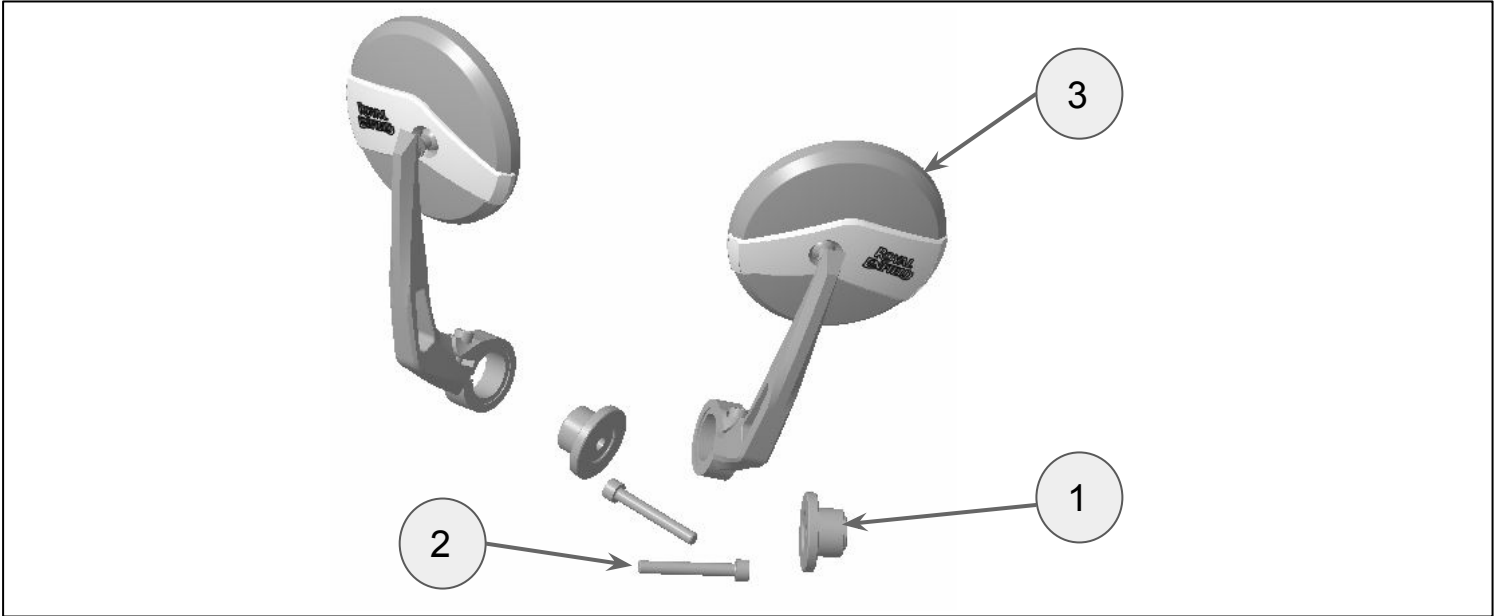

Item	Description	Qty
1	Bar end mirror mount	2
2	Fixing (cap head) M8 x 40mm	2
3	Bar end mirrors	2

**NOTE:** When removing the original mirrors be advised that the mirror on the left hand side of the handlebars has a right hand thread and the mirror on the right hand side of the handlebars has a left hand thread. Ensure the mirror stem is turned in the correct direction when removing the mirrors from the handlebars.

**1** Remove mirrors (1). Retain for reuse if the motorcycle is to be returned to its original condition.



16mm spanner

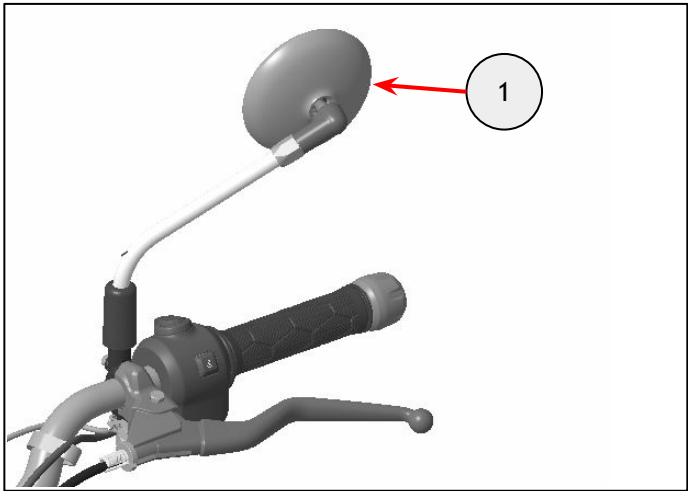

**2** Loosen the fixing (1) in the bar end mirror (2). Fit bar end mount (3) into the bar end mirror with flange (4) positioned on the right of the mirror as per the image. Tighten the fixing (1) but not fully at this stage.



5mm hexagonal bit and ratchet

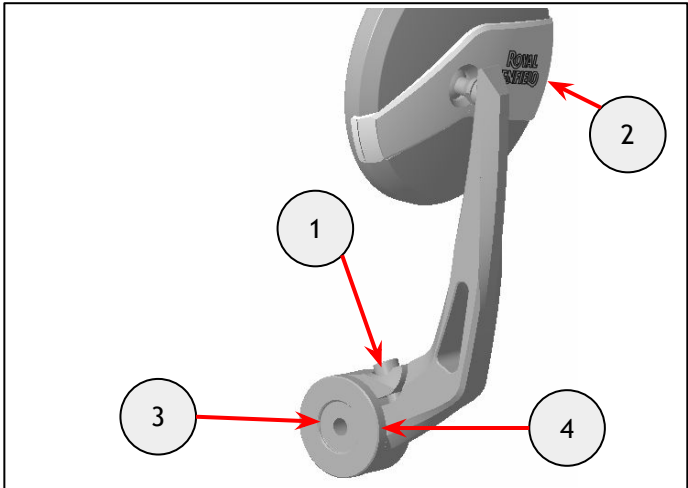

**3** Remove the left hand side fixing (1) and remove the standard bar end finisher (2). Retain the fixing and bar end finisher for reuse.



5mm hexagonal bit and ratchet

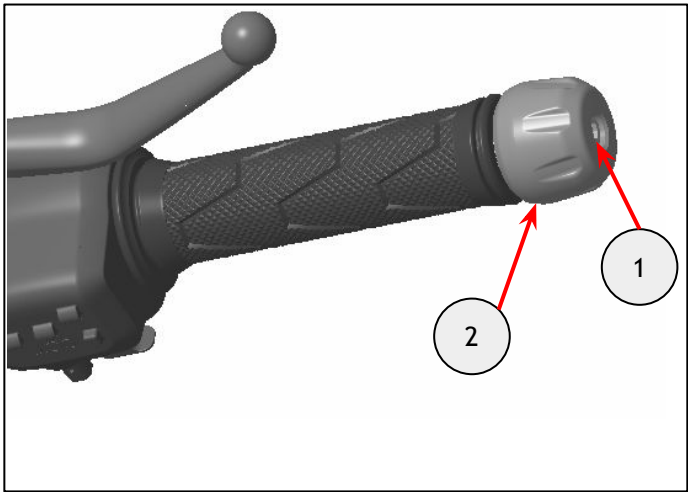

**4** Fit the pre-assembled bar end mirror (1) from step 2 to the handlebar (2), ensuring the flange (3) is on the inside edge. Refit the bar end finisher (3) removed in step 2 using the M8 x 40mm fixing (4). Tighten to **10Nm**.



5mm hexagonal bit and torque wrench

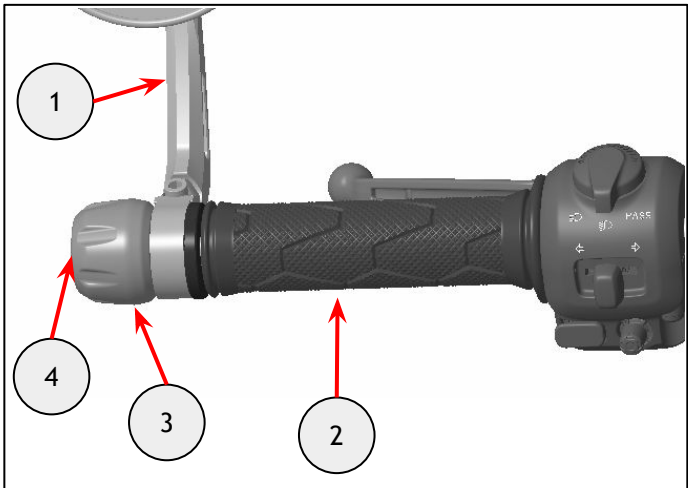

**5** Adjust and set the mirror (1) to a comfortable viewing position. Tighten the fixing (2) to **8Nm**.



5mm hexagonal bit and torque wrench

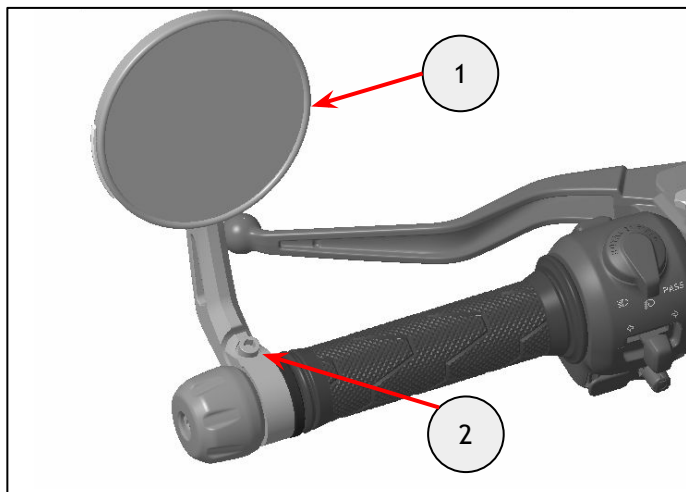

**6** Loosen the fixing (1) in the remaining bar end mirror (2). Fit the bar end mount (3) into the bar end mirror with the flange (3) positioned on the left of the mirror as shown. Tighten the fixing (1) but not fully at this stage.



5mm hexagonal bit and torque wrench

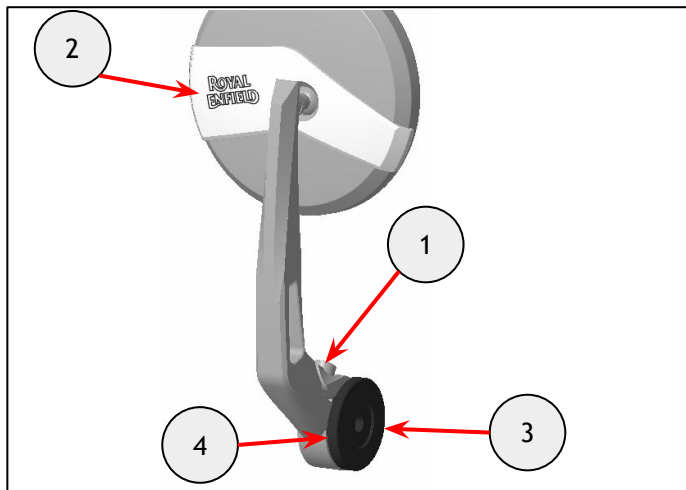

**7** Repeat steps 3 – 5 for the right side of the handlebar.

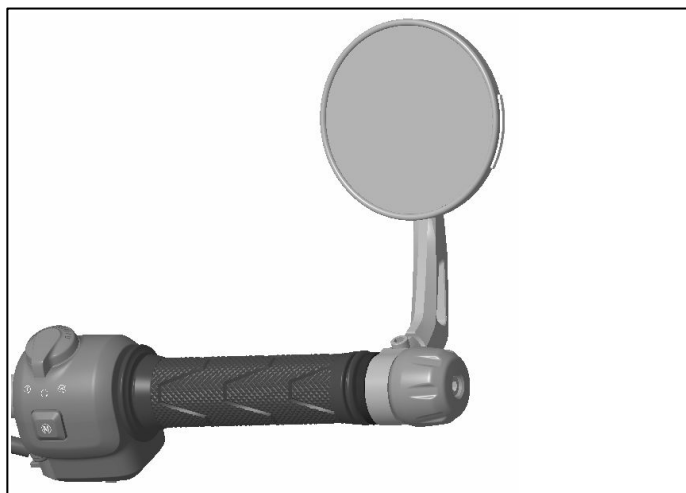

**WARNING:** After fitting any genuine Royal Enfield accessory always ride the motorcycle with caution and allow time to become familiar with any change in the motorcycle handling characteristics. Failure to become familiar with any change in the motorcycle handling characteristics may cause the motorcycle to become unstable and result in an accident.